



# Parkview 2 contour plans

 **AlmondGrove**  
MUNNO PARA



ALLOTMENT 573 in DEV. NO. 292/D066/12/004

in the area named

MUNNO PARA WEST

CT ---/---

**PRELIMINARY**

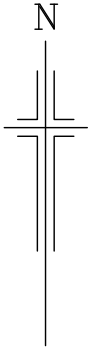

**IMPORTANT**  
SERVICE AND DRIVEWAY LOCATIONS  
ARE APPROXIMATE. ANY CHANGES WILL  
BE AT THE PURCHASERS EXPENSE.  
PURCHASER: \_\_\_\_\_  
PURCHASER: \_\_\_\_\_  
DATE: \_\_\_\_\_

**DISCLAIMER:**

Please note that this site plan is intended for  
visual purposes only, additional survey work will  
be required prior to commencing any design or  
construction on the site.

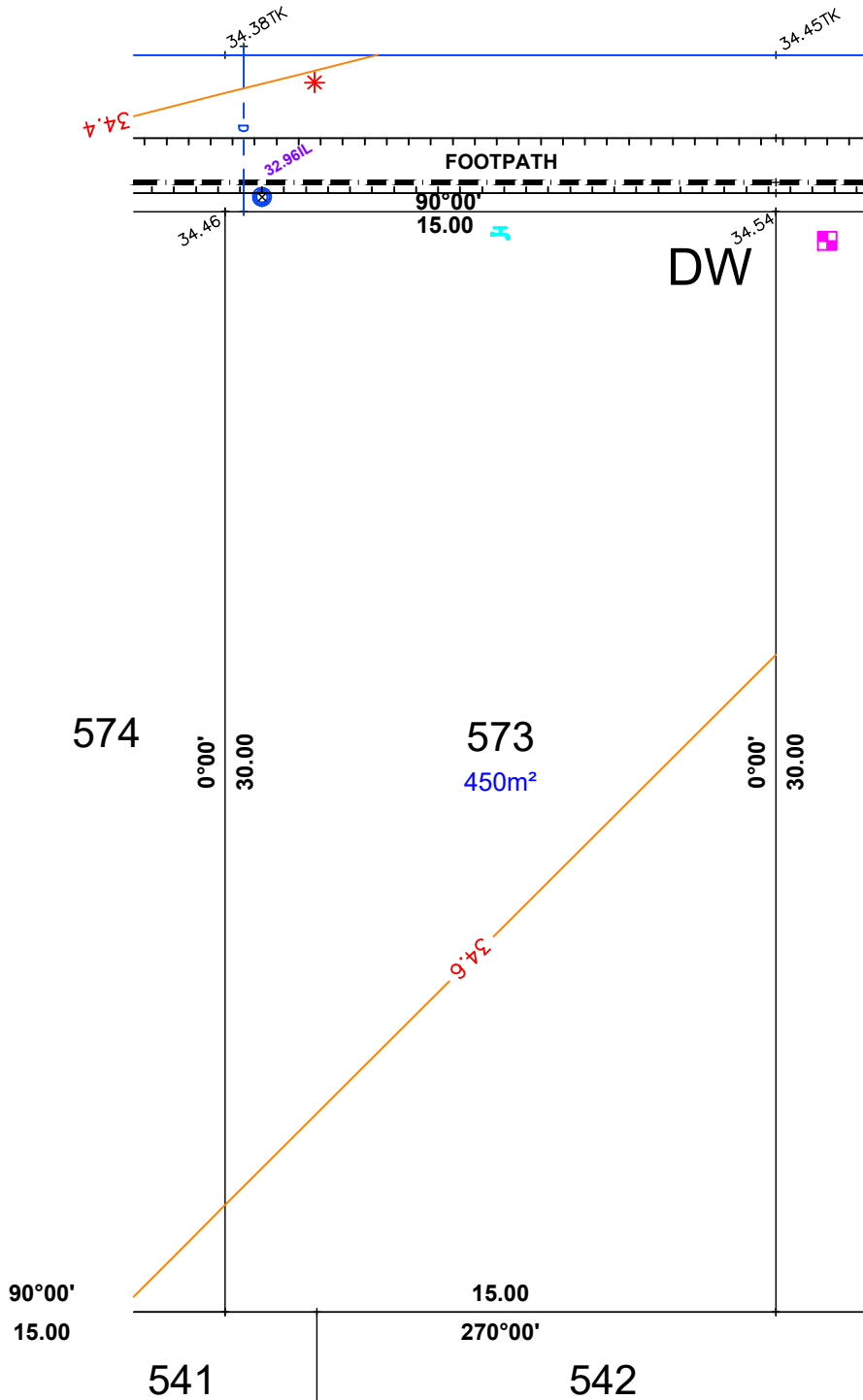

**LEGEND**

- WATER METER
- SIP SEWER IP
- STOBIE POLE
- TELSTRA PIT
- SW GRATING
- SEWER MAN HOLE
- SW MANHOLE
- LIGHT POLE
- ETSA CONNECTION
- TAP
- BOLLARD
- SIGN
- S/W CONNECTION
- FOOTPATH
- SIDE ENTRY PIT
- COMMON SERVICE TRENCH
- DOMESTIC
- SEWER IO

NOTE: DATA SHOWN HEREON IS DESIGN INFORMATION  
AND SHOULD BE CONFIRMED.



1:200

ALEXANDER SYMONDS  
PH 8130 1666

ALLOTMENT 574 in DEV. NO. 292/D066/12/004

in the area named

MUNNO PARA WEST

CT ---/----

**PRELIMINARY**

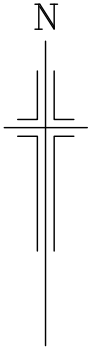

**IMPORTANT**  
SERVICE AND DRIVEWAY LOCATIONS  
ARE APPROXIMATE. ANY CHANGES WILL  
BE AT THE PURCHASERS EXPENSE.  
PURCHASER: \_\_\_\_\_  
PURCHASER: \_\_\_\_\_  
DATE: \_\_\_\_\_

**DISCLAIMER:**

Please note that this site plan is intended for  
visual purposes only, additional survey work will  
be required prior to commencing any design or  
construction on the site.

**KEANE AVENUE**

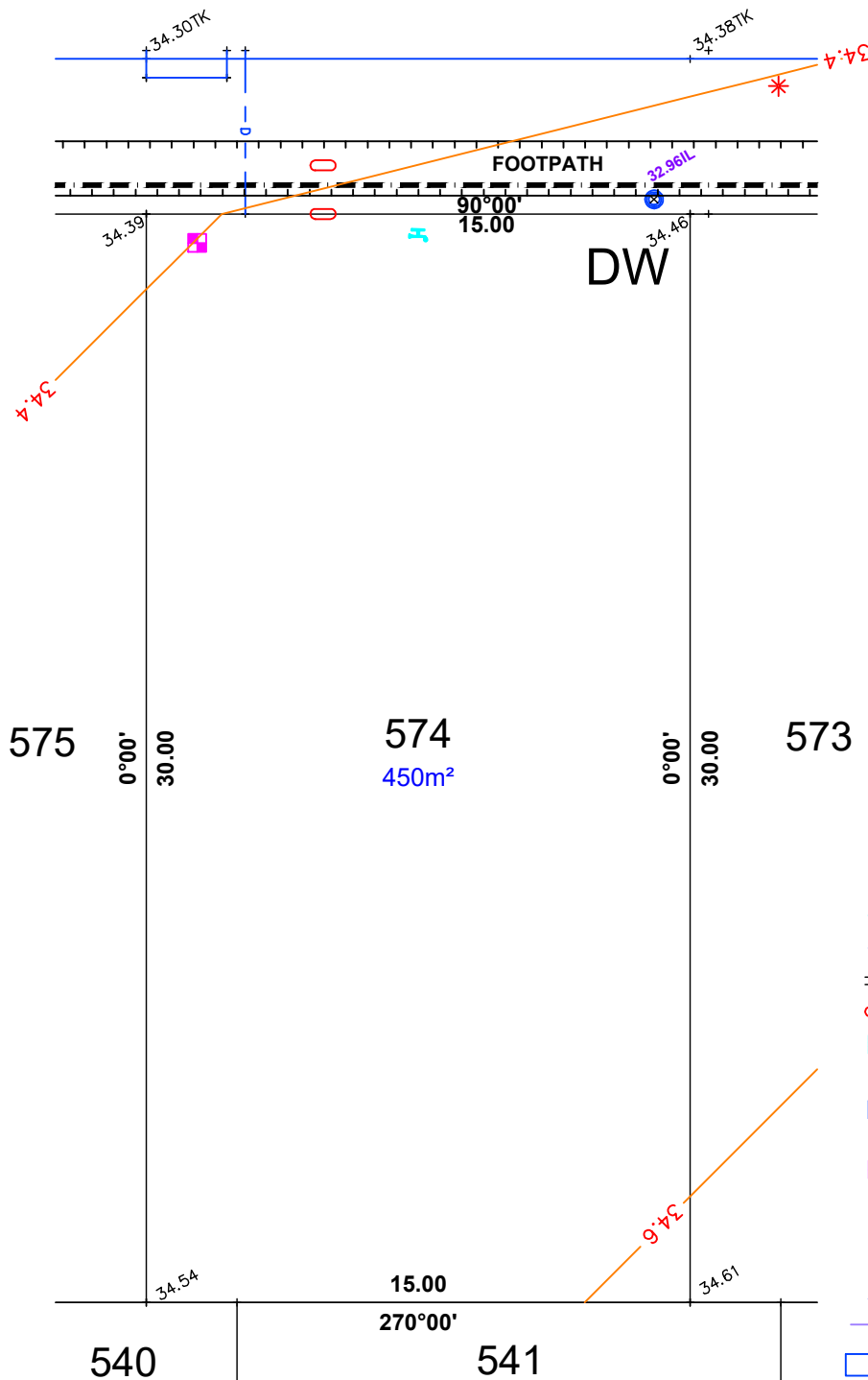

**LEGEND**

- WATER METER
- SIP SEWER IP
- STOBIE POLE
- TELSTRA PIT
- SW GRATING
- SEWER MAN HOLE
- SW MANHOLE
- LIGHT POLE
- ETSA CONNECTION
- TAP
- BOLLARD
- SIGN
- SW CONNECTION
- FOOTPATH
- SIDE ENTRY PIT
- COMMON SERVICE TRENCH
- DOMESTIC
- SEWER IO

NOTE: DATA SHOWN HEREON IS DESIGN INFORMATION  
AND SHOULD BE CONFIRMED.



1:200

ALEXANDER SYMONDS  
PH 8130 1666

ALLOTMENT 575 in DEV. NO. 292/D066/12/004

in the area named  
**MUNNO PARA WEST**

CT ---/----

**PRELIMINARY**

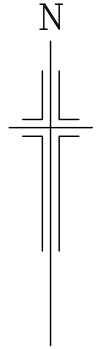

**IMPORTANT**  
SERVICE AND DRIVEWAY LOCATIONS  
ARE APPROXIMATE. ANY CHANGES WILL  
BE AT THE PURCHASERS EXPENSE.  
PURCHASER: \_\_\_\_\_  
PURCHASER: \_\_\_\_\_  
DATE: \_\_\_\_\_

**DISCLAIMER:**

Please note that this site plan is intended for  
visual purposes only, additional survey work will  
be required prior to commencing any design or  
construction on the site.

**KEANE AVENUE**

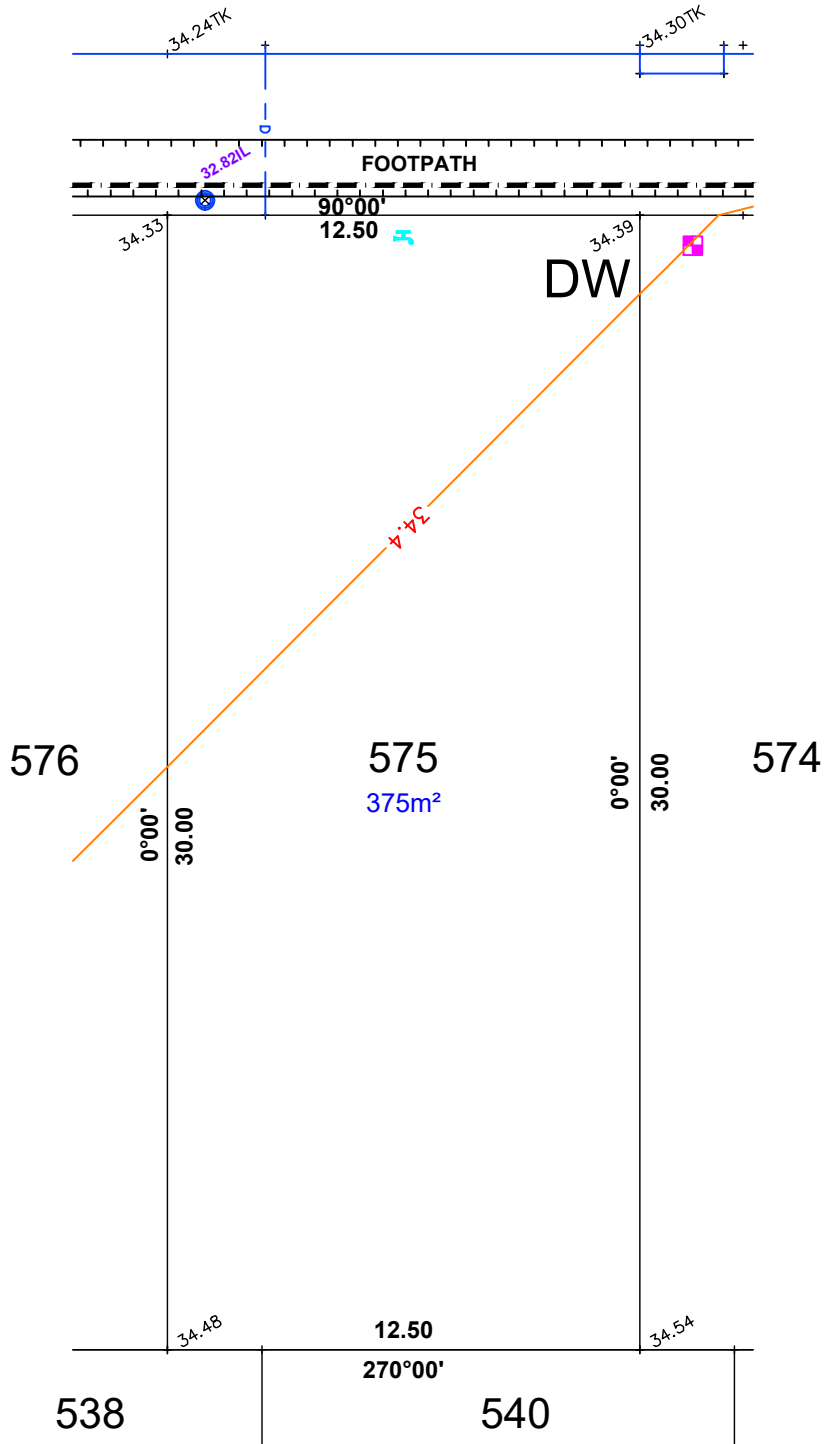

**LEGEND**

- SEWER IP
- STOBIE POLE
- TELSTRA PIT
- S/W GRATING
- SEWER MAN HOLE
- S/W MANHOLE
- LIGHT POLE
- E.T.S.A CONNECTION
- TAP
- BOLLARD
- SIGN
- S/W CONNECTION
- FOOTPATH
- SIDE ENTRY PIT
- COMMON SERVICE TRENCH
- DOMESTIC
- SEWER IO
- POTABLE WATER CONN
- NON-POTABLE WATER CONN
- 29.00TRW TOP RETAINING WALL

NOTE: DATA SHOWN HEREON IS DESIGN INFORMATION  
AND SHOULD BE CONFIRMED.



1:200

ALEXANDER SYMONDS  
PH 8130 1666

ORIGINAL SHEET SIZE A4

ALLOTMENT 576 in DEV. NO. 292/D066/12/004

in the area named  
**MUNNO PARA WEST**

CT ---/----

**PRELIMINARY**

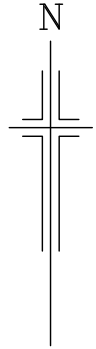

**IMPORTANT**  
SERVICE AND DRIVEWAY LOCATIONS  
ARE APPROXIMATE. ANY CHANGES WILL  
BE AT THE PURCHASERS EXPENSE.  
PURCHASER: \_\_\_\_\_  
PURCHASER: \_\_\_\_\_  
DATE: \_\_\_\_\_

**DISCLAIMER:**

Please note that this site plan is intended for  
visual purposes only, additional survey work will  
be required prior to commencing any design or  
construction on the site.

**KEANE AVENUE**

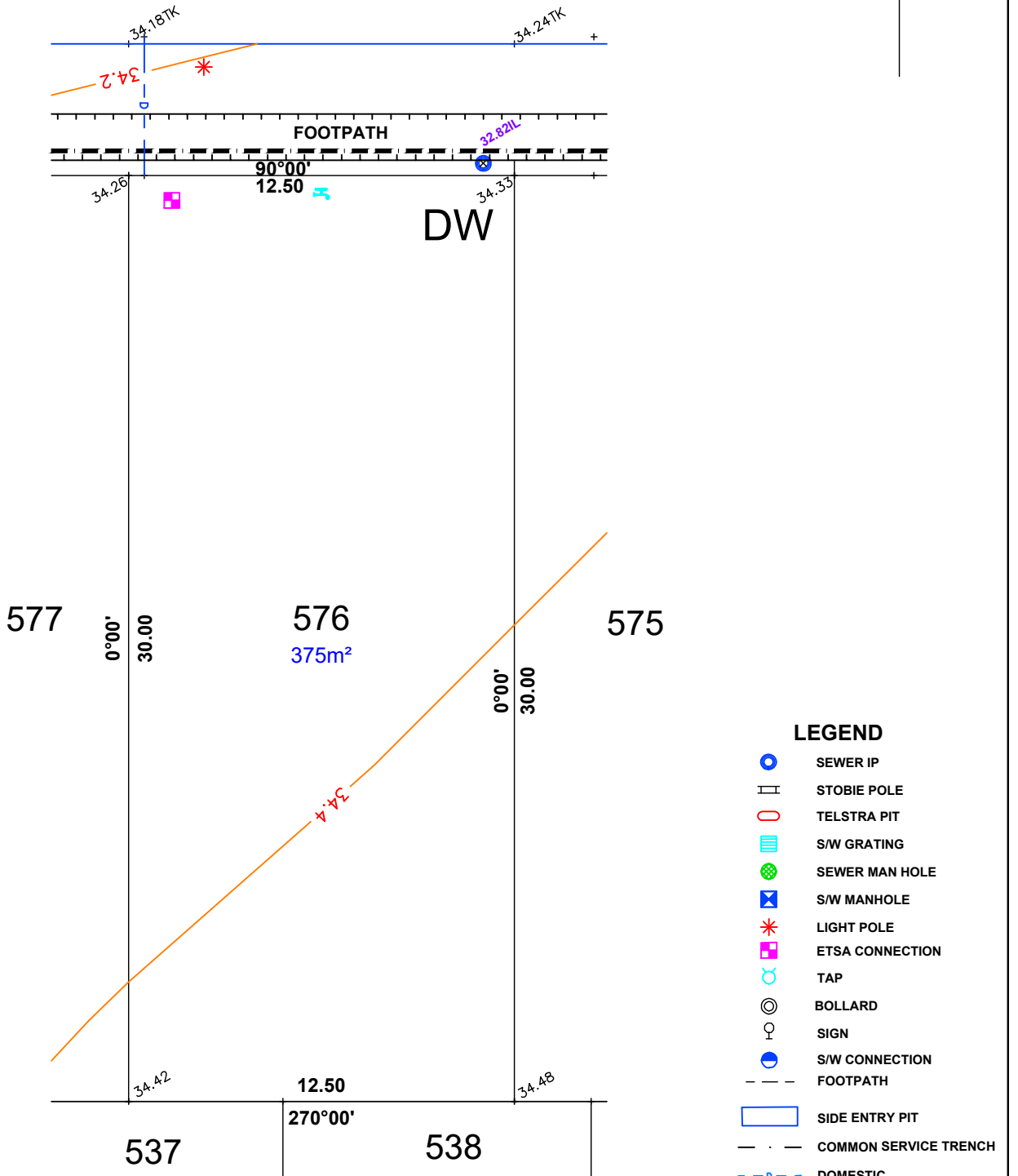

**LEGEND**

- SEWER IP
- STOBIE POLE
- TELSTRA PIT
- S/W GRATING
- SEWER MAN HOLE
- S/W MANHOLE
- LIGHT POLE
- ETSA CONNECTION
- TAP
- BOLLARD
- SIGN
- S/W CONNECTION
- FOOTPATH
- SIDE ENTRY PIT
- COMMON SERVICE TRENCH
- DOMESTIC
- SEWER IO
- POTABLE WATER CONN
- NON-POTABLE WATER CONN
- 29.00TRW TOP RETAINING WALL

NOTE: DATA SHOWN HEREON IS DESIGN INFORMATION  
AND SHOULD BE CONFIRMED.



1:200

ALEXANDER SYMONDS  
PH 8130 1666

ORIGINAL SHEET SIZE A4

**PRELIMINARY**

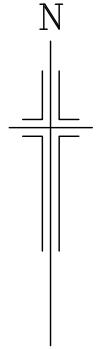

**IMPORTANT**  
SERVICE AND DRIVEWAY LOCATIONS  
ARE APPROXIMATE. ANY CHANGES WILL  
BE AT THE PURCHASERS EXPENSE.  
PURCHASER: \_\_\_\_\_  
PURCHASER: \_\_\_\_\_  
DATE: \_\_\_\_\_

**DISCLAIMER:**

Please note that this site plan is intended for  
visual purposes only, additional survey work will  
be required prior to commencing any design or  
construction on the site.

**KEANE AVENUE**

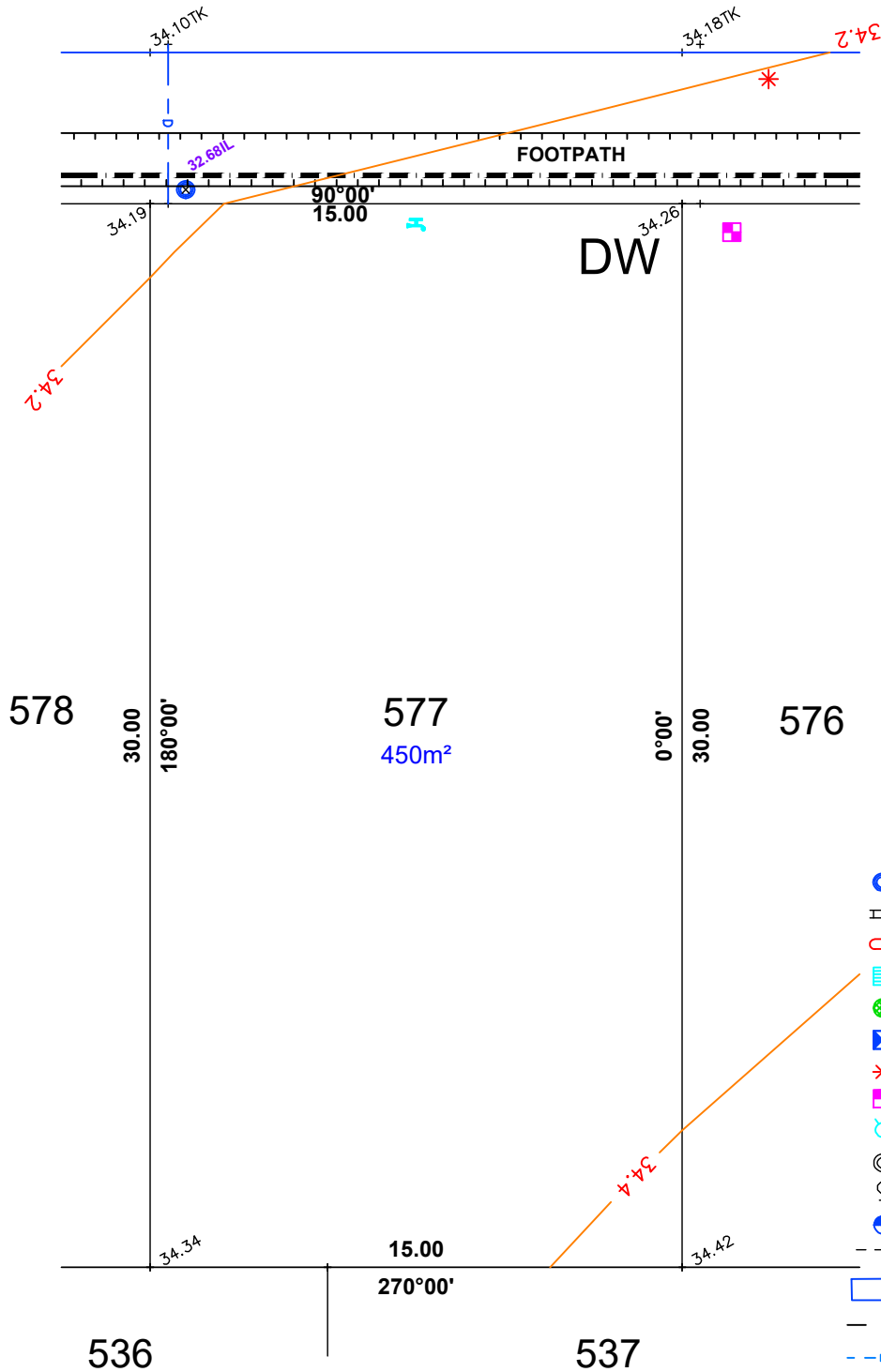

**LEGEND**

- SEWER IP
- STOBIE POLE
- TELSTRA PIT
- S/W GRATING
- SEWER MAN HOLE
- S/W MANHOLE
- LIGHT POLE
- E.T.S.A CONNECTION
- TAP
- BOLLARD
- SIGN
- S/W CONNECTION
- FOOTPATH
- SIDE ENTRY PIT
- COMMON SERVICE TRENCH
- DOMESTIC
- SEWER IO
- POTABLE WATER CONN
- NON-POTABLE WATER CONN
- 29.00TRW TOP RETAINING WALL

NOTE: DATA SHOWN HEREON IS DESIGN INFORMATION  
AND SHOULD BE CONFIRMED.



ALEXANDER SYMONDS  
PH 8130 1666

1:200

ORIGINAL SHEET SIZE A4

ALLOTMENT 578 in DEV. NO. 292/D066/12/004

in the area named  
**MUNNO PARA WEST**

CT ---/----

**PRELIMINARY**

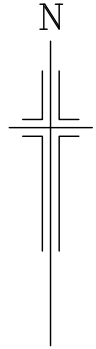

**IMPORTANT**  
SERVICE AND DRIVEWAY LOCATIONS  
ARE APPROXIMATE. ANY CHANGES WILL  
BE AT THE PURCHASERS EXPENSE.  
PURCHASER: \_\_\_\_\_  
PURCHASER: \_\_\_\_\_  
DATE: \_\_\_\_\_

**DISCLAIMER:**

Please note that this site plan is intended for  
visual purposes only, additional survey work will  
be required prior to commencing any design or  
construction on the site.

**KEANE AVENUE**

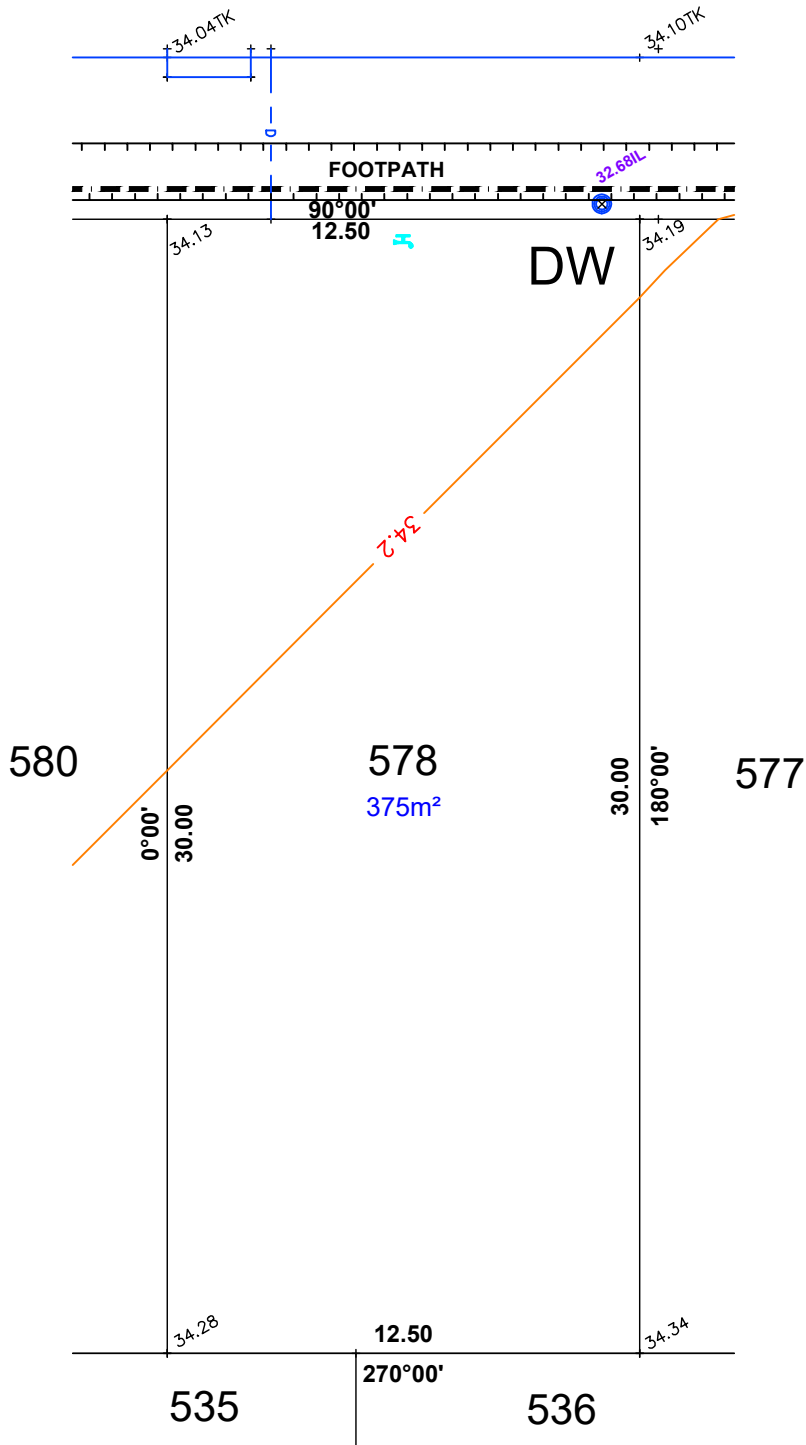

**LEGEND**

- SEWER IP
- STOBIE POLE
- TELSTRA PIT
- S/W GRATING
- SEWER MAN HOLE
- S/W MANHOLE
- LIGHT POLE
- E.T.S.A CONNECTION
- TAP
- BOLLARD
- SIGN
- S/W CONNECTION
- FOOTPATH
- SIDE ENTRY PIT
- COMMON SERVICE TRENCH
- DOMESTIC
- SEWER IO
- POTABLE WATER CONN
- NON-POTABLE WATER CONN
- 29.00TRW TOP RETAINING WALL

NOTE: DATA SHOWN HEREON IS DESIGN INFORMATION  
AND SHOULD BE CONFIRMED.



1:200

ALEXANDER SYMONDS  
PH 8130 1666

ORIGINAL SHEET SIZE A4

ALLOTMENT 580 in DEV. NO. 292/D066/12/004

in the area named  
**MUNNO PARA WEST**

CT ---/----

**PRELIMINARY**

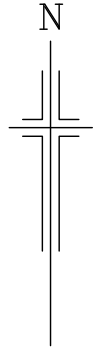

**IMPORTANT**  
SERVICE AND DRIVEWAY LOCATIONS  
ARE APPROXIMATE. ANY CHANGES WILL  
BE AT THE PURCHASERS EXPENSE.  
PURCHASER: \_\_\_\_\_  
PURCHASER: \_\_\_\_\_  
DATE: \_\_\_\_\_

**DISCLAIMER:**

Please note that this site plan is intended for  
visual purposes only, additional survey work will  
be required prior to commencing any design or  
construction on the site.

**KEANE AVENUE**

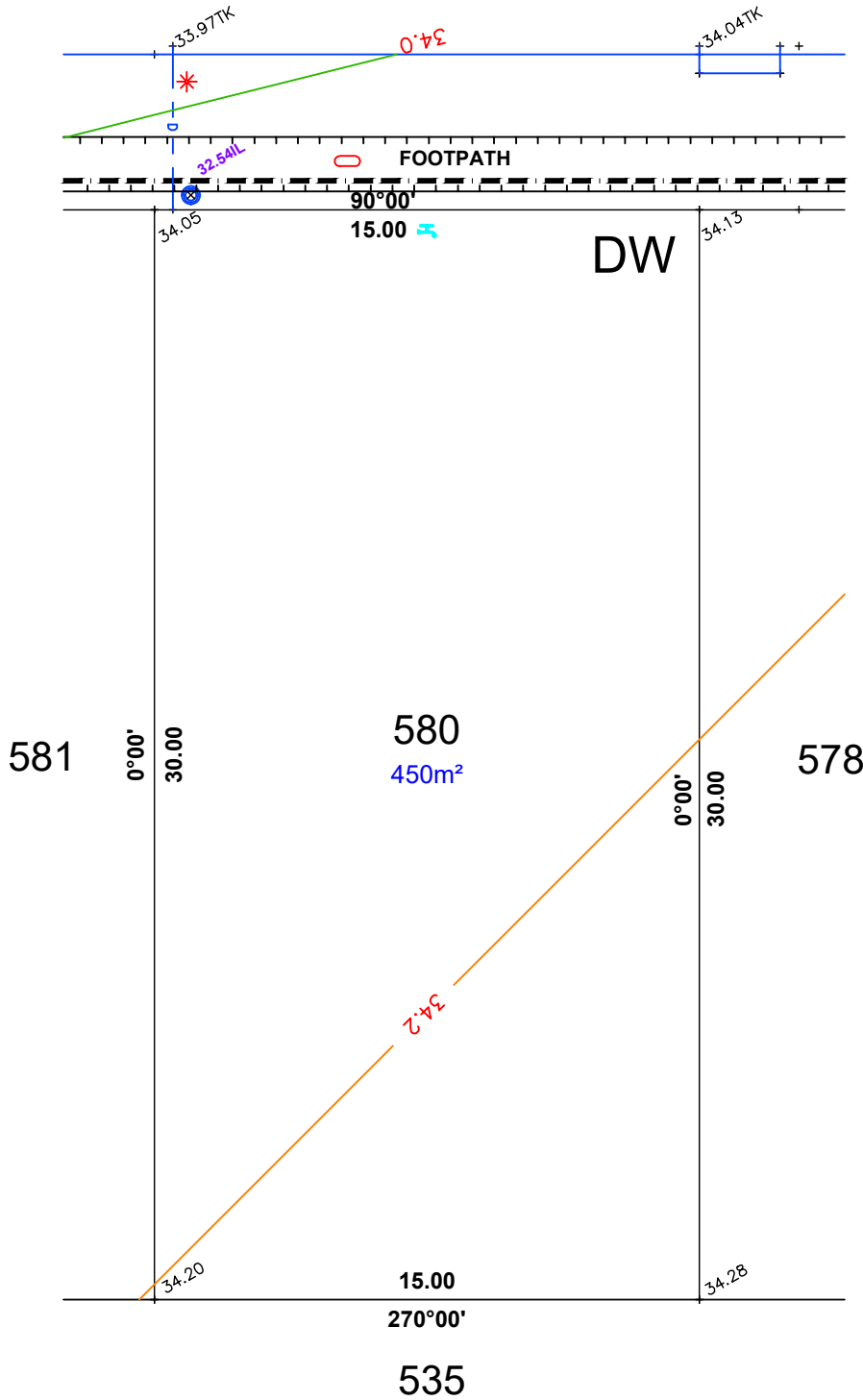

**LEGEND**

- SEWER IP
- STOBIE POLE
- TELSTRA PIT
- S/W GRATING
- SEWER MAN HOLE
- S/W MANHOLE
- LIGHT POLE
- ETSA CONNECTION
- TAP
- BOLLARD
- SIGN
- S/W CONNECTION
- FOOTPATH
- SIDE ENTRY PIT
- COMMON SERVICE TRENCH
- DOMESTIC
- SEWER IO
- POTABLE WATER CONN
- NON-POTABLE WATER CONN
- TOP RETAINING WALL

NOTE: DATA SHOWN HEREON IS DESIGN INFORMATION  
AND SHOULD BE CONFIRMED.



ALEXANDER SYMONDS  
PH 8130 1666

1:200

ORIGINAL SHEET SIZE A4



ALLOTMENT 581 in DEV. NO. 292/D066/12/004

in the area named  
**MUNNO PARA WEST**

CT ---/----

**PRELIMINARY**

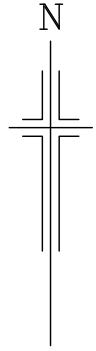

**IMPORTANT**  
SERVICE AND DRIVEWAY LOCATIONS  
ARE APPROXIMATE. ANY CHANGES WILL  
BE AT THE PURCHASERS EXPENSE.  
PURCHASER: \_\_\_\_\_  
PURCHASER: \_\_\_\_\_  
DATE: \_\_\_\_\_

**DISCLAIMER:**

Please note that this site plan is intended for  
visual purposes only, additional survey work will  
be required prior to commencing any design or  
construction on the site.

**KEANE AVENUE**

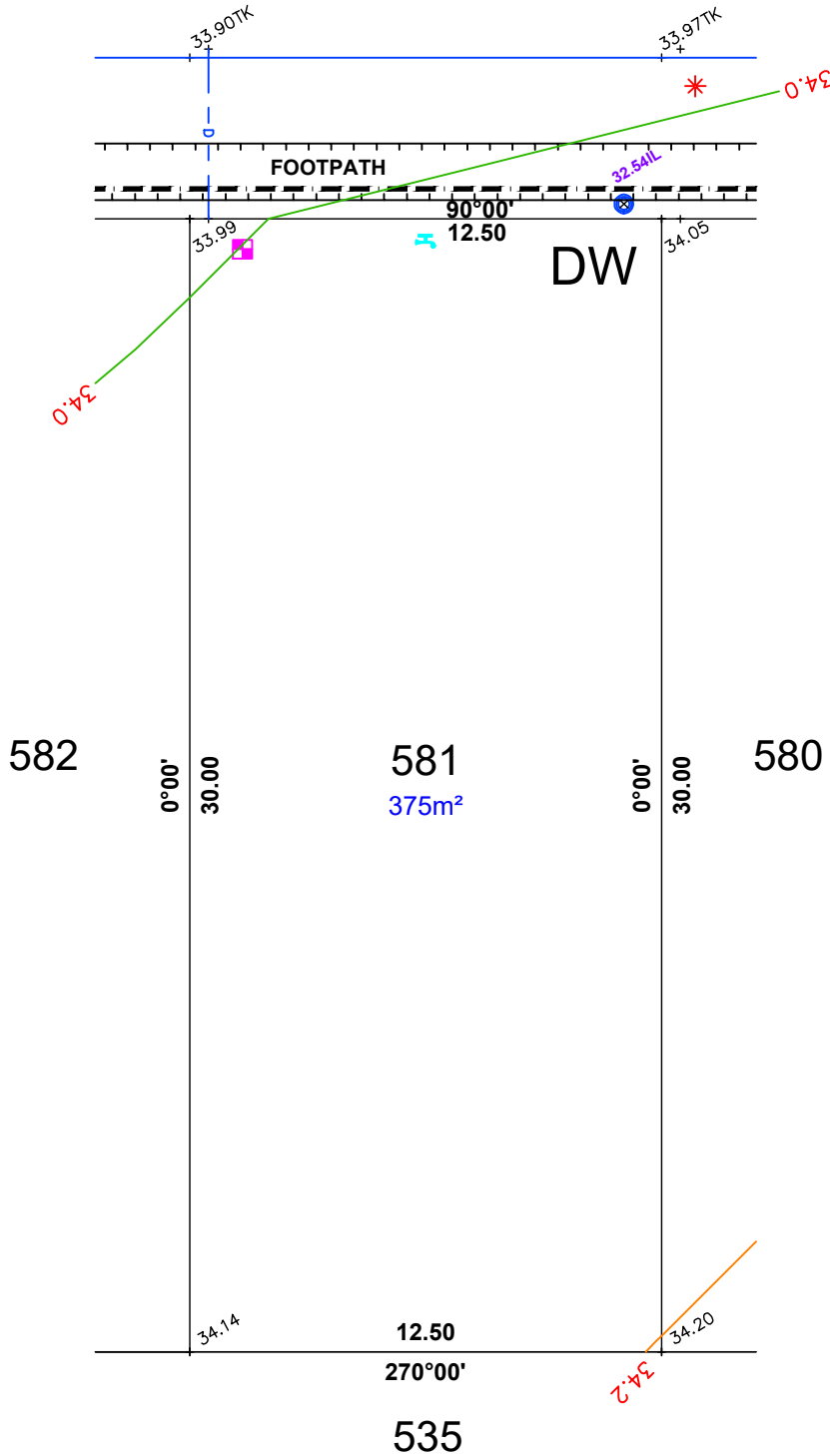

**LEGEND**

- SEWER IP
- STOBIE POLE
- TELSTRA PIT
- S/W GRATING
- SEWER MAN HOLE
- S/W MANHOLE
- LIGHT POLE
- ETSA CONNECTION
- TAP
- BOLLARD
- SIGN
- S/W CONNECTION
- FOOTPATH
- SIDE ENTRY PIT
- COMMON SERVICE TRENCH
- DOMESTIC
- SEWER IO
- POTABLE WATER CONN
- NON-POTABLE WATER CONN
- TOP RETAINING WALL

NOTE: DATA SHOWN HEREON IS DESIGN INFORMATION  
AND SHOULD BE CONFIRMED.



ALEXANDER SYMONDS  
PH 8130 1666

1:200

ORIGINAL SHEET SIZE A4

ALLOTMENT 582 in DEV. NO. 292/D066/12/004

in the area named  
**MUNNO PARA WEST**

CT ---/----

**PRELIMINARY**

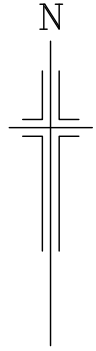

**IMPORTANT**  
SERVICE AND DRIVEWAY LOCATIONS  
ARE APPROXIMATE. ANY CHANGES WILL  
BE AT THE PURCHASERS EXPENSE.  
PURCHASER: \_\_\_\_\_  
PURCHASER: \_\_\_\_\_  
DATE: \_\_\_\_\_

**DISCLAIMER:**

Please note that this site plan is intended for  
visual purposes only, additional survey work will  
be required prior to commencing any design or  
construction on the site.

**KEANE AVENUE**

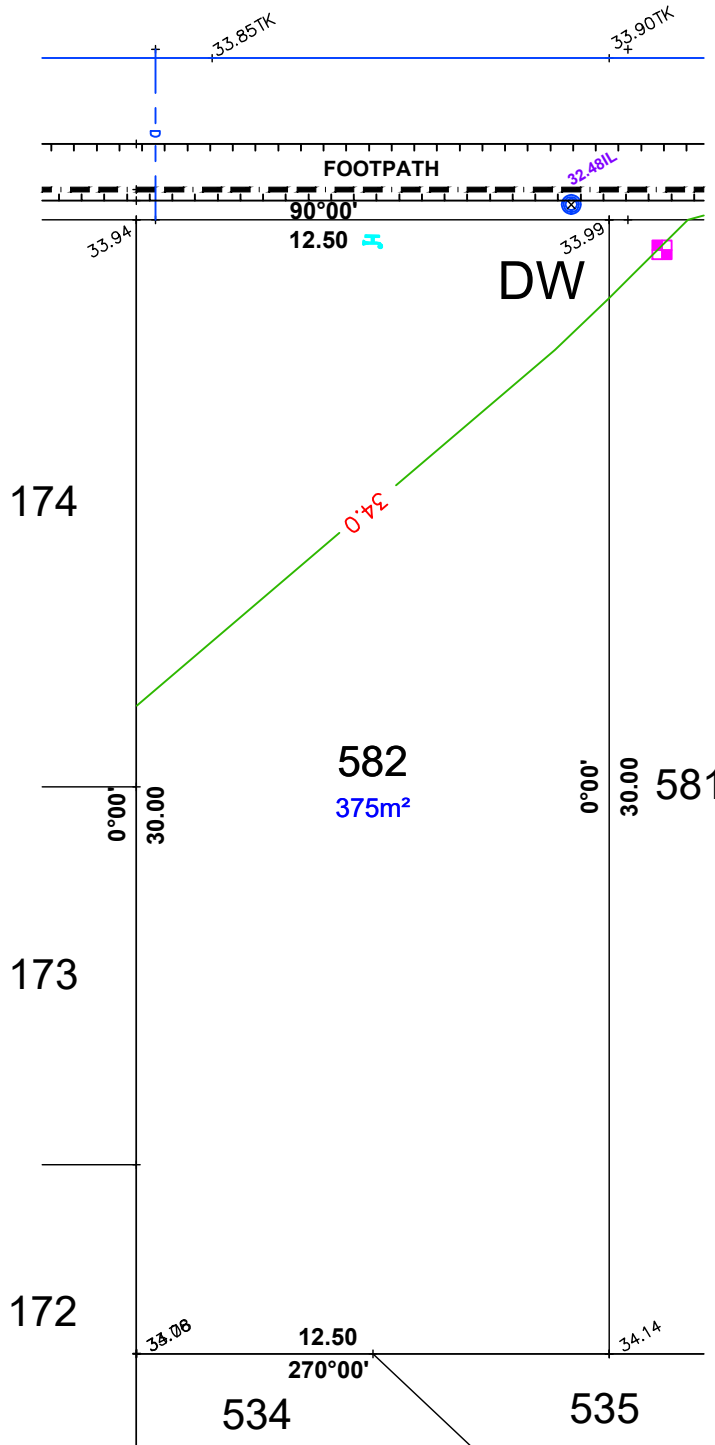

**LEGEND**

- SEWER IP
- STOBIE POLE
- TELSTRA PIT
- S/W GRATING
- SEWER MAN HOLE
- S/W MANHOLE
- LIGHT POLE
- E.T.S.A. CONNECTION
- TAP
- BOLLARD
- SIGN
- S/W CONNECTION
- FOOTPATH
- SIDE ENTRY PIT
- COMMON SERVICE TRENCH
- DOMESTIC
- SEWER IO
- POTABLE WATER CONN
- NON-POTABLE WATER CONN
- 29.00TRW TOP RETAINING WALL

NOTE: DATA SHOWN HEREON IS DESIGN INFORMATION  
AND SHOULD BE CONFIRMED.



1:200

ALEXANDER SYMONDS  
PH 8130 1666

ORIGINAL SHEET SIZE A4

**PRELIMINARY**

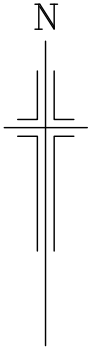

**IMPORTANT**  
 SERVICE AND DRIVEWAY LOCATIONS  
 ARE APPROXIMATE. ANY CHANGES WILL  
 BE AT THE PURCHASERS EXPENSE.  
 PURCHASER: \_\_\_\_\_  
 PURCHASER: \_\_\_\_\_  
 DATE: \_\_\_\_\_

**DISCLAIMER:**

Please note that this site plan is intended for  
 visual purposes only, additional survey work will  
 be required prior to commencing any design or  
 construction on the site.

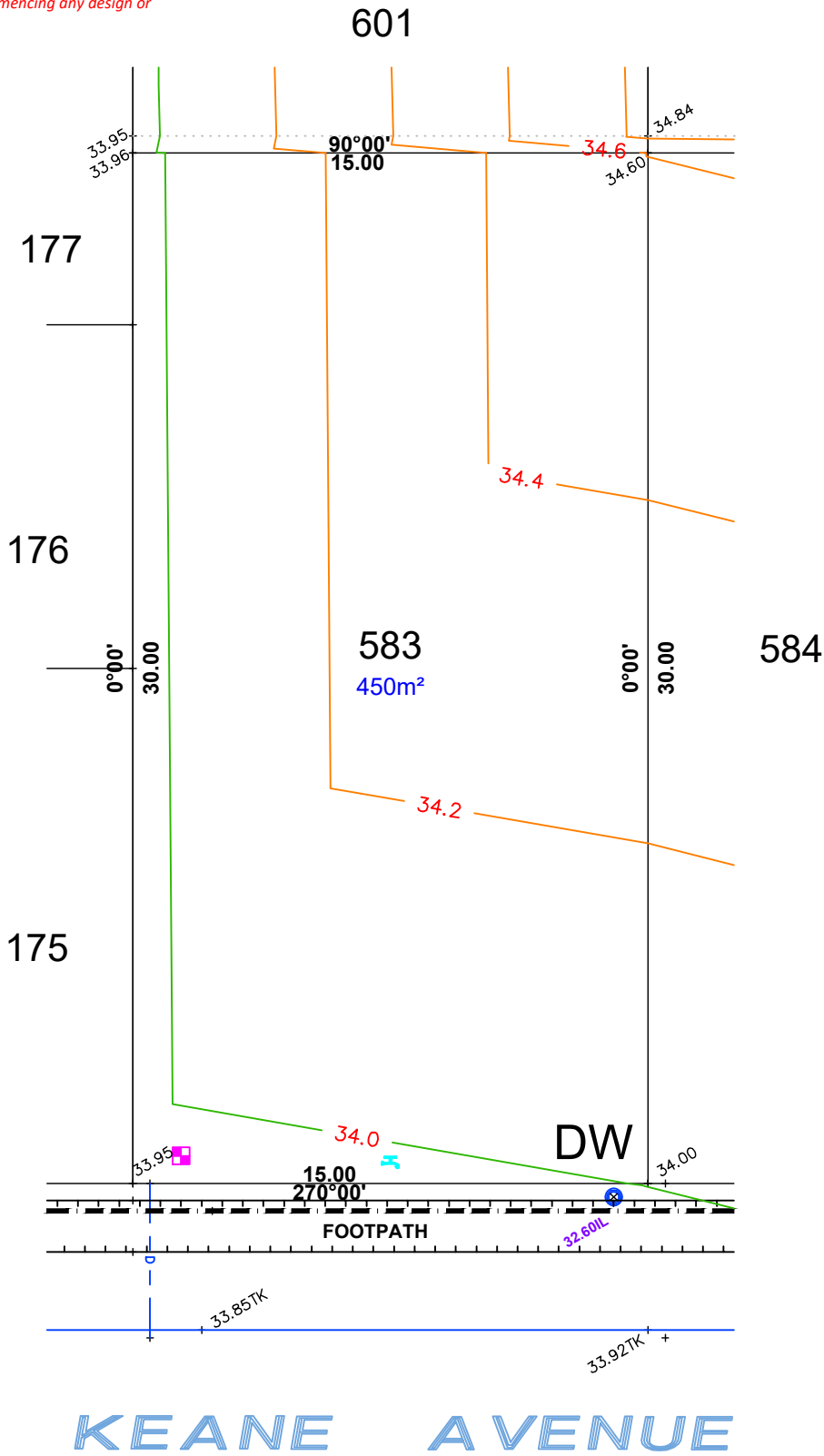

**LEGEND**

- WATER METER
- SIP SEWER IP
- STOBIE POLE
- TELSTRA PIT
- SW GRATING
- SEWER MAN HOLE
- SW MANHOLE
- LIGHT POLE
- ETSA CONNECTION
- TAP
- BOLLARD
- SIGN
- SW CONNECTION
- FOOTPATH
- SIDE ENTRY PIT
- COMMON SERVICE TRENCH
- DOMESTIC
- SEWER IO

NOTE: DATA SHOWN HEREON IS DESIGN INFORMATION  
 AND SHOULD BE CONFIRMED.



1:200

KEANE AVENUE

ALLOTMENT 584 in DEV. NO. 292/D066/12/004

in the area named

MUNNO PARA WEST

CT ---/----

**PRELIMINARY**

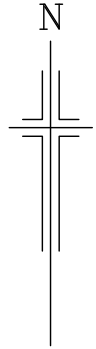

**IMPORTANT**  
SERVICE AND DRIVEWAY LOCATIONS  
ARE APPROXIMATE. ANY CHANGES WILL  
BE AT THE PURCHASERS EXPENSE.  
PURCHASER: \_\_\_\_\_  
PURCHASER: \_\_\_\_\_  
DATE: \_\_\_\_\_

**DISCLAIMER:**

Please note that this site plan is intended for  
visual purposes only, additional survey work will  
be required prior to commencing any design or  
construction on the site.

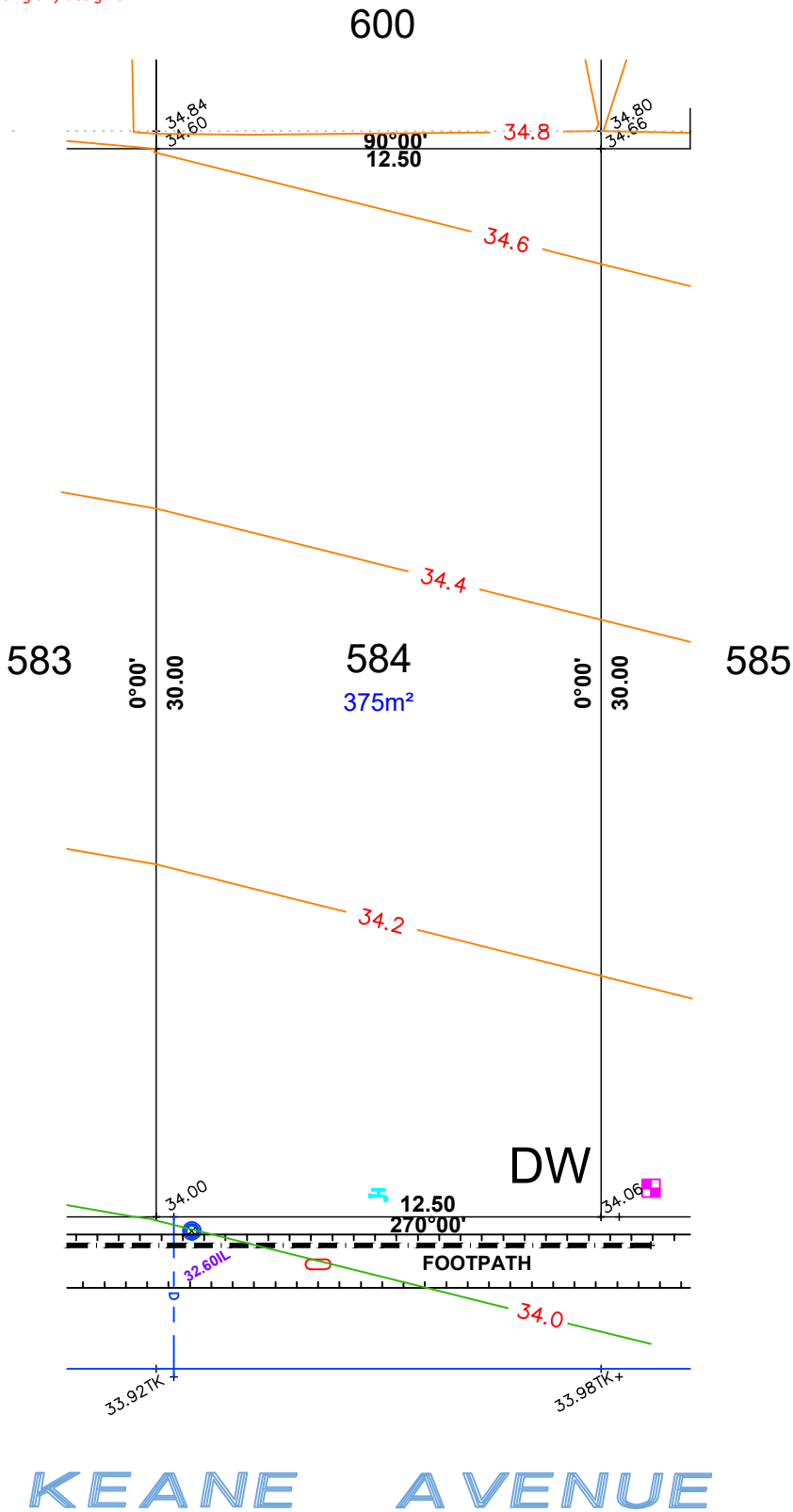

**LEGEND**

- WATER METER
- SIP SEWER IP
- STOBIE POLE
- TELSTRA PIT
- SW GRATING
- SEWER MAN HOLE
- SW MANHOLE
- LIGHT POLE
- ETSA CONNECTION
- TAP
- BOLLARD
- SIGN
- SW CONNECTION
- FOOTPATH
- SIDE ENTRY PIT
- COMMON SERVICE TRENCH
- DOMESTIC
- SEWER IO

NOTE: DATA SHOWN HEREON IS DESIGN INFORMATION  
AND SHOULD BE CONFIRMED.



1:200

ALEXANDER SYMONDS  
PH 8130 1666

**PRELIMINARY**

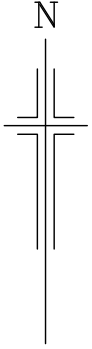

**IMPORTANT**  
 SERVICE AND DRIVEWAY LOCATIONS  
 ARE APPROXIMATE. ANY CHANGES WILL  
 BE AT THE PURCHASERS EXPENSE.  
 PURCHASER: \_\_\_\_\_  
 PURCHASER: \_\_\_\_\_  
 DATE: \_\_\_\_\_

**DISCLAIMER:**

Please note that this site plan is intended for  
 visual purposes only, additional survey work will  
 be required prior to commencing any design or  
 construction on the site.

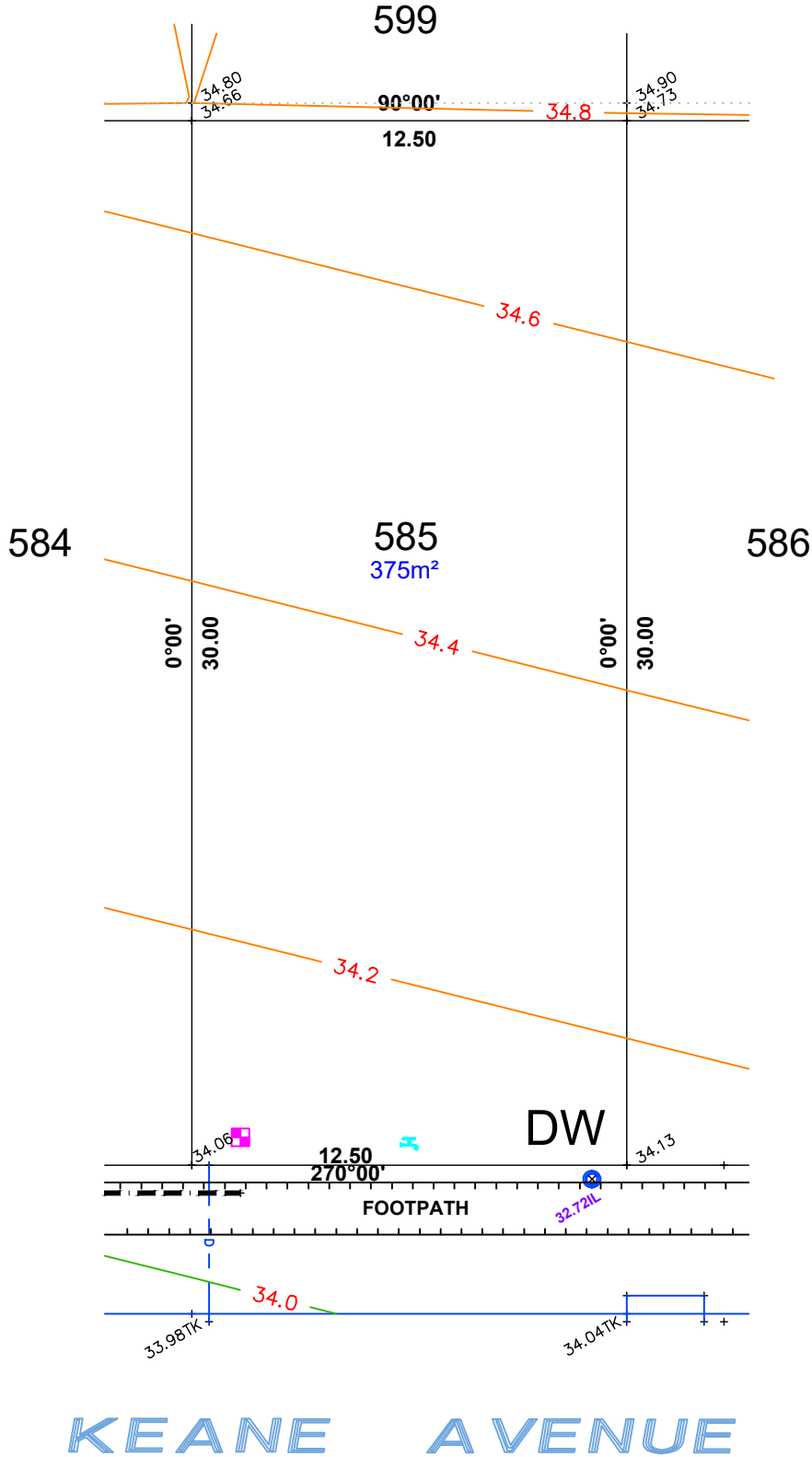

**LEGEND**

- WATER METER
- SIP SEWER IP
- STOBIE POLE
- TELSTRA PIT
- SW GRATING
- SEWER MAN HOLE
- SW MANHOLE
- LIGHT POLE
- ETSA CONNECTION
- TAP
- BOLLARD
- SIGN
- SW CONNECTION
- FOOTPATH
- SIDE ENTRY PIT
- COMMON SERVICE TRENCH
- DOMESTIC
- SEWER IO

NOTE: DATA SHOWN HEREON IS DESIGN INFORMATION  
 AND SHOULD BE CONFIRMED.



1:200

**PRELIMINARY**

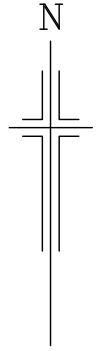

**IMPORTANT**  
SERVICE AND DRIVEWAY LOCATIONS  
ARE APPROXIMATE. ANY CHANGES WILL  
BE AT THE PURCHASERS EXPENSE.  
PURCHASER: \_\_\_\_\_  
PURCHASER: \_\_\_\_\_  
DATE: \_\_\_\_\_

**DISCLAIMER:**

Please note that this site plan is intended for  
visual purposes only, additional survey work will  
be required prior to commencing any design or  
construction on the site.

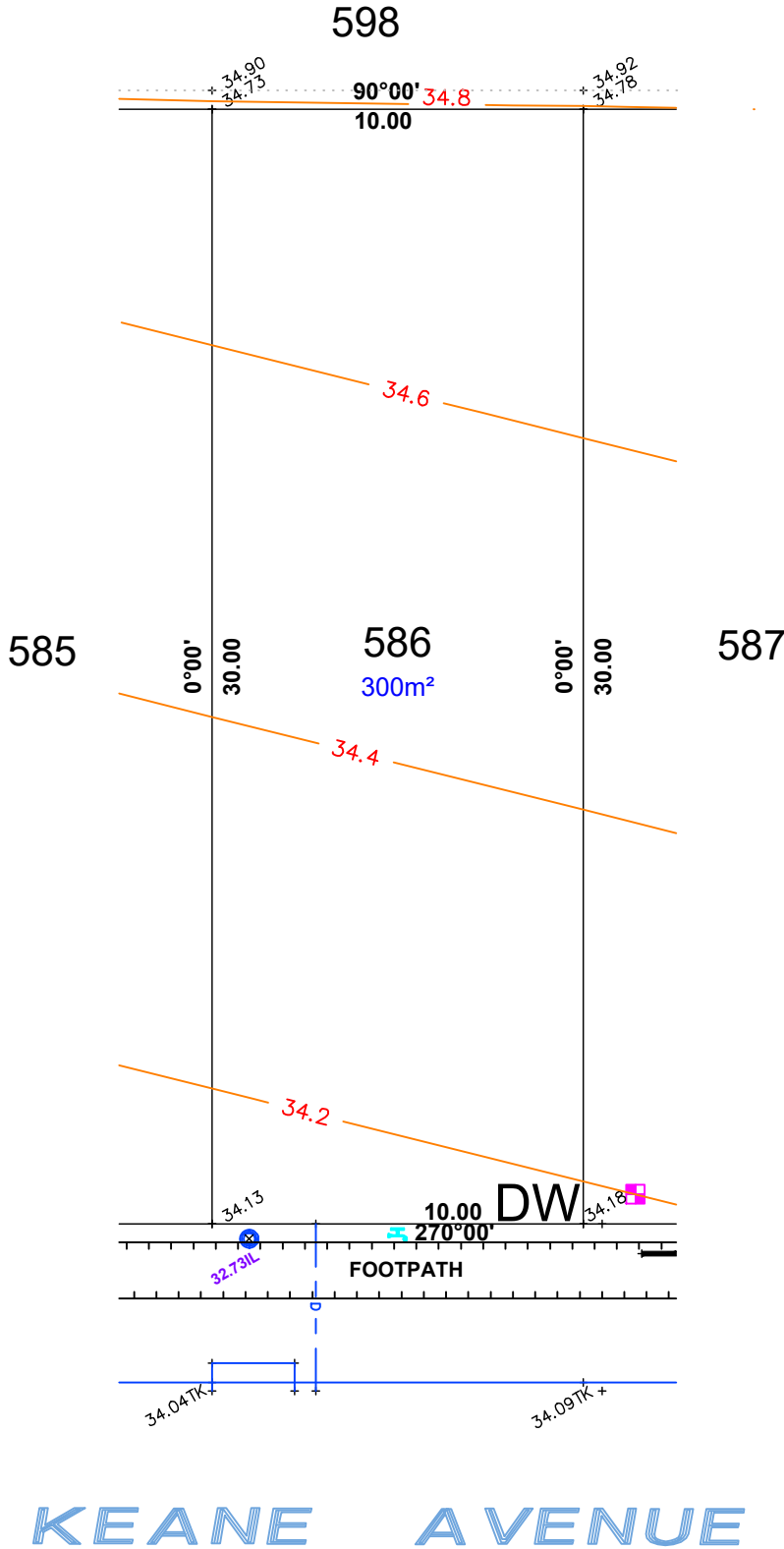

**LEGEND**

- WATER METER
- SIP SEWER IP
- STOBIE POLE
- TELSTRA PIT
- SW GRATING
- SEWER MAN HOLE
- SW MANHOLE
- LIGHT POLE
- E TSA CONNECTION
- TAP
- BOLLARD
- SIGN
- S/W CONNECTION
- FOOTPATH
- SIDE ENTRY PIT
- COMMON SERVICE TRENCH
- DOMESTIC
- SEWER IO

NOTE: DATA SHOWN HEREON IS DESIGN INFORMATION  
AND SHOULD BE CONFIRMED.



**IMPORTANT**  
 SERVICE AND DRIVEWAY LOCATIONS  
 ARE APPROXIMATE. ANY CHANGES WILL  
 BE AT THE PURCHASERS EXPENSE.  
 PURCHASER: \_\_\_\_\_  
 PURCHASER: \_\_\_\_\_  
 DATE: \_\_\_\_\_

**DISCLAIMER:**

Please note that this site plan is intended for  
 visual purposes only, additional survey work will  
 be required prior to commencing any design or  
 construction on the site.

**PRELIMINARY**

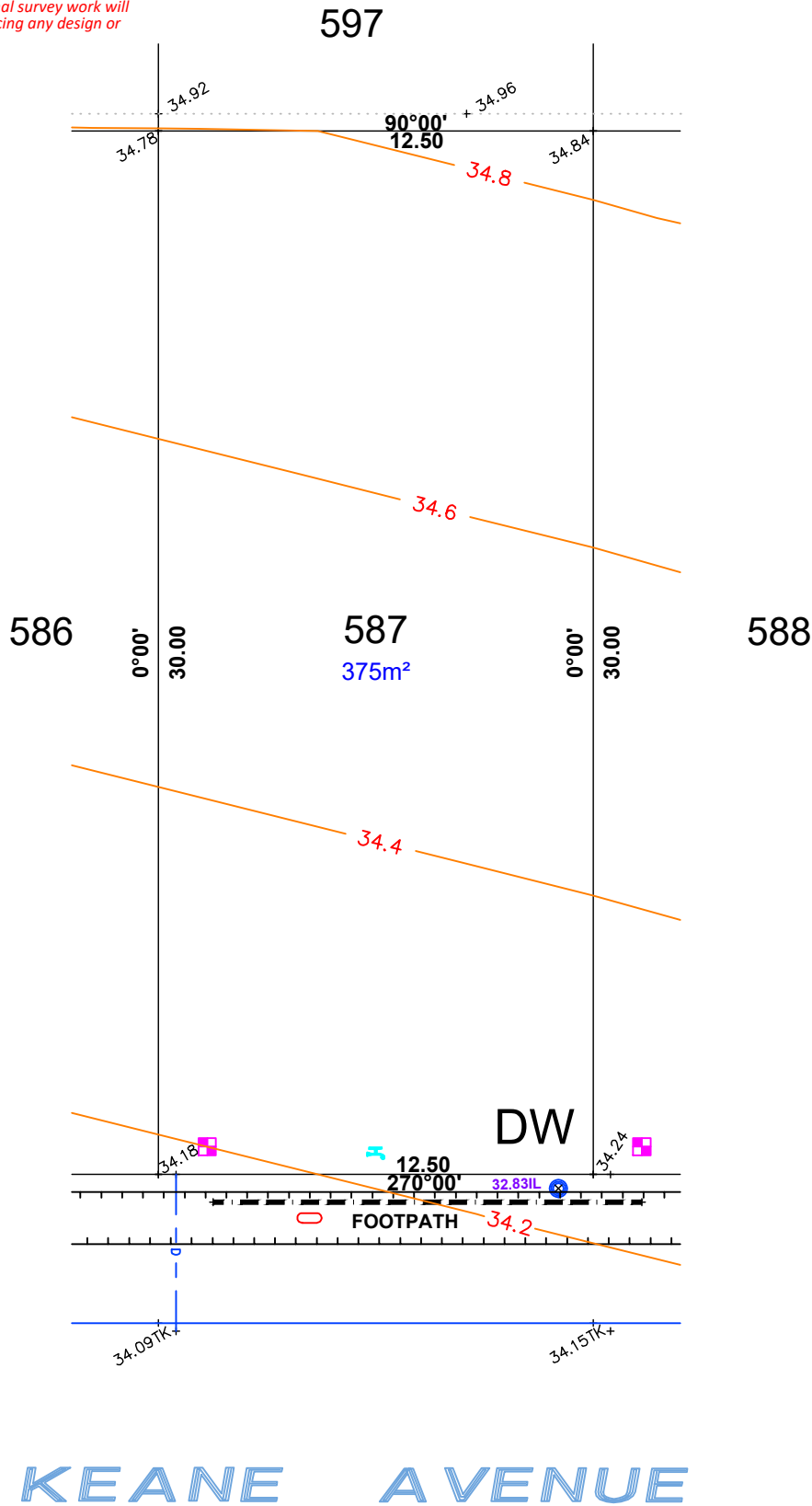
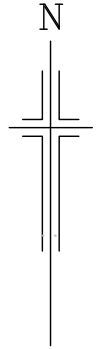

**LEGEND**

- WATER METER
- SIP SEWER IP
- STOBIE POLE
- TELSTRA PIT
- SW GRATING
- SEWER MAN HOLE
- SW MANHOLE
- LIGHT POLE
- ETSA CONNECTION
- TAP
- BOLLARD
- SIGN
- SW CONNECTION
- FOOTPATH
- SIDE ENTRY PIT
- COMMON SERVICE TRENCH
- DOMESTIC
- SEWER IO

NOTE: DATA SHOWN HEREON IS DESIGN INFORMATION  
 AND SHOULD BE CONFIRMED.



**IMPORTANT**  
SERVICE AND DRIVEWAY LOCATIONS  
ARE APPROXIMATE. ANY CHANGES WILL  
BE AT THE PURCHASERS EXPENSE.  
PURCHASER: \_\_\_\_\_  
PURCHASER: \_\_\_\_\_  
DATE: \_\_\_\_\_

**DISCLAIMER:**

Please note that this site plan is intended for  
visual purposes only, additional survey work will  
be required prior to commencing any design or  
construction on the site.

**PRELIMINARY**

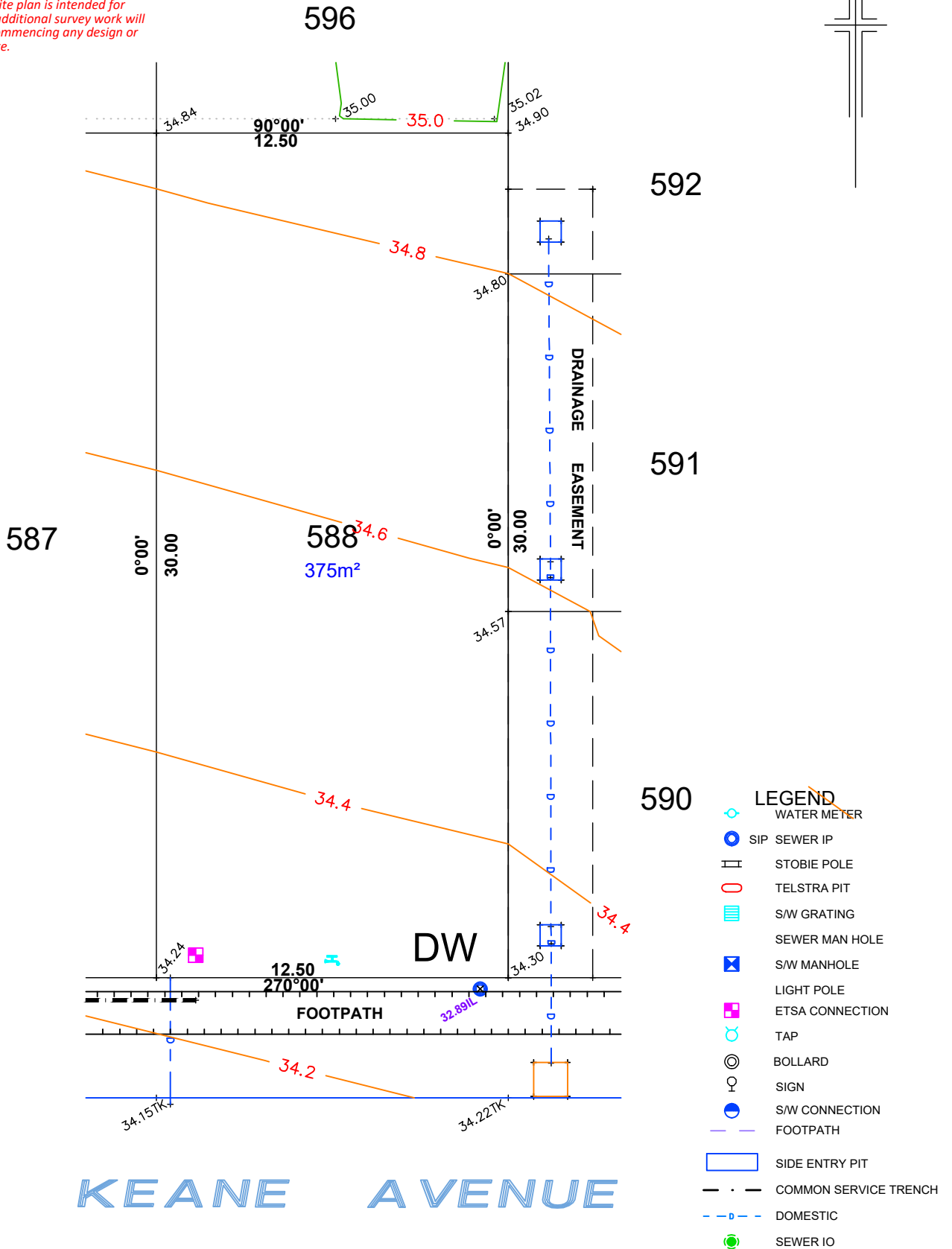
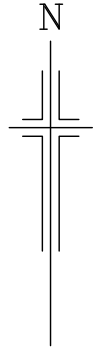

- LEGEND**
- WATER METER
  - SIP SEWER IP
  - STOBIE POLE
  - TELSTRA PIT
  - SW GRATING
  - SEWER MAN HOLE
  - SW MANHOLE
  - LIGHT POLE
  - ETSA CONNECTION
  - TAP
  - BOLLARD
  - SIGN
  - SW CONNECTION
  - FOOTPATH
  - SIDE ENTRY PIT
  - COMMON SERVICE TRENCH
  - DOMESTIC
  - SEWER IO

NOTE: DATA SHOWN HEREON IS DESIGN INFORMATION  
AND SHOULD BE CONFIRMED.



ALEXANDER SYMONDS  
PH 8130 1666

1:200