

IMPORTANT
 SERVICE AND DRIVEWAY LOCATIONS
 ARE APPROXIMATE. ANY CHANGES WILL
 BE AT THE PURCHASERS EXPENSE.
 PURCHASER: _____
 PURCHASER: _____
 DATE: _____

DISCLAIMER:

Please note that this site plan is intended for
 visual purposes only, additional survey work will
 be required prior to commencing any design or
 construction on the site.

ALLOTMENT 3068 in DEV. NO. 145/D028/20

in the area named
SEAFORD HEIGHTS

CT --/---

PRELIMINARY

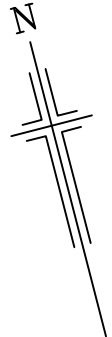
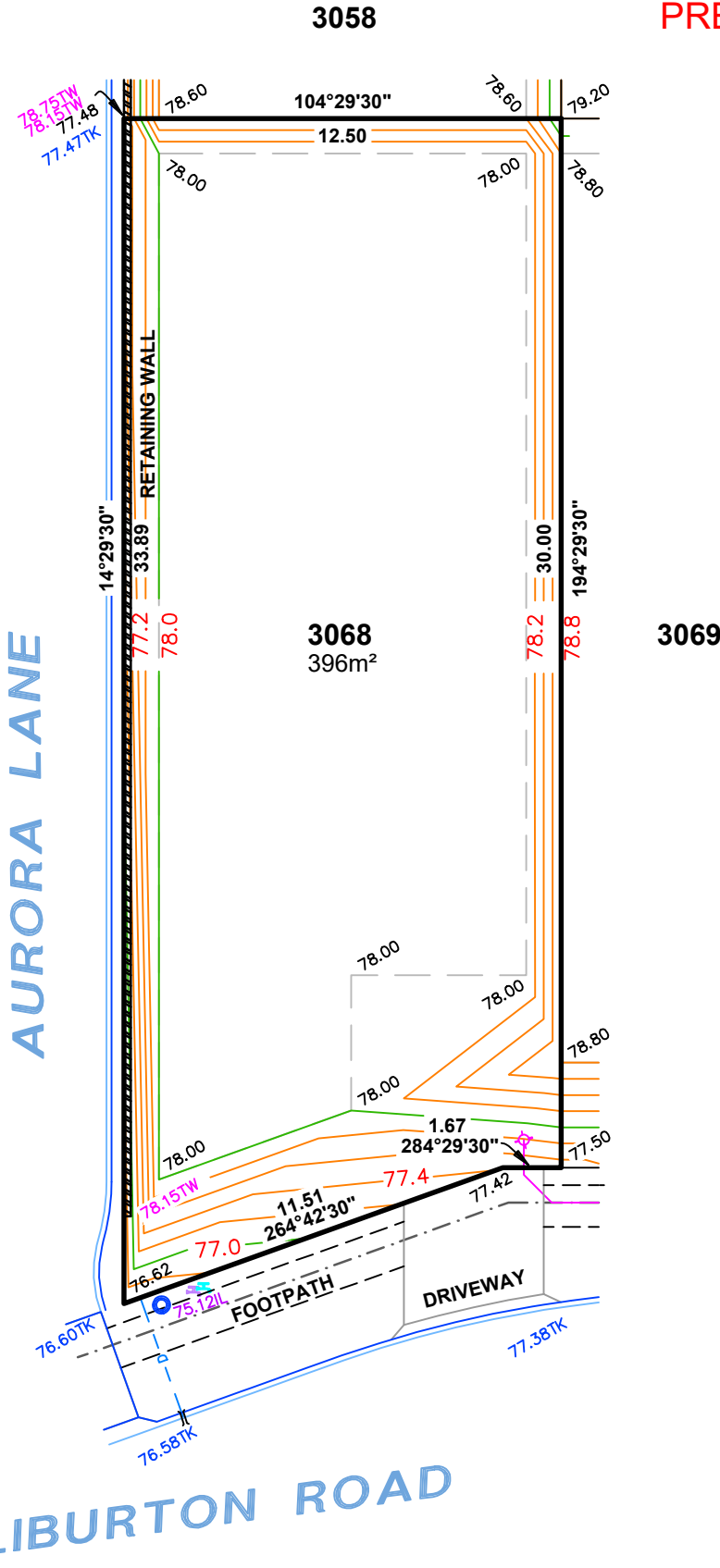

LEGEND

- SIGN
- ELECTRICAL LEAD IN
- SAPN CONNECTION
- LIGHT POLE
- NBN / TELSTRA PIT
- STORMWATER GRATE
- STORMWATER MANHOLE / JB
- STORMWATER CONNECTION
- SIDE ENTRY PIT (SEP)
- DOMESTIC OUTLET (STORMWATER)
- SEWER IO
- SEWER MANHOLE
- SEWER IP
- POTABLE WATER CONNECTION
- RECLAIMED WATER CONNECTION
- FOOTPATH
- COMMON SERVICE TRENCH
- BUILDING BENCH PADS
- RETAINING WALL
- TOP OF RETAINING WALL



ALEXANDER SYMONDS
 PH 8130 1666

1:200

DISCLAIMER: DATA SHOWN HEREON IS DESIGN INFORMATION AND SHOULD BE CONFIRMED
 ORIGINAL SHEET SIZE A4

IMPORTANT
 SERVICE AND DRIVEWAY LOCATIONS
 ARE APPROXIMATE. ANY CHANGES WILL
 BE AT THE PURCHASERS EXPENSE.
 PURCHASER: _____
 PURCHASER: _____
 DATE: _____

ALLOTMENT 3069 in DEV. NO. 145/D028/20
 in the area named
SEAFORD HEIGHTS
 CT --/---

PRELIMINARY

DISCLAIMER:
 Please note that this site plan is intended for
 visual purposes only, additional survey work will
 be required prior to commencing any design or
 construction on the site.

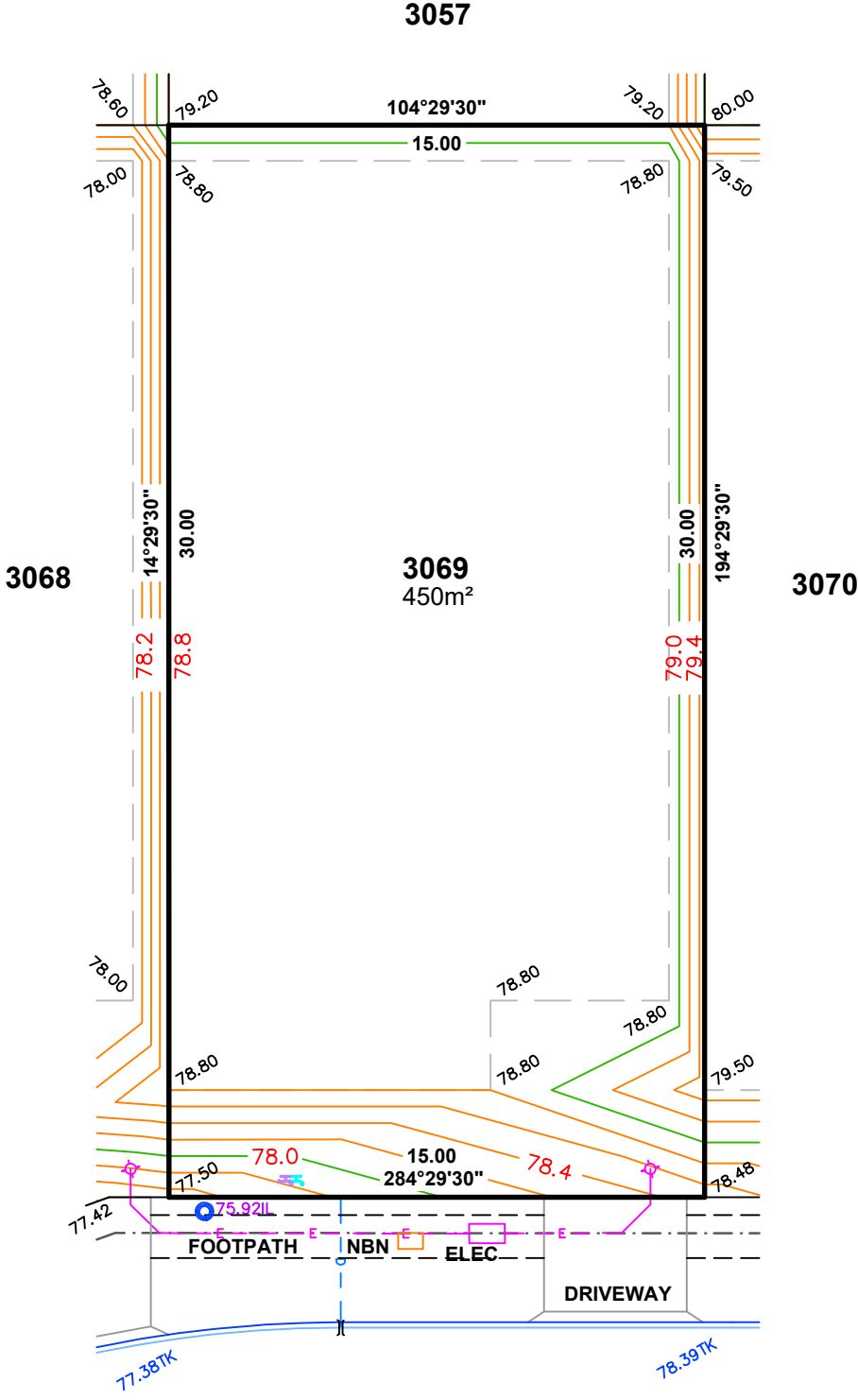
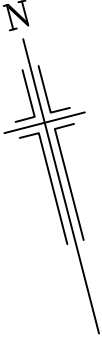

LEGEND

- SIGN
- ELECTRICAL LEAD IN
- SAPN CONNECTION
- LIGHT POLE
- NBN / TELSTRA PIT
- STORMWATER GRATE
- STORMWATER MANHOLE / JB
- STORMWATER CONNECTION
- SIDE ENTRY PIT (SEP)
- DOMESTIC OUTLET (STORMWATER)
- SEWER IO
- SEWER MANHOLE
- SEWER IP
- POTABLE WATER CONNECTION
- RECLAIMED WATER CONNECTION
- FOOTPATH
- COMMON SERVICE TRENCH
- BUILDING BENCH PADS



IMPORTANT
 SERVICE AND DRIVEWAY LOCATIONS
 ARE APPROXIMATE. ANY CHANGES WILL
 BE AT THE PURCHASERS EXPENSE.
 PURCHASER: _____
 PURCHASER: _____
 DATE: _____

ALLOTMENT 3070 in DEV. NO. 145/D028/20
 in the area named
SEAFORD HEIGHTS
 CT --/--

PRELIMINARY

DISCLAIMER:

*Please note that this site plan is intended for
 visual purposes only, additional survey work will
 be required prior to commencing any design or
 construction on the site.*

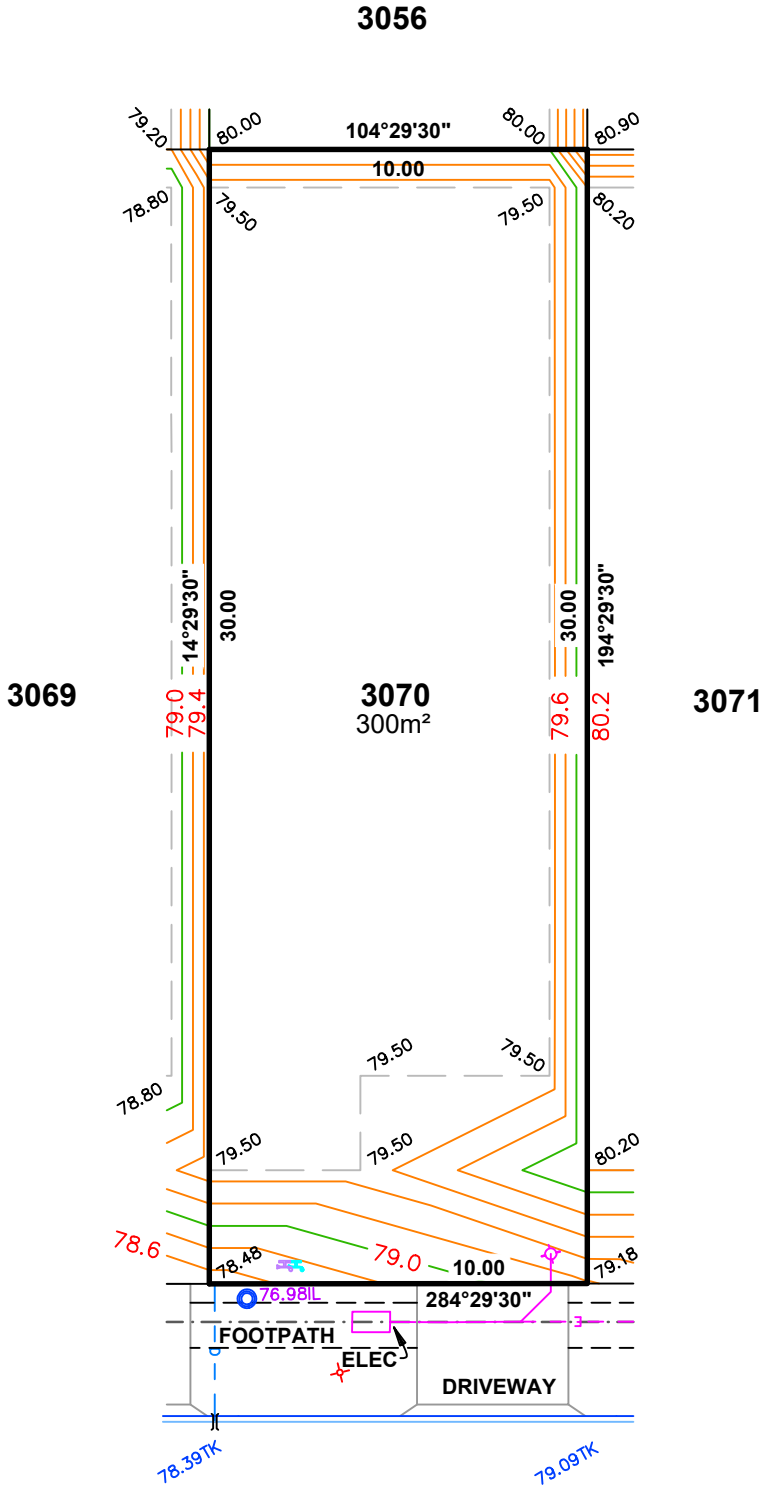

LEGEND

- SIGN
- ELECTRICAL LEAD IN
- SAPN CONNECTION
- LIGHT POLE
- NBN / TELSTRA PIT
- STORMWATER GRATE
- STORMWATER MANHOLE / JB
- STORMWATER CONNECTION
- SIDE ENTRY PIT (SEP)
- DOMESTIC OUTLET (STORMWATER)
- SEWER IO
- SEWER MANHOLE
- SEWER IP
- POTABLE WATER CONNECTION
- RECLAIMED WATER CONNECTION
- FOOTPATH
- COMMON SERVICE TRENCH
- BUILDING BENCH PADS

HALIBURTON ROAD



ALEXANDER SYMONDS
 PH 8130 1666

1:200

DISCLAIMER: DATA SHOWN HEREON IS DESIGN INFORMATION AND SHOULD BE CONFIRMED
 ORIGINAL SHEET SIZE A4

IMPORTANT
 SERVICE AND DRIVEWAY LOCATIONS
 ARE APPROXIMATE. ANY CHANGES WILL
 BE AT THE PURCHASERS EXPENSE.
 PURCHASER: _____
 PURCHASER: _____
 DATE: _____

ALLOTMENT 3071 in DEV. NO. 145/D028/20
 in the area named
SEAFORD HEIGHTS
 CT --/--

PRELIMINARY

DISCLAIMER:

*Please note that this site plan is intended for
 visual purposes only, additional survey work will
 be required prior to commencing any design or
 construction on the site.*

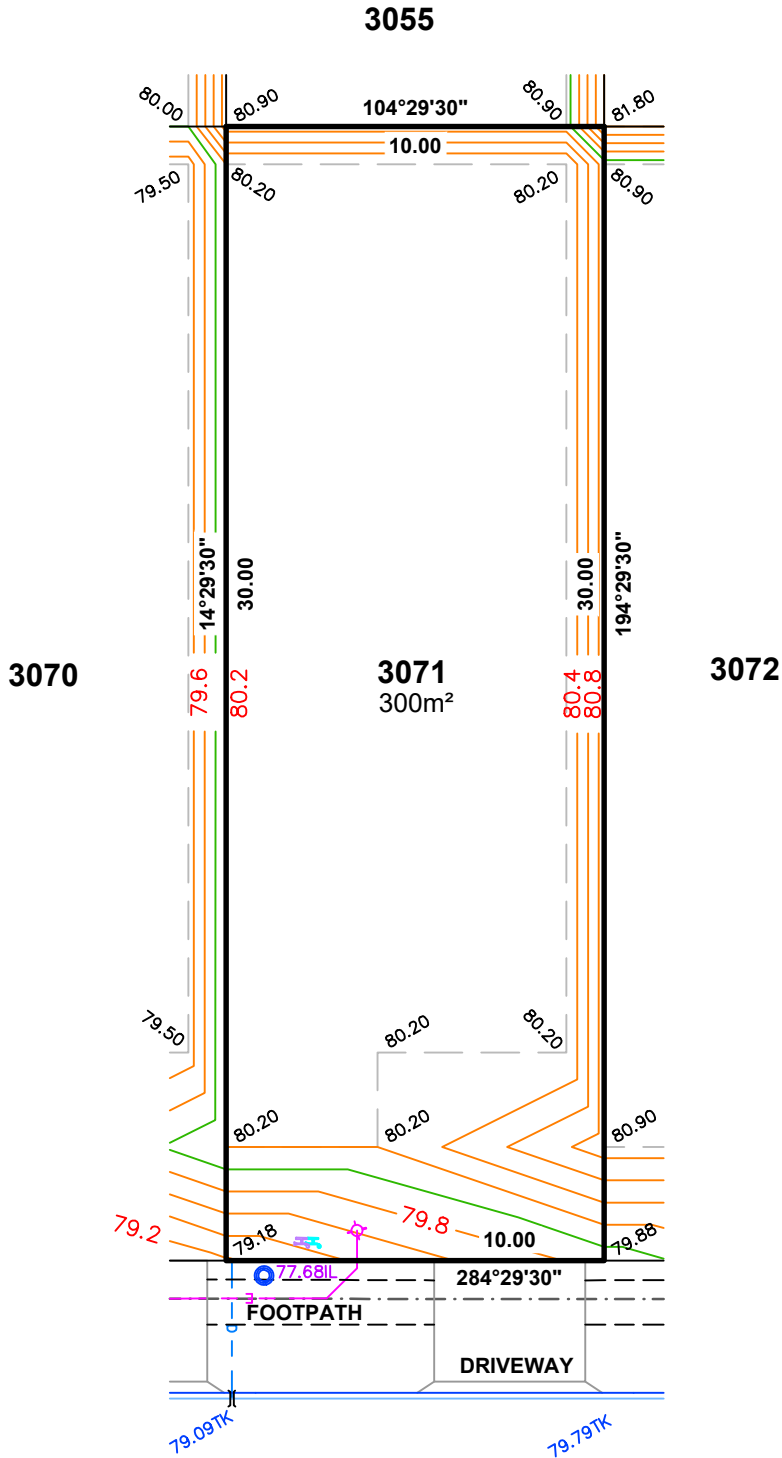

LEGEND

- ♀ SIGN
- ⬠ ELECTRICAL LEAD IN
- ⬠ SAPN CONNECTION
- ⬠ LIGHT POLE
- ⬠ NBN / TELSTRA PIT
- ⬠ STORMWATER GRATE
- ⬠ STORMWATER MANHOLE / JB
- ⬠ STORMWATER CONNECTION
- ⬠ SIDE ENTRY PIT (SEP)
- - - DOMESTIC OUTLET (STORMWATER)
- ⬠ SEWER IO
- ⬠ SEWER MANHOLE
- ⬠ SEWER IP
- ⬠ POTABLE WATER CONNECTION
- ⬠ RECLAIMED WATER CONNECTION
- - - FOOTPATH
- - - COMMON SERVICE TRENCH
- - - BUILDING BENCH PADS

HALIBURTON ROAD



ALEXANDER SYMONDS
 PH 8130 1666

1:200

DISCLAIMER: DATA SHOWN HEREON IS DESIGN INFORMATION AND SHOULD BE CONFIRMED
 ORIGINAL SHEET SIZE A4

IMPORTANT
 SERVICE AND DRIVEWAY LOCATIONS
 ARE APPROXIMATE. ANY CHANGES WILL
 BE AT THE PURCHASERS EXPENSE.
 PURCHASER: _____
 PURCHASER: _____
 DATE: _____

ALLOTMENT 3072 in DEV. NO. 145/D028/20
 in the area named
SEAFORD HEIGHTS
 CT --/--

PRELIMINARY

DISCLAIMER:

*Please note that this site plan is intended for
 visual purposes only, additional survey work will
 be required prior to commencing any design or
 construction on the site.*

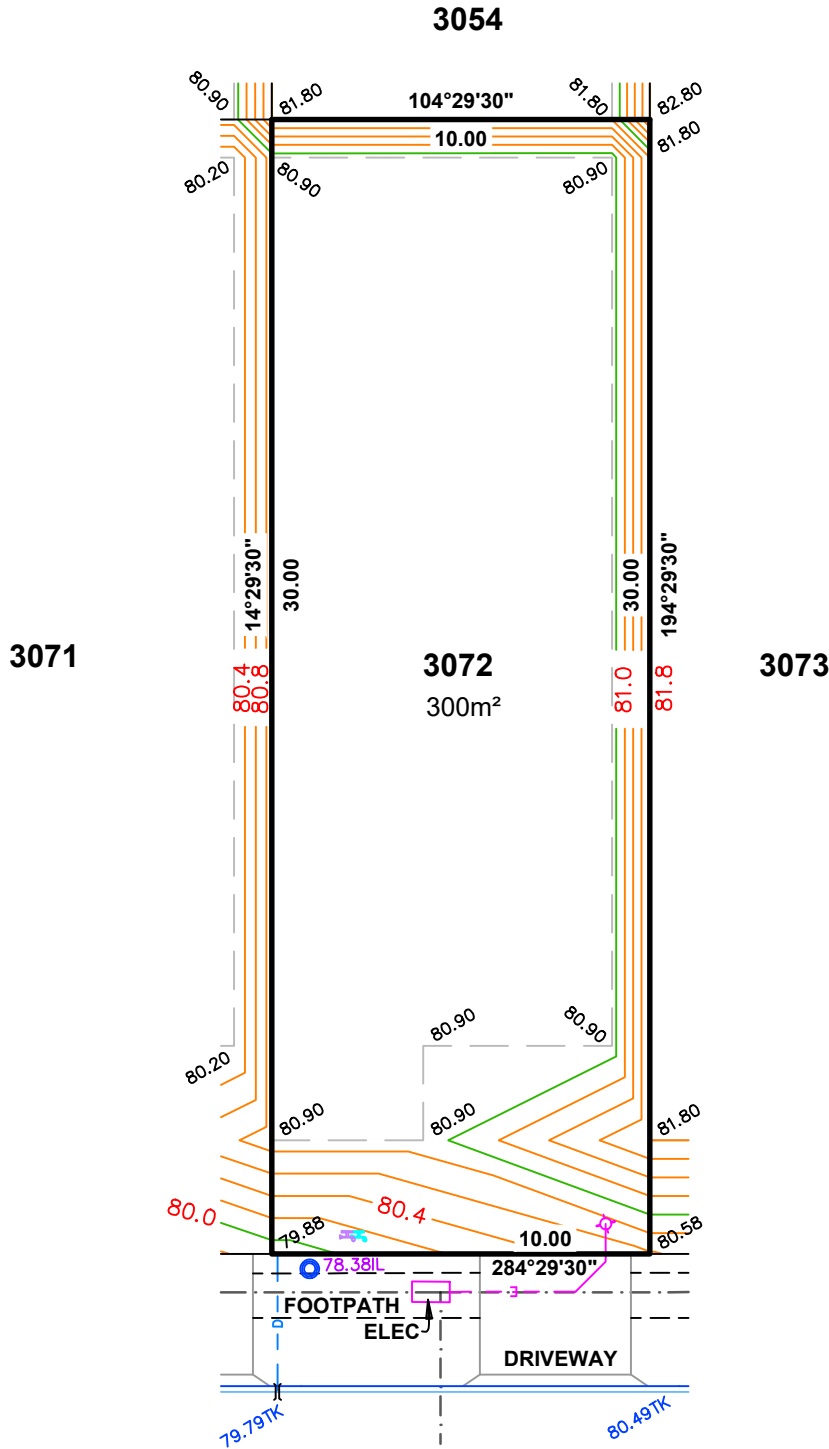

LEGEND

- ♀ SIGN
- ⚡ ELECTRICAL LEAD IN
- ⊞ SAPN CONNECTION
- ⊕ LIGHT POLE
- NBN / TELSTRA PIT
- ▒ STORMWATER GRATE
- ⊠ STORMWATER MANHOLE / JB
- STORMWATER CONNECTION
- SIDE ENTRY PIT (SEP)
- - - DOMESTIC OUTLET (STORMWATER)
- SEWER IO
- SEWER MANHOLE
- SEWER IP
- ⚡ POTABLE WATER CONNECTION
- ⚡ RECLAIMED WATER CONNECTION
- - - FOOTPATH
- - - COMMON SERVICE TRENCH
- - - BUILDING BENCH PADS



ALEXANDER SYMONDS
 PH 8130 1666

1:200

DISCLAIMER: DATA SHOWN HEREON IS DESIGN INFORMATION AND SHOULD BE CONFIRMED
 ORIGINAL SHEET SIZE A4

IMPORTANT
 SERVICE AND DRIVEWAY LOCATIONS
 ARE APPROXIMATE. ANY CHANGES WILL
 BE AT THE PURCHASERS EXPENSE.
 PURCHASER: _____
 PURCHASER: _____
 DATE: _____

ALLOTMENT 3081 in DEV. NO. 145/D028/20

in the area named
SEAFORD HEIGHTS

CT --/---

PRELIMINARY

DISCLAIMER:

Please note that this site plan is intended for
 visual purposes only, additional survey work will
 be required prior to commencing any design or
 construction on the site.

HALIBURTON ROAD

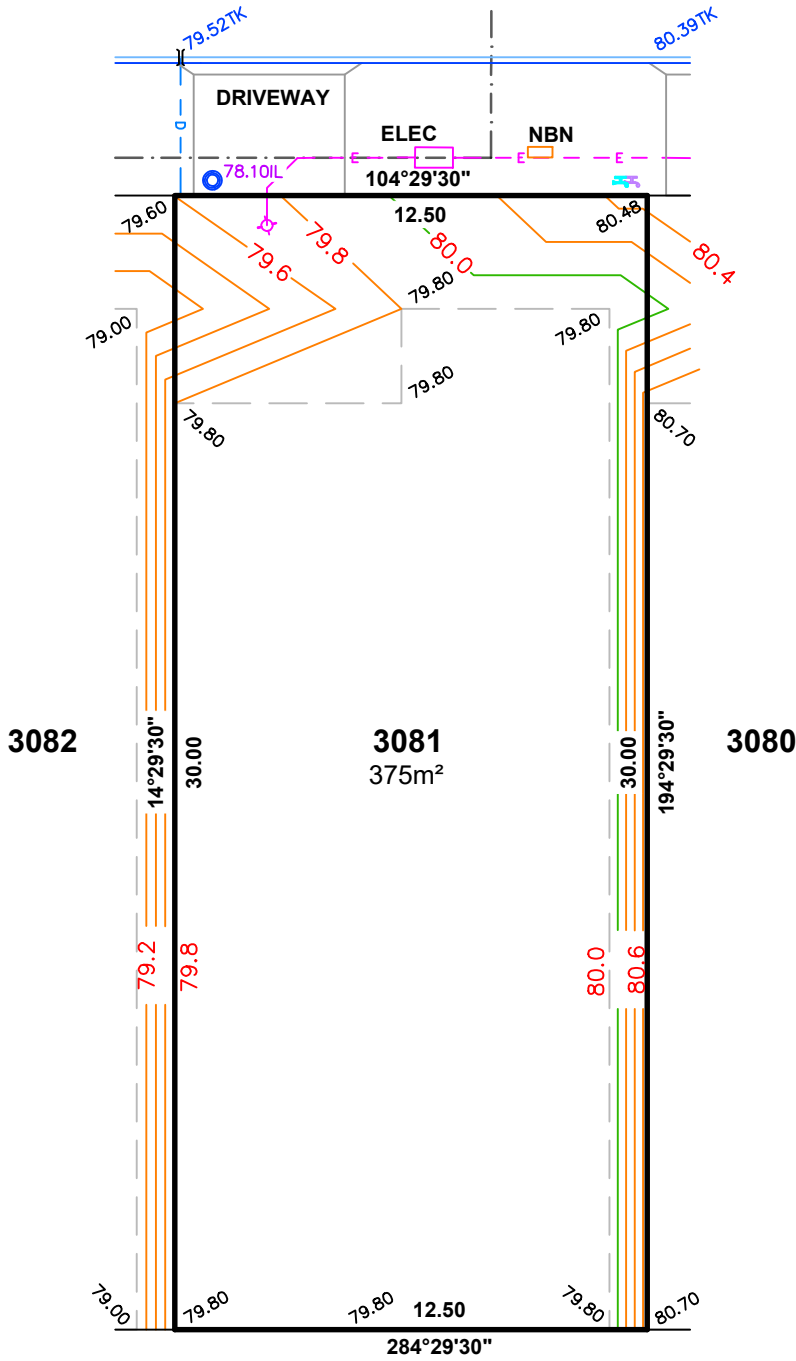

LEGEND

- SIGN
- ELECTRICAL LEAD IN
- SAPN CONNECTION
- LIGHT POLE
- NBN / TELSTRA PIT
- STORMWATER GRATE
- STORMWATER MANHOLE / JB
- STORMWATER CONNECTION
- SIDE ENTRY PIT (SEP)
- DOMESTIC OUTLET (STORMWATER)
- SEWER IO
- SEWER MANHOLE
- SEWER IP
- POTABLE WATER CONNECTION
- RECLAIMED WATER CONNECTION
- FOOTPATH
- COMMON SERVICE TRENCH
- BUILDING BENCH PADS



ALEXANDER SYMONDS
 PH 8130 1666

1:200

DISCLAIMER: DATA SHOWN HEREON IS DESIGN INFORMATION AND SHOULD BE CONFIRMED
 ORIGINAL SHEET SIZE A4

IMPORTANT
 SERVICE AND DRIVEWAY LOCATIONS
 ARE APPROXIMATE. ANY CHANGES WILL
 BE AT THE PURCHASERS EXPENSE.
 PURCHASER: _____
 PURCHASER: _____
 DATE: _____

ALLOTMENT 3082 in DEV. NO. 145/D028/20
 in the area named
SEAFORD HEIGHTS
 CT --/--

PRELIMINARY

DISCLAIMER:

*Please note that this site plan is intended for
 visual purposes only, additional survey work will
 be required prior to commencing any design or
 construction on the site.*

HALIBURTON ROAD

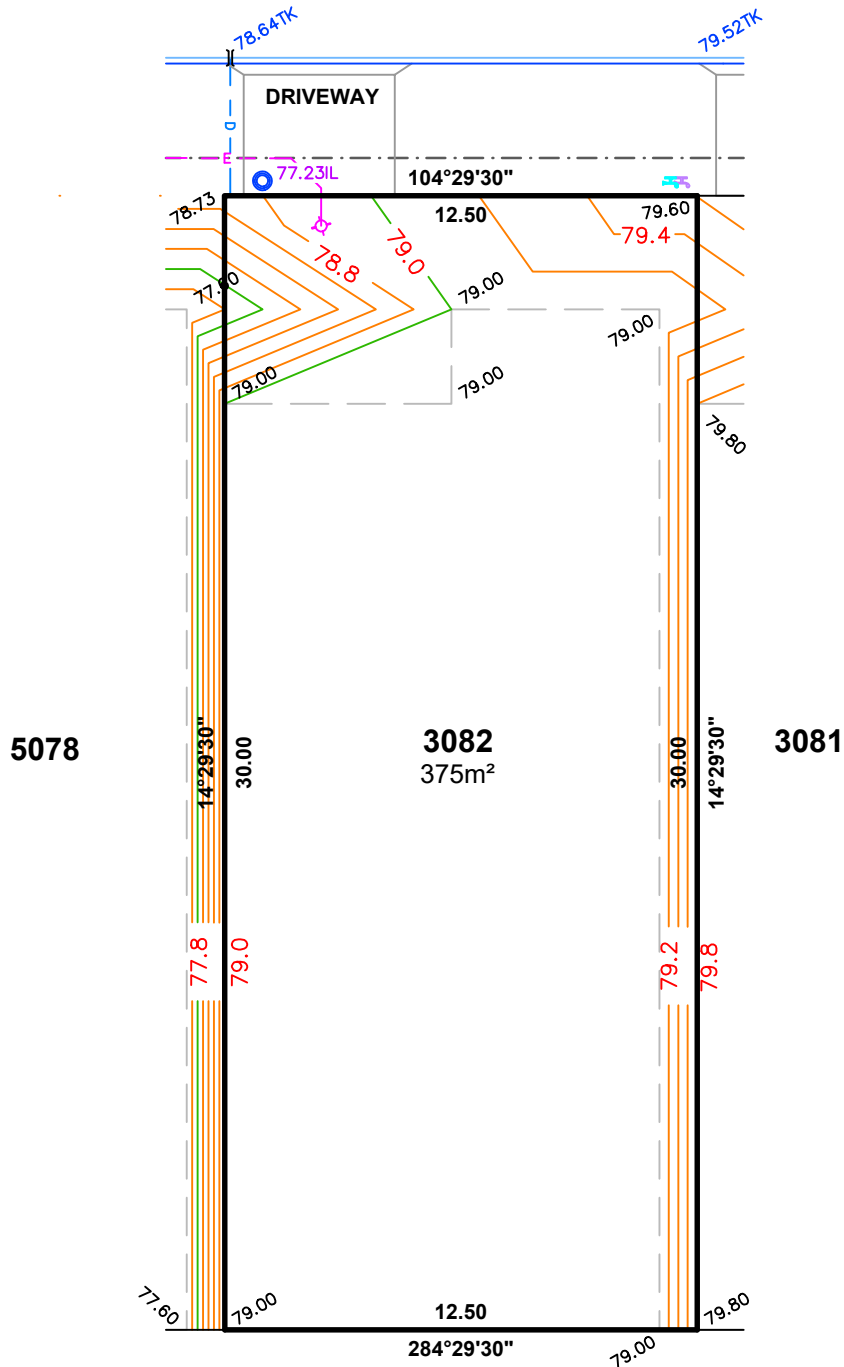
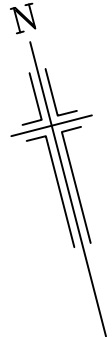

- LEGEND**
- ♀ SIGN
 - ♀ ELECTRICAL LEAD IN
 - ♀ SAPN CONNECTION
 - ♀ LIGHT POLE
 - ♀ NBN / TELSTRA PIT
 - ♀ STORMWATER GRATE
 - ♀ STORMWATER MANHOLE / JB
 - ♀ STORMWATER CONNECTION
 - ♀ SIDE ENTRY PIT (SEP)
 - ♀ DOMESTIC OUTLET (STORMWATER)
 - ♀ SEWER IO
 - ♀ SEWER MANHOLE
 - ♀ SEWER IP
 - ♀ POTABLE WATER CONNECTION
 - ♀ RECLAIMED WATER CONNECTION
 - FOOTPATH
 - COMMON SERVICE TRENCH
 - BUILDING BENCH PADS



ALEXANDER SYMONDS
 PH 8130 1666

1:200

DISCLAIMER: DATA SHOWN HEREON IS DESIGN INFORMATION AND SHOULD BE CONFIRMED
 ORIGINAL SHEET SIZE A4

IMPORTANT
 SERVICE AND DRIVEWAY LOCATIONS
 ARE APPROXIMATE. ANY CHANGES WILL
 BE AT THE PURCHASERS EXPENSE.
 PURCHASER: _____
 PURCHASER: _____
 DATE: _____

ALLOTMENT 3084 in DEV. NO. 145/D028/20

**in the area named
 SEAFORD HEIGHTS**

CT --/---

PRELIMINARY

DISCLAIMER:

Please note that this site plan is intended for
 visual purposes only, additional survey work will
 be required prior to commencing any design or
 construction on the site.

HALIBURTON ROAD

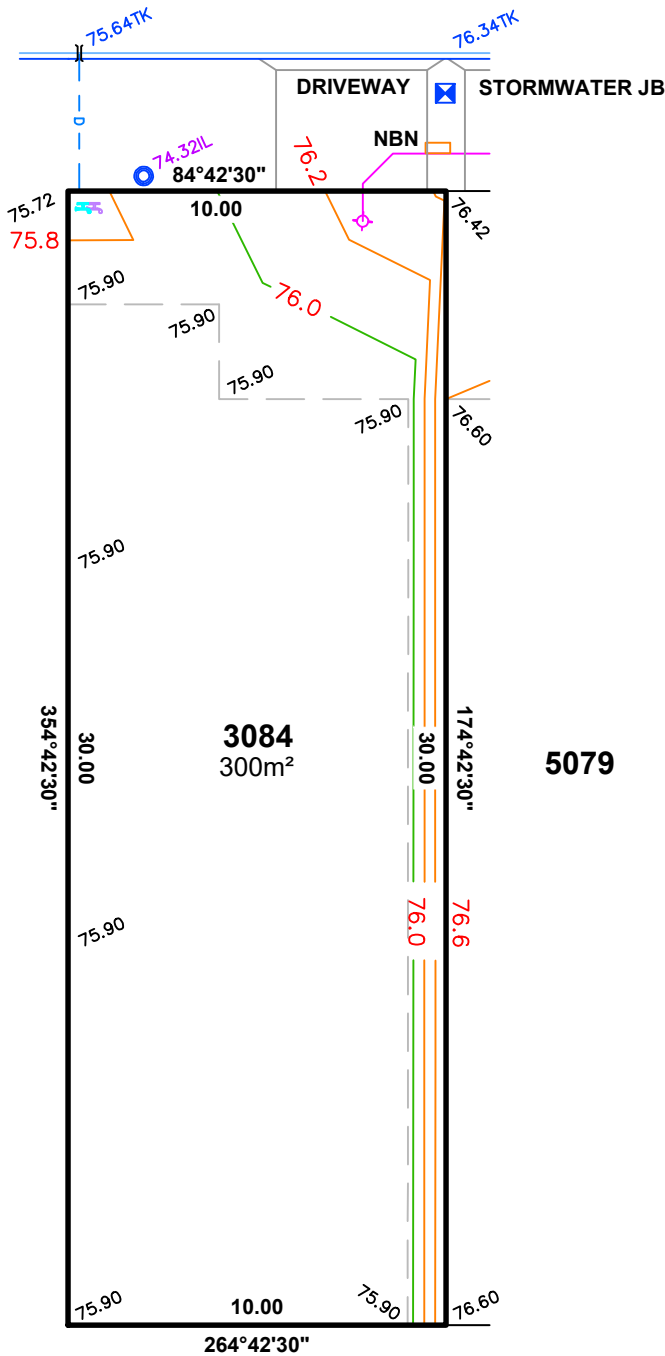

LEGEND

- SIGN
- ELECTRICAL LEAD IN
- SAPN CONNECTION
- LIGHT POLE
- NBN / TELSTRA PIT
- STORMWATER GRATE
- STORMWATER MANHOLE / JB
- STORMWATER CONNECTION
- SIDE ENTRY PIT (SEP)
- DOMESTIC OUTLET (STORMWATER)
- SEWER IO
- SEWER MANHOLE
- SEWER IP
- POTABLE WATER CONNECTION
- RECLAIMED WATER CONNECTION
- FOOTPATH
- COMMON SERVICE TRENCH
- BUILDING BENCH PADS



ALEXANDER SYMONDS
 PH 8130 1666

1:200

DISCLAIMER: DATA SHOWN HEREON IS DESIGN INFORMATION AND SHOULD BE CONFIRMED
 ORIGINAL SHEET SIZE A4

IMPORTANT
 SERVICE AND DRIVEWAY LOCATIONS
 ARE APPROXIMATE. ANY CHANGES WILL
 BE AT THE PURCHASERS EXPENSE.
 PURCHASER: _____
 PURCHASER: _____
 DATE: _____

DISCLAIMER:

Please note that this site plan is intended for
 visual purposes only, additional survey work will
 be required prior to commencing any design or
 construction on the site.

ALLOTMENT 5078 in DEV. NO. 145/D028/20

in the area named
SEAFORD HEIGHTS

CT --/---

PRELIMINARY

HALIBURTON ROAD

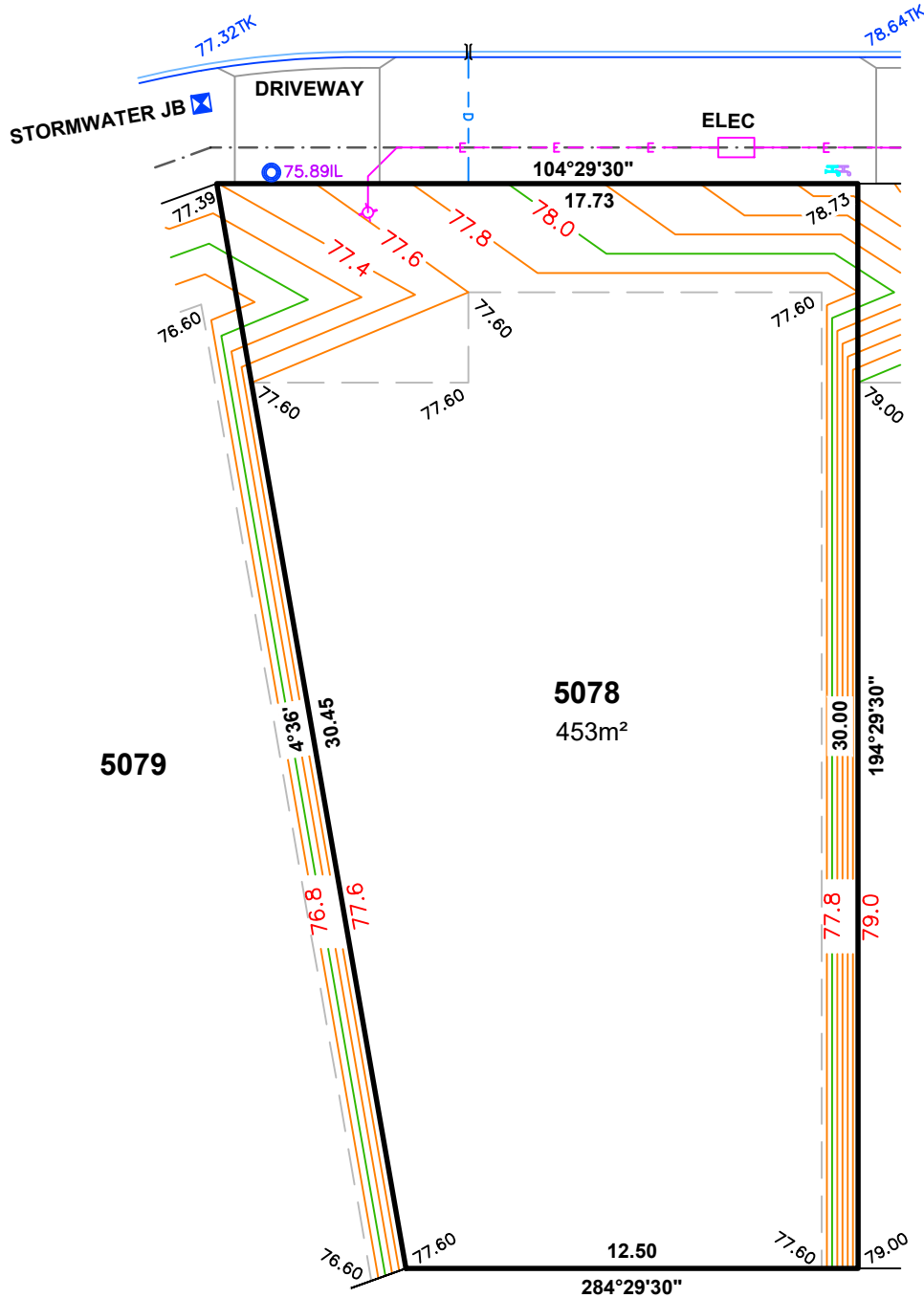
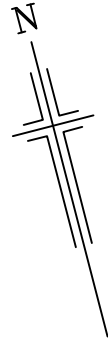

3082

5079

5078
 453m²

LEGEND

- SIGN
- ELECTRICAL LEAD IN
- SAPN CONNECTION
- LIGHT POLE
- NBN / TELSTRA PIT
- STORMWATER GRATE
- STORMWATER MANHOLE / JB
- STORMWATER CONNECTION
- SIDE ENTRY PIT (SEP)
- DOMESTIC OUTLET (STORMWATER)
- SEWER IO
- SEWER MANHOLE
- SEWER IP
- POTABLE WATER CONNECTION
- RECLAIMED WATER CONNECTION
- FOOTPATH
- COMMON SERVICE TRENCH
- BUILDING BENCH PADS



ALEXANDER SYMONDS
 PH 8130 1666

1:200

DISCLAIMER: DATA SHOWN HEREON IS DESIGN INFORMATION AND SHOULD BE CONFIRMED
 ORIGINAL SHEET SIZE A4

IMPORTANT
 SERVICE AND DRIVEWAY LOCATIONS
 ARE APPROXIMATE. ANY CHANGES WILL
 BE AT THE PURCHASERS EXPENSE.
 PURCHASER: _____
 PURCHASER: _____
 DATE: _____

ALLOTMENT 5079 in DEV. NO. 145/D028/20

in the area named
SEAFORD HEIGHTS

CT --/---

PRELIMINARY

DISCLAIMER:

Please note that this site plan is intended for
 visual purposes only, additional survey work will
 be required prior to commencing any design or
 construction on the site.

HALIBURTON ROAD

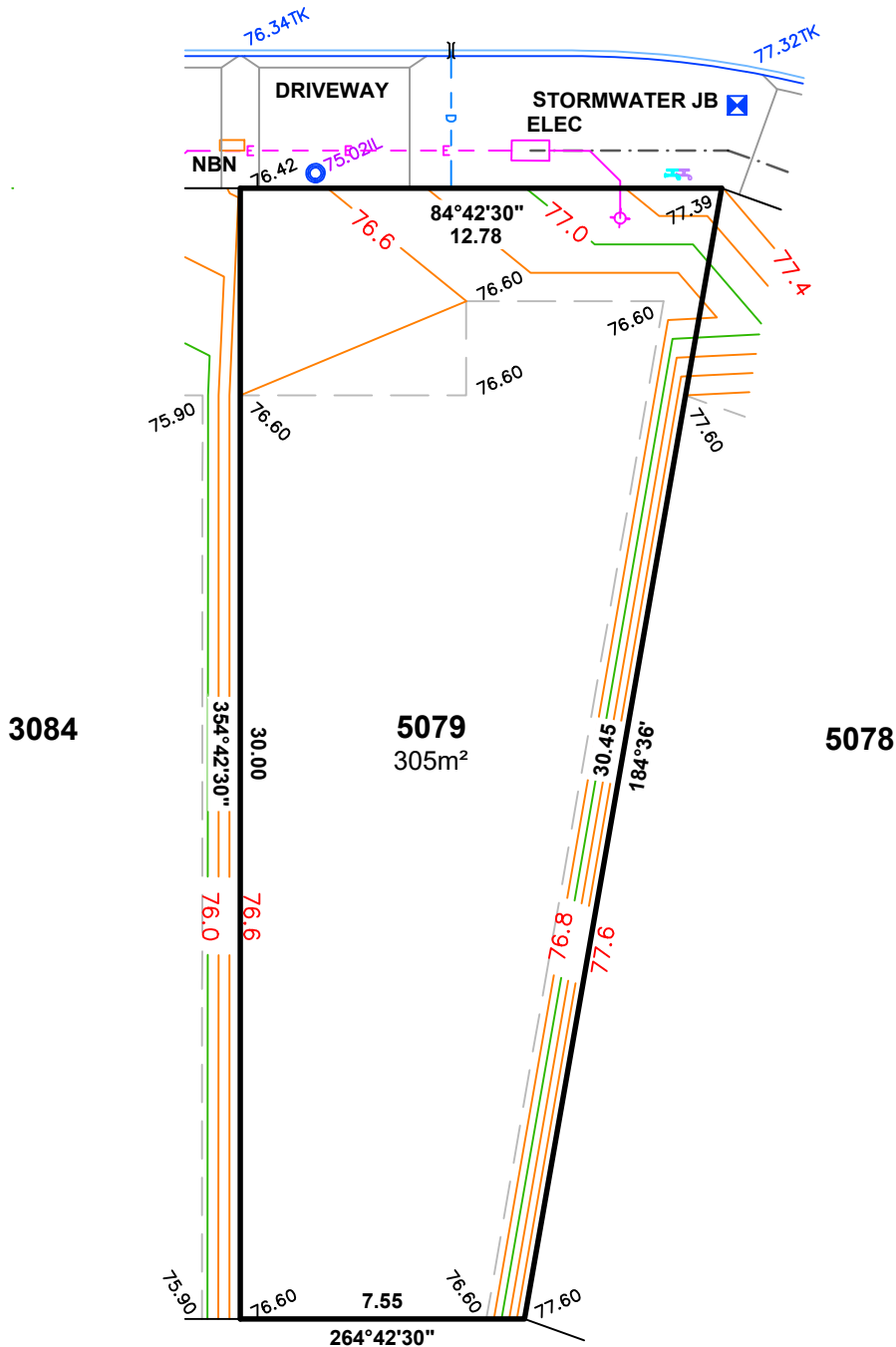

LEGEND

- SIGN
- ELECTRICAL LEAD IN
- SAPN CONNECTION
- LIGHT POLE
- NBN / TELSTRA PIT
- STORMWATER GRATE
- STORMWATER MANHOLE / JB
- STORMWATER CONNECTION
- SIDE ENTRY PIT (SEP)
- DOMESTIC OUTLET (STORMWATER)
- SEWER IO
- SEWER MANHOLE
- SEWER IP
- POTABLE WATER CONNECTION
- RECLAIMED WATER CONNECTION
- FOOTPATH
- COMMON SERVICE TRENCH
- BUILDING BENCH PADS



ALEXANDER SYMONDS
 PH 8130 1666

1:200

DISCLAIMER: DATA SHOWN HEREON IS DESIGN INFORMATION AND SHOULD BE CONFIRMED
 ORIGINAL SHEET SIZE A4