



Acacia 2 contour plans

 **AlmondGrove**
MUNNO PARA



ALLOTMENT 779 in DEV. NO. 292/D066/2012
in the area named
ALMOND GROVE
CT ---/---

PRELIMINARY

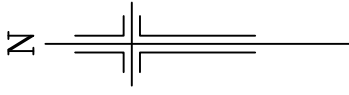

LEGEND

DW	DRIVEWAY
	ELEC LEAD IN
	WATER METER
	SEWER IP
	STOBIE POLE
	TELSTRA PIT
	S/W GRATING
	SEWER MAN HOLE
	S/W MANHOLE
	LIGHT POLE
	ETSA CONNECTION
	BOLLARD
	SIGN
	S/W CONNECTION
	FOOTPATH
	SIDE ENTRY PIT
	COMMON SERVICE TRENCH
	DOMESTIC
	SEWER IO
	NON-POTABLE WATER CONN

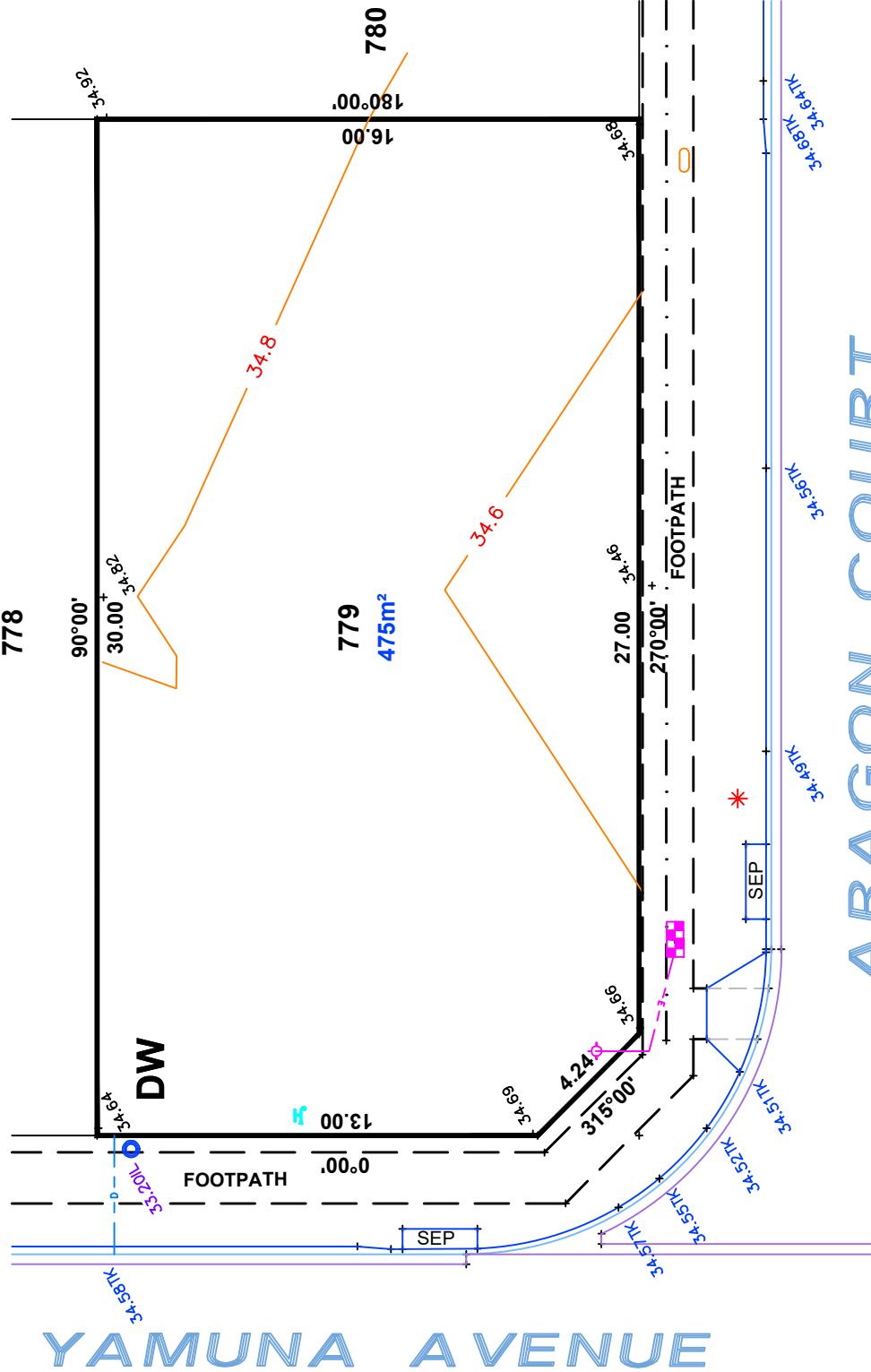

ARAGON COURT

YAMUNA AVENUE



DISCLAIMER: DATA SHOWN HEREON IS DESIGN INFORMATION AND SHOULD BE CONFIRMED ORIGINAL SHEET SIZE A4

IMPORTANT
SERVICE AND DRIVEWAY LOCATIONS ARE APPROXIMATE. ANY CHANGES WILL BE AT THE PURCHASERS EXPENSE.
PURCHASER: _____
PURCHASER: _____
DATE: _____

NOTE:
DRIVEWAY IN PAVERS BY DEVELOPER

ALEXANDER SYMONDS
PH 8130 1666

ALLOTMENT 780 in DEV. NO. 292/D066/2012
 in the area named
ALMOND GROVE
 CT ---/----

IMPORTANT
 SERVICE AND DRIVEWAY LOCATIONS
 ARE APPROXIMATE. ANY CHANGES WILL
 BE AT THE PURCHASERS EXPENSE.
 PURCHASER: _____
 PURCHASER: _____
 DATE: _____

DISCLAIMER:

Please note that this site plan is intended for
 visual purposes only, additional survey work will
 be required prior to commencing any design or
 construction on the site.

PRELIMINARY

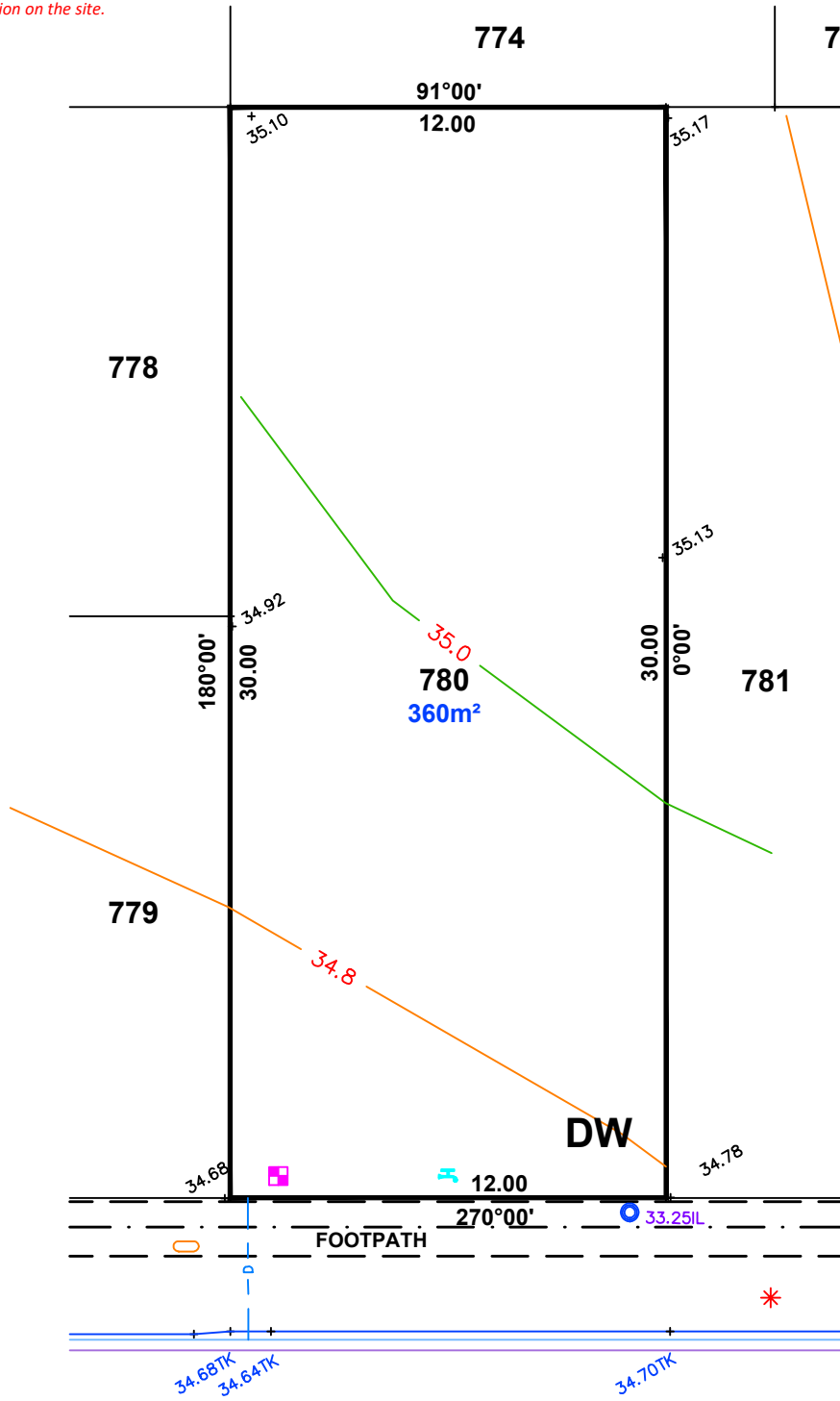
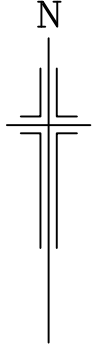

ARAGON COURT

LEGEND

- DW DRIVEWAY
- ◆ ELEC LEAD IN
- WATER METER
- SEWER IP
- ▬ STOBIE POLE
- TELSTRA PIT
- ▬ S/W GRATING
- SEWER MAN HOLE
- ▬ S/W MANHOLE
- * LIGHT POLE
- E.T.S.A CONNECTION
- BOLLARD
- ♀ SIGN
- S/W CONNECTION
- FOOTPATH
- ▬ SIDE ENTRY PIT
- COMMON SERVICE TRENCH
- - - DOMESTIC
- SEWER IO
- ▽ NON-POTABLE WATER CONN

NOTE:
 DRIVEWAY IN PAVERS
 BY DEVELOPER



1:200

ALEXANDER SYMONDS
 PH 8130 1666

DISCLAIMER: DATA SHOWN HEREON IS DESIGN INFORMATION AND SHOULD BE CONFIRMED
 ORIGINAL SHEET SIZE A4

ALLOTMENT 781 in DEV. NO. 292/D066/2012

in the area named
ALMOND GROVE

CT ---/----

PRELIMINARY

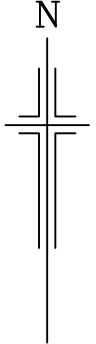

IMPORTANT
SERVICE AND DRIVEWAY LOCATIONS
ARE APPROXIMATE. ANY CHANGES WILL
BE AT THE PURCHASERS EXPENSE.
PURCHASER: _____
PURCHASER: _____
DATE: _____

DISCLAIMER:

Please note that this site plan is intended for
visual purposes only, additional survey work will
be required prior to commencing any design or
construction on the site.

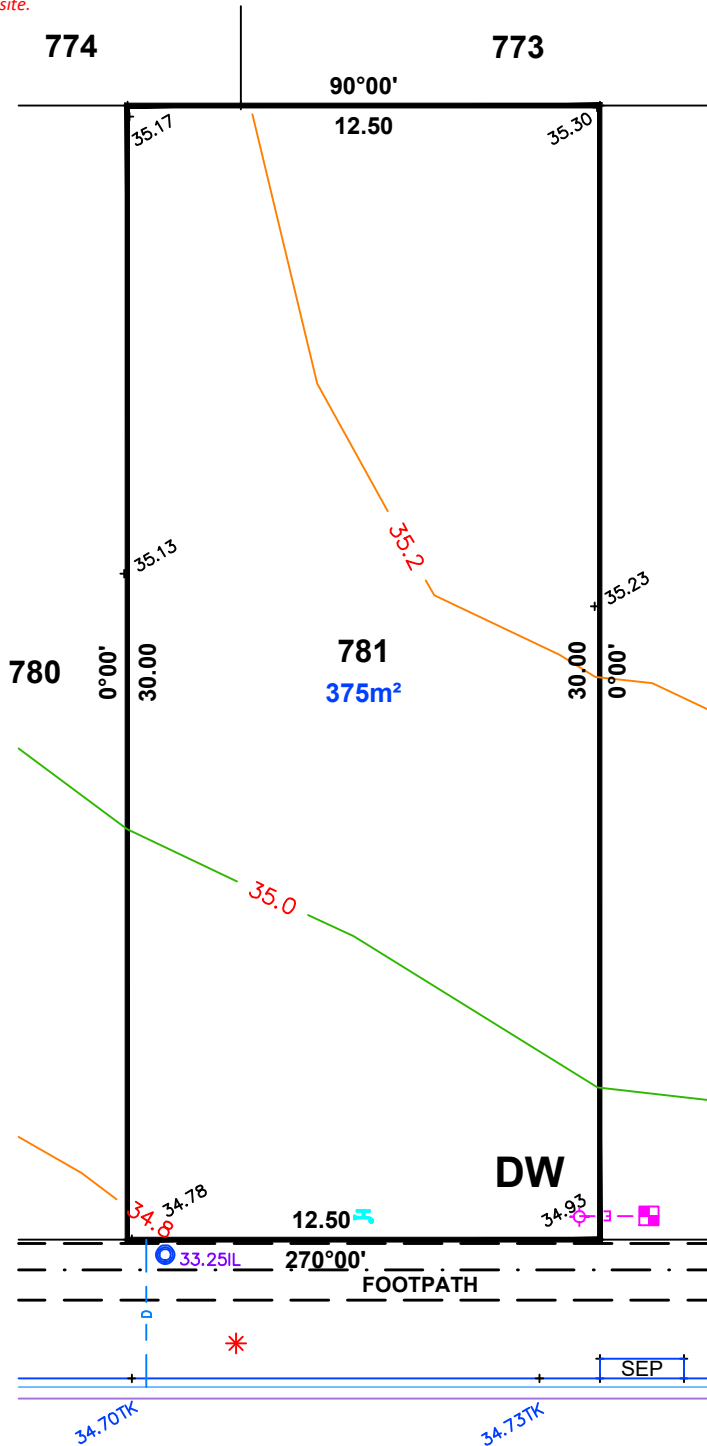

LEGEND

- DW DRIVEWAY
- ◆ ELEC LEAD IN
- WATER METER
- SEWER IP
- ▬ STOBIE POLE
- TELSTRA PIT
- ▬ S/W GRATING
- SEWER MAN HOLE
- ▬ S/W MANHOLE
- * LIGHT POLE
- ▬ ETSA CONNECTION
- BOLLARD
- ♀ SIGN
- S/W CONNECTION
- ▬ FOOTPATH
- ▬ SIDE ENTRY PIT
- ▬ COMMON SERVICE TRENCH
- - - DOMESTIC
- SEWER IO
- ▽ NON-POTABLE WATER CONN

NOTE:
DRIVEWAY IN PAVERS
BY DEVELOPER



1:200

ALEXANDER SYMONDS
PH 8130 1666

DISCLAIMER: DATA SHOWN HEREON IS DESIGN INFORMATION AND SHOULD BE CONFIRMED
ORIGINAL SHEET SIZE A4

ALLOTMENT 782 in DEV. NO. 292/D066/2012

in the area named
ALMOND GROVE

CT ---/----

PRELIMINARY

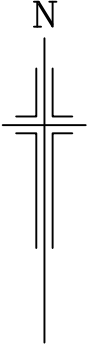

IMPORTANT
SERVICE AND DRIVEWAY LOCATIONS
ARE APPROXIMATE. ANY CHANGES WILL
BE AT THE PURCHASERS EXPENSE.
PURCHASER: _____
PURCHASER: _____
DATE: _____

DISCLAIMER:

Please note that this site plan is intended for
visual purposes only, additional survey work will
be required prior to commencing any design or
construction on the site.

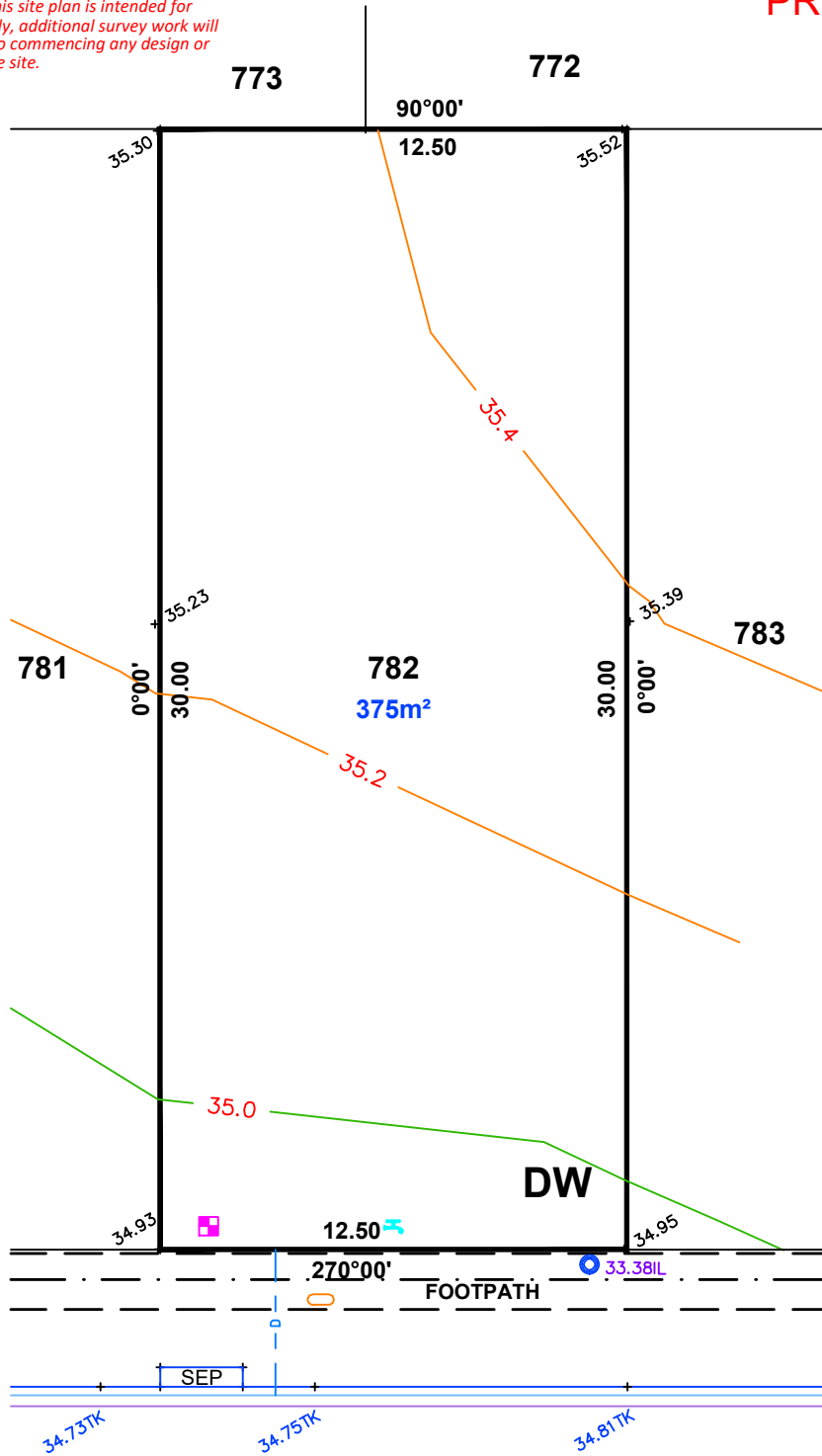

LEGEND

- DW DRIVEWAY
- ◆ ELEC LEAD IN
- WATER METER
- SEWER IP
- ▬ STOBIE POLE
- TELSTRA PIT
- ▬ S/W GRATING
- SEWER MAN HOLE
- ▬ S/W MANHOLE
- * LIGHT POLE
- E.T.S.A CONNECTION
- BOLLARD
- ♀ SIGN
- S/W CONNECTION
- ▬ FOOTPATH
- ▬ SIDE ENTRY PIT
- ▬ COMMON SERVICE TRENCH
- ▬ DOMESTIC
- SEWER IO
- ▽ NON-POTABLE WATER CONN

ARAGON COURT

NOTE:
DRIVEWAY IN PAVERS
BY DEVELOPER



1:200

ALEXANDER SYMONDS
PH 8130 1666

DISCLAIMER: DATA SHOWN HEREON IS DESIGN INFORMATION AND SHOULD BE CONFIRMED
ORIGINAL SHEET SIZE A4

ALLOTMENT 783 in DEV. NO. 292/D066/2012
 in the area named
ALMOND GROVE
 CT ---/----

IMPORTANT
 SERVICE AND DRIVEWAY LOCATIONS
 ARE APPROXIMATE. ANY CHANGES WILL
 BE AT THE PURCHASERS EXPENSE.
 PURCHASER: _____
 PURCHASER: _____
 DATE: _____

DISCLAIMER:

Please note that this site plan is intended for
 visual purposes only, additional survey work will
 be required prior to commencing any design or
 construction on the site.

PRELIMINARY

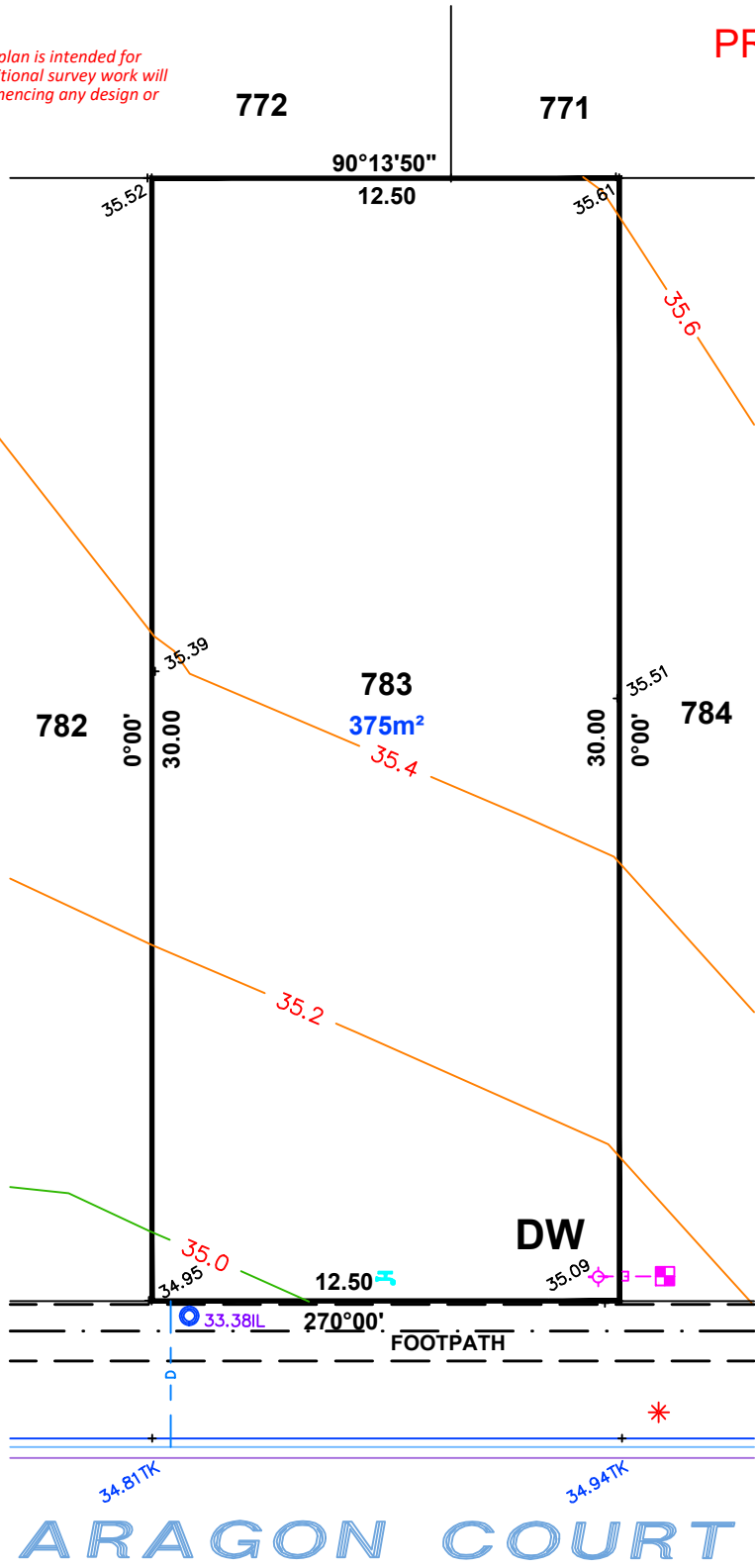
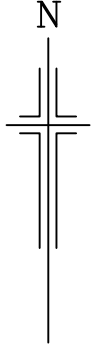

LEGEND

- DW DRIVEWAY
- ◆ ELEC LEAD IN
- WATER METER
- SEWER IP
- ▬ STOBIE POLE
- TELSTRA PIT
- ▬ S/W GRATING
- SEWER MAN HOLE
- ⊠ S/W MANHOLE
- * LIGHT POLE
- E.T.S.A CONNECTION
- BOLLARD
- ♀ SIGN
- S/W CONNECTION
- - - FOOTPATH
- ▭ SIDE ENTRY PIT
- . - COMMON SERVICE TRENCH
- - - DOMESTIC
- SEWER IO
- ▽ NON-POTABLE WATER CONN

NOTE:
 DRIVEWAY IN PAVERS
 BY DEVELOPER



1:200

ALEXANDER SYMONDS
 PH 8130 1666

DISCLAIMER: DATA SHOWN HEREON IS DESIGN INFORMATION AND SHOULD BE CONFIRMED
 ORIGINAL SHEET SIZE A4

ALLOTMENT 784 in DEV. NO. 292/D066/2012
 in the area named
ALMOND GROVE
 CT ---/----

IMPORTANT
 SERVICE AND DRIVEWAY LOCATIONS
 ARE APPROXIMATE. ANY CHANGES WILL
 BE AT THE PURCHASERS EXPENSE.
 PURCHASER: _____
 PURCHASER: _____
 DATE: _____

DISCLAIMER:

Please note that this site plan is intended for
 visual purposes only, additional survey work will
 be required prior to commencing any design or
 construction on the site.

PRELIMINARY

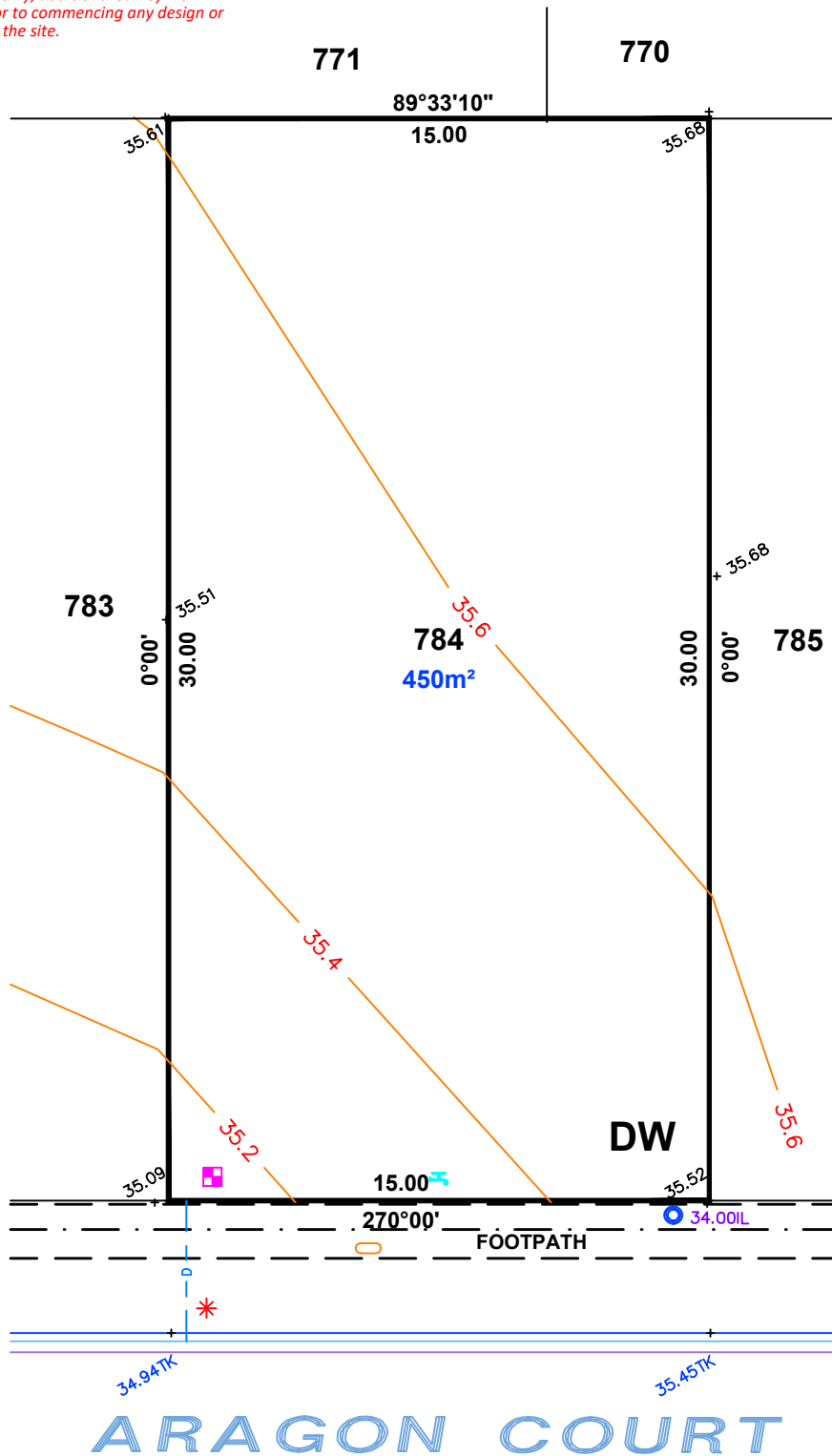
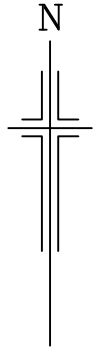

LEGEND

- DW DRIVEWAY
- ◆ ELEC LEAD IN
- WATER METER
- SEWER IP
- ▤ STOBIE POLE
- TELSTRA PIT
- ▨ S/W GRATING
- SEWER MAN HOLE
- ▣ S/W MANHOLE
- * LIGHT POLE
- E.T.S.A CONNECTION
- BOLLARD
- ♀ SIGN
- S/W CONNECTION
- FOOTPATH
- ▭ SIDE ENTRY PIT
- . - COMMON SERVICE TRENCH
- - - DOMESTIC
- SEWER IO
- ▽ NON-POTABLE WATER CONN

NOTE:
 DRIVEWAY IN PAVERS
 BY DEVELOPER



1:200

ALEXANDER SYMONDS
 PH 8130 1666

DISCLAIMER: DATA SHOWN HEREON IS DESIGN INFORMATION AND SHOULD BE CONFIRMED
 ORIGINAL SHEET SIZE A4

ALLOTMENT 785 in DEV. NO. 292/D066/2012
 in the area named
ALMOND GROVE
 CT ---/----

PRELIMINARY

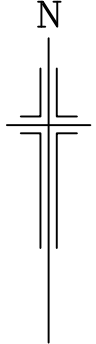

IMPORTANT
 SERVICE AND DRIVEWAY LOCATIONS
 ARE APPROXIMATE. ANY CHANGES WILL
 BE AT THE PURCHASERS EXPENSE.
 PURCHASER: _____
 PURCHASER: _____
 DATE: _____

DISCLAIMER:

Please note that this site plan is intended for
 visual purposes only, additional survey work will
 be required prior to commencing any design or
 construction on the site.

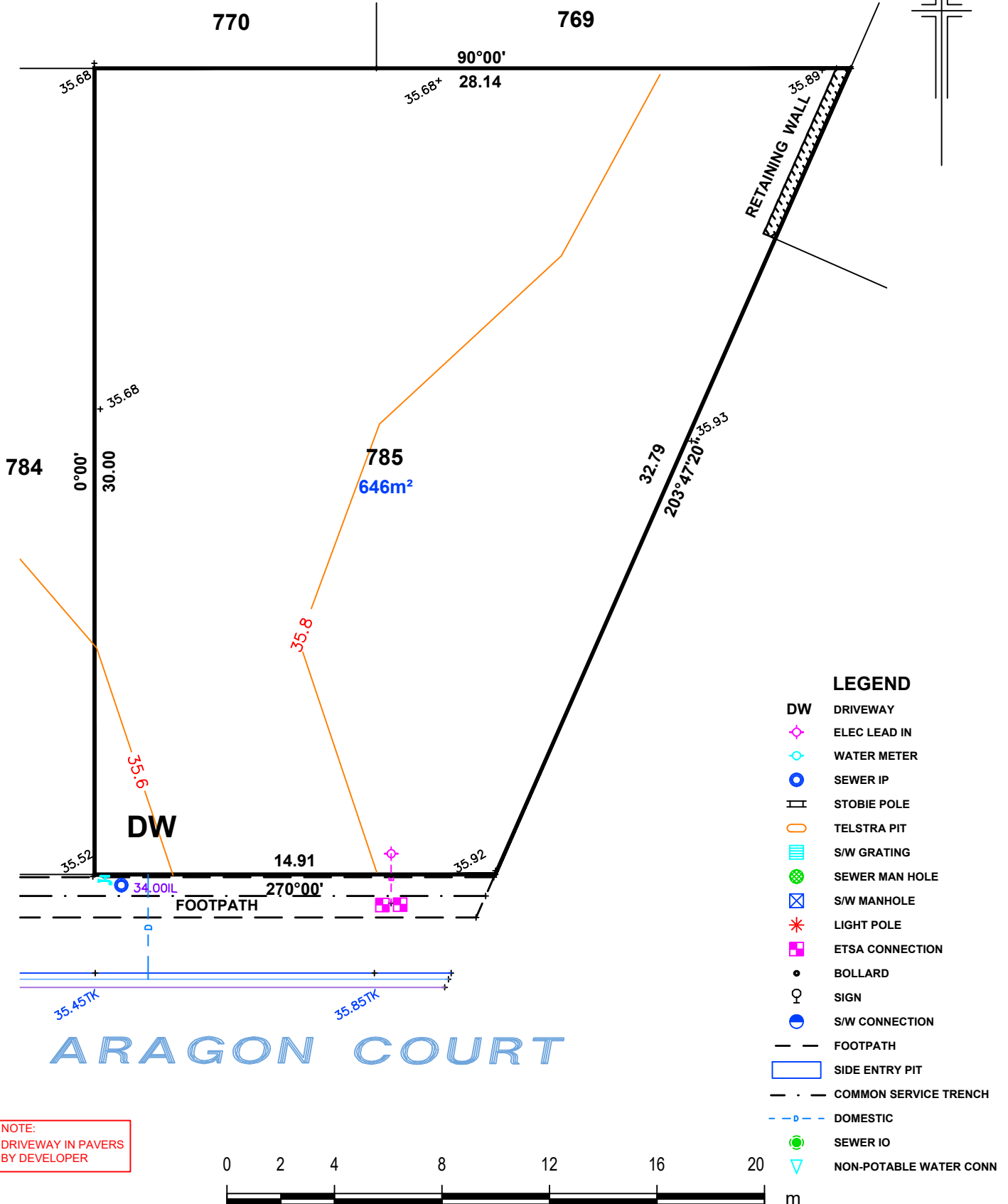

NOTE:
 DRIVEWAY IN PAVERS
 BY DEVELOPER

ALEXANDER SYMONDS
 PH 8130 1666

1:200

DISCLAIMER: DATA SHOWN HEREON IS DESIGN INFORMATION AND SHOULD BE CONFIRMED
 ORIGINAL SHEET SIZE A4

ALLOTMENT 786 in DEV. NO. 292/D066/2012

in the area named
ALMOND GROVE

CT ---/----

PRELIMINARY

ARAGON COURT

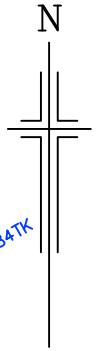

IMPORTANT
SERVICE AND DRIVEWAY LOCATIONS
ARE APPROXIMATE. ANY CHANGES WILL
BE AT THE PURCHASERS EXPENSE.
PURCHASER: _____
PURCHASER: _____
DATE: _____

DISCLAIMER:

Please note that this site plan is intended for
visual purposes only, additional survey work will
be required prior to commencing any design or
construction on the site.

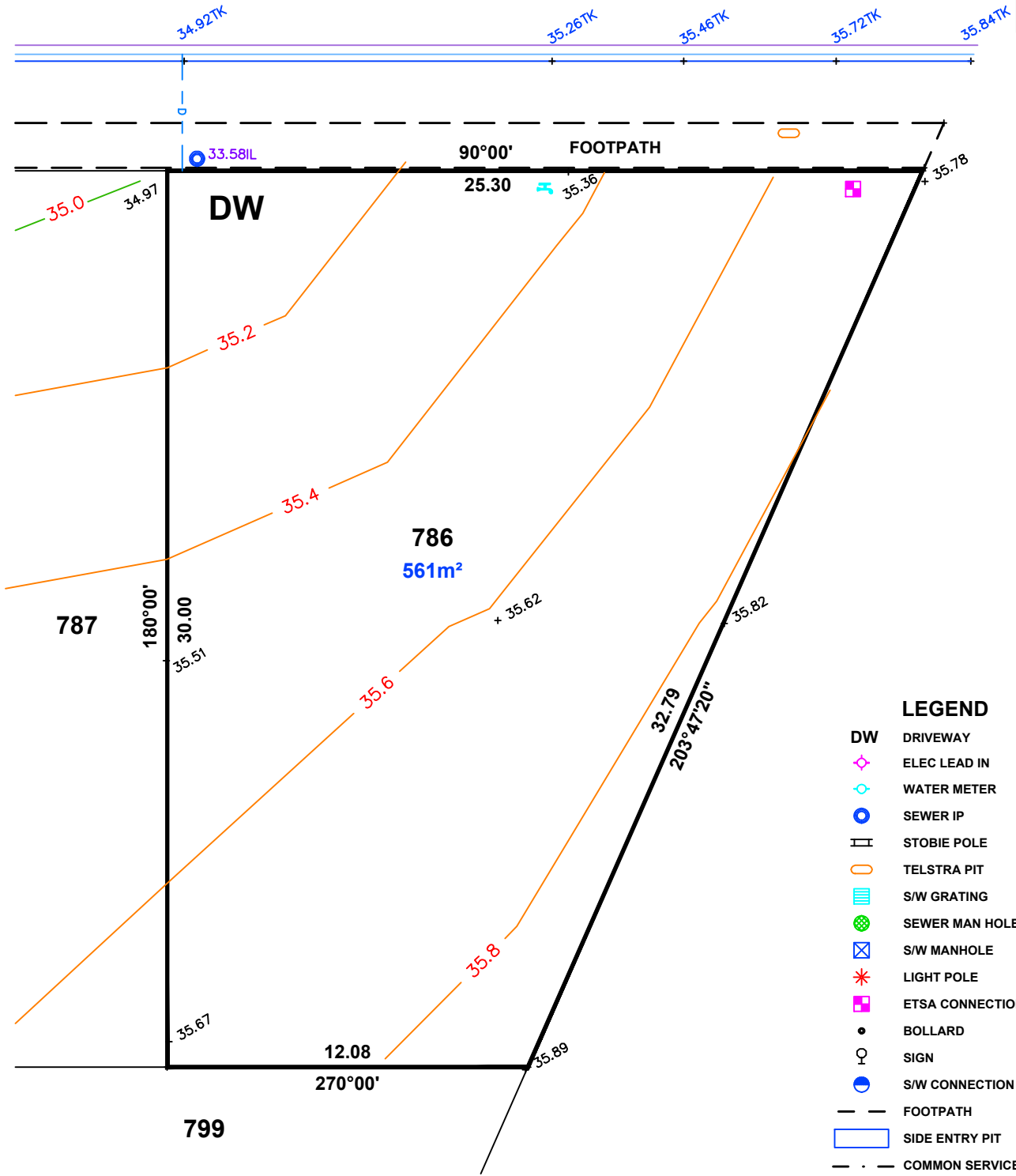

LEGEND

- DW DRIVEWAY
- ◆ ELEC LEAD IN
- WATER METER
- SEWER IP
- ▬ STOBIE POLE
- TELSTRA PIT
- ▬ S/W GRATING
- SEWER MAN HOLE
- ▬ S/W MANHOLE
- * LIGHT POLE
- E.T.S.A CONNECTION
- BOLLARD
- ♀ SIGN
- S/W CONNECTION
- - - FOOTPATH
- ▭ SIDE ENTRY PIT
- . - COMMON SERVICE TRENCH
- - - DOMESTIC
- SEWER IO
- ▽ NON-POTABLE WATER CONN

NOTE:
DRIVEWAY IN PAVERS
BY DEVELOPER



ALEXANDER SYMONDS
PH 8130 1666

1:200

DISCLAIMER: DATA SHOWN HEREON IS DESIGN INFORMATION AND SHOULD BE CONFIRMED
ORIGINAL SHEET SIZE A4

ALLOTMENT 787 in DEV. NO. 292/D066/2012

in the area named
ALMOND GROVE

CT ---/----

PRELIMINARY

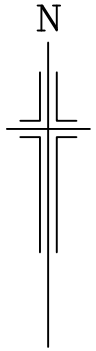

IMPORTANT
SERVICE AND DRIVEWAY LOCATIONS
ARE APPROXIMATE. ANY CHANGES WILL
BE AT THE PURCHASERS EXPENSE.
PURCHASER: _____
PURCHASER: _____
DATE: _____

DISCLAIMER:

Please note that this site plan is intended for
visual purposes only, additional survey work will
be required prior to commencing any design or
construction on the site.

ARAGON COURT

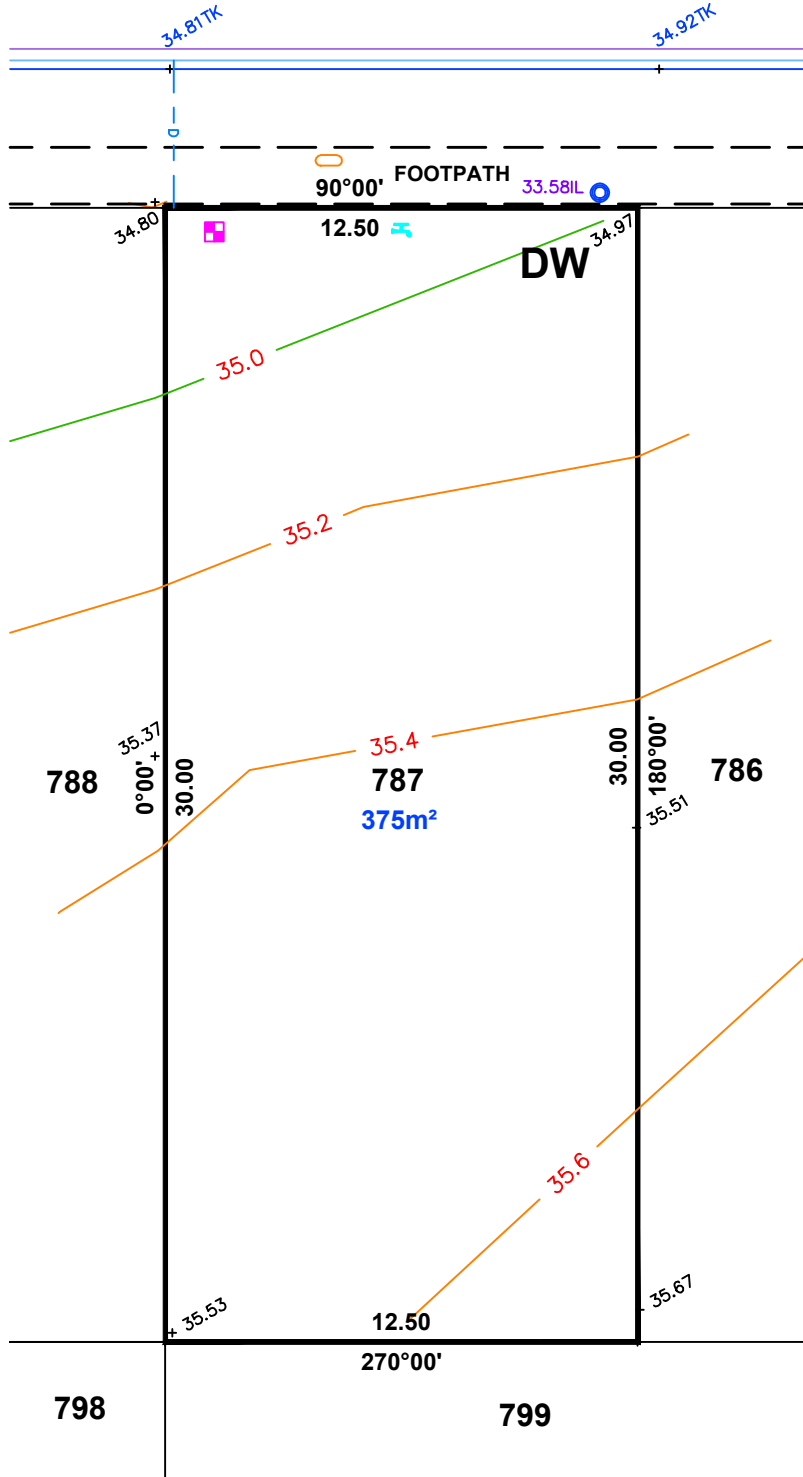

LEGEND

- DW DRIVEWAY
- ◆ ELEC LEAD IN
- WATER METER
- SEWER IP
- ▬ STOBIE POLE
- TELSTRA PIT
- ▬ S/W GRATING
- SEWER MAN HOLE
- ▬ S/W MANHOLE
- * LIGHT POLE
- E.T.S.A CONNECTION
- BOLLARD
- ♀ SIGN
- S/W CONNECTION
- FOOTPATH
- ▬ SIDE ENTRY PIT
- . - COMMON SERVICE TRENCH
- - - DOMESTIC
- SEWER IO
- ▽ NON-POTABLE WATER CONN

NOTE:
DRIVEWAY IN PAVERS
BY DEVELOPER



1:200

ALEXANDER SYMONDS
PH 8130 1666

DISCLAIMER: DATA SHOWN HEREON IS DESIGN INFORMATION AND SHOULD BE CONFIRMED
ORIGINAL SHEET SIZE A4

ALLOTMENT 788 in DEV. NO. 292/D066/2012

**in the area named
ALMOND GROVE**

CT ---/----

PRELIMINARY

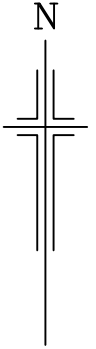

IMPORTANT
SERVICE AND DRIVEWAY LOCATIONS
ARE APPROXIMATE. ANY CHANGES WILL
BE AT THE PURCHASERS EXPENSE.
PURCHASER: _____
PURCHASER: _____
DATE: _____

DISCLAIMER:

Please note that this site plan is intended for
visual purposes only, additional survey work will
be required prior to commencing any design or
construction on the site.

ARAGON COURT

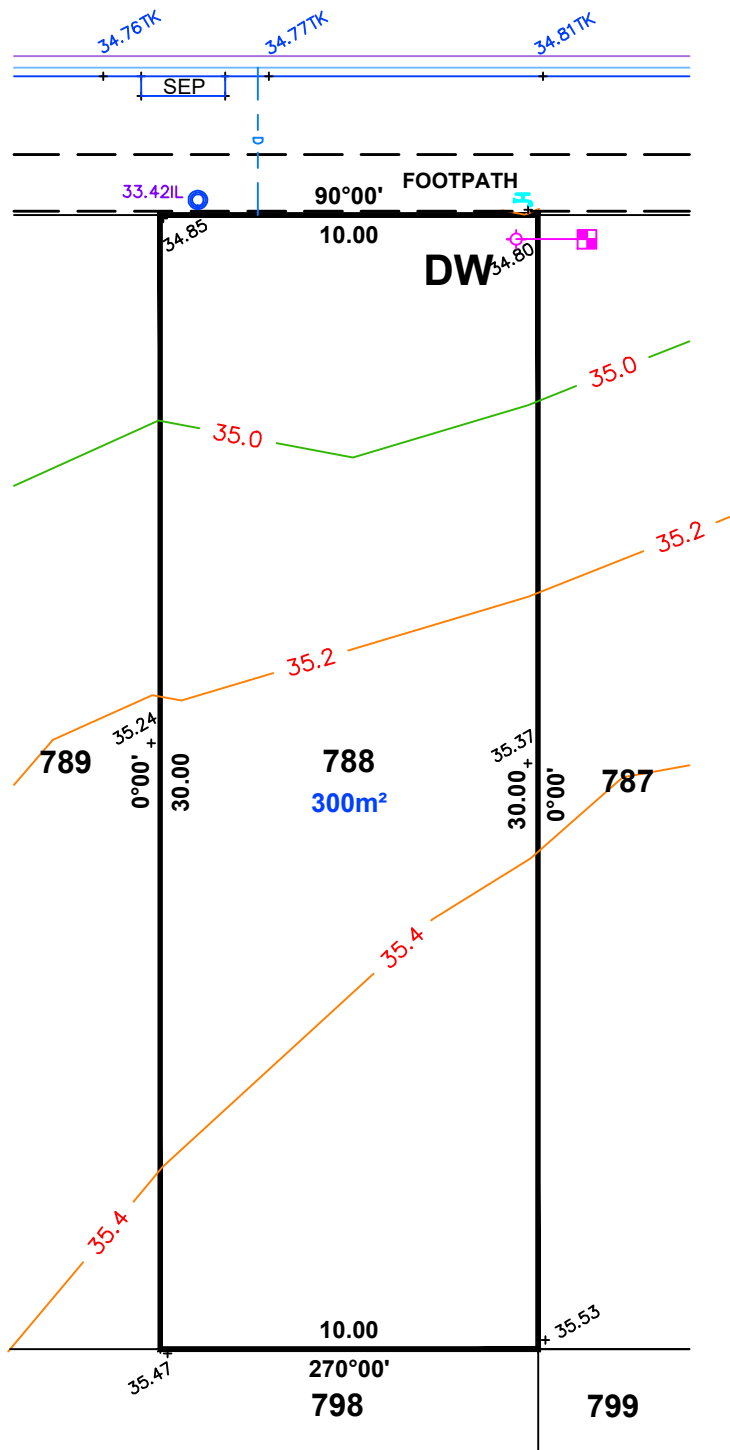

LEGEND

- DW DRIVEWAY
- ◆ ELEC LEAD IN
- WATER METER
- SEWER IP
- ▬ STOBIE POLE
- TELSTRA PIT
- ▬ S/W GRATING
- SEWER MAN HOLE
- ▬ S/W MANHOLE
- * LIGHT POLE
- E.T.S.A CONNECTION
- BOLLARD
- ♀ SIGN
- S/W CONNECTION
- FOOTPATH
- ▭ SIDE ENTRY PIT
- . - COMMON SERVICE TRENCH
- - - DOMESTIC
- SEWER IO
- ▽ NON-POTABLE WATER CONN

NOTE:
DRIVEWAY IN PAVERS
BY DEVELOPER



ALEXANDER SYMONDS
PH 8130 1666

1:200

DISCLAIMER: DATA SHOWN HEREON IS DESIGN INFORMATION AND SHOULD BE CONFIRMED
ORIGINAL SHEET SIZE A4

ALLOTMENT 789 in DEV. NO. 292/D066/2012

in the area named
ALMOND GROVE

CT ---/----

PRELIMINARY

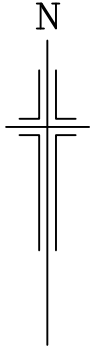

IMPORTANT
SERVICE AND DRIVEWAY LOCATIONS
ARE APPROXIMATE. ANY CHANGES WILL
BE AT THE PURCHASERS EXPENSE.
PURCHASER: _____
PURCHASER: _____
DATE: _____

DISCLAIMER:

Please note that this site plan is intended for
visual purposes only, additional survey work will
be required prior to commencing any design or
construction on the site.

ARAGON COURT

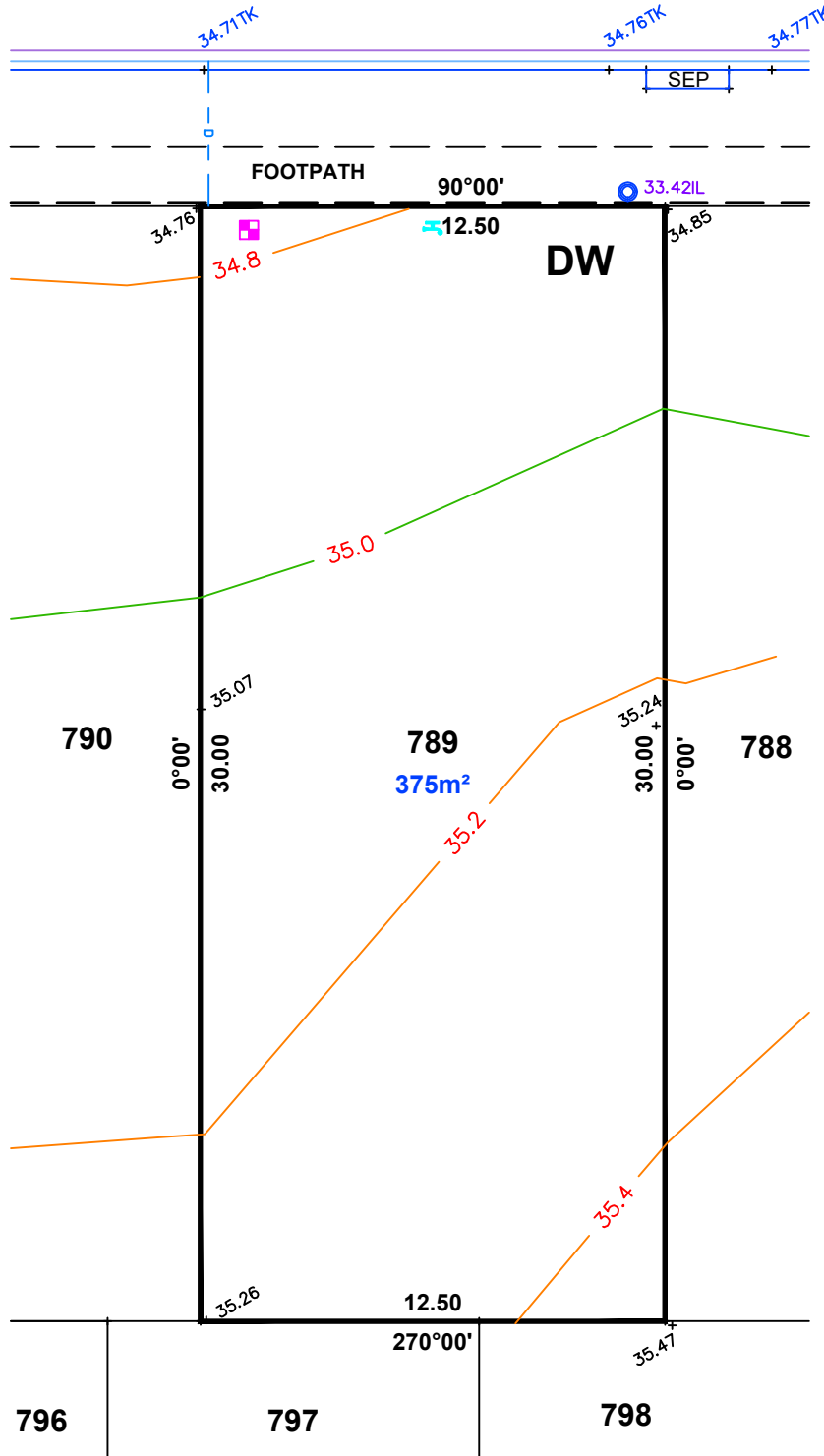

LEGEND

- DW DRIVEWAY
- ◊ ELEC LEAD IN
- WATER METER
- SEWER IP
- ▤ STOBIE POLE
- TELSTRA PIT
- ▨ S/W GRATING
- SEWER MAN HOLE
- ▣ S/W MANHOLE
- * LIGHT POLE
- ◻ E.T.S.A CONNECTION
- BOLLARD
- ♀ SIGN
- S/W CONNECTION
- FOOTPATH
- ▭ SIDE ENTRY PIT
- . - COMMON SERVICE TRENCH
- - - DOMESTIC
- SEWER IO
- ▽ NON-POTABLE WATER CONN

NOTE:
DRIVEWAY IN PAVERS
BY DEVELOPER



ALEXANDER SYMONDS
PH 8130 1666

1:200

DISCLAIMER: DATA SHOWN HEREON IS DESIGN INFORMATION AND SHOULD BE CONFIRMED
ORIGINAL SHEET SIZE A4

ALLOTMENT 790 in DEV. NO. 292/D066/2012

in the area named
ALMOND GROVE

CT ---/----

PRELIMINARY

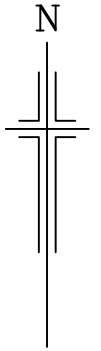

IMPORTANT
SERVICE AND DRIVEWAY LOCATIONS
ARE APPROXIMATE. ANY CHANGES WILL
BE AT THE PURCHASERS EXPENSE.
PURCHASER: _____
PURCHASER: _____
DATE: _____

DISCLAIMER:

Please note that this site plan is intended for
visual purposes only, additional survey work will
be required prior to commencing any design or
construction on the site.

ARAGON COURT

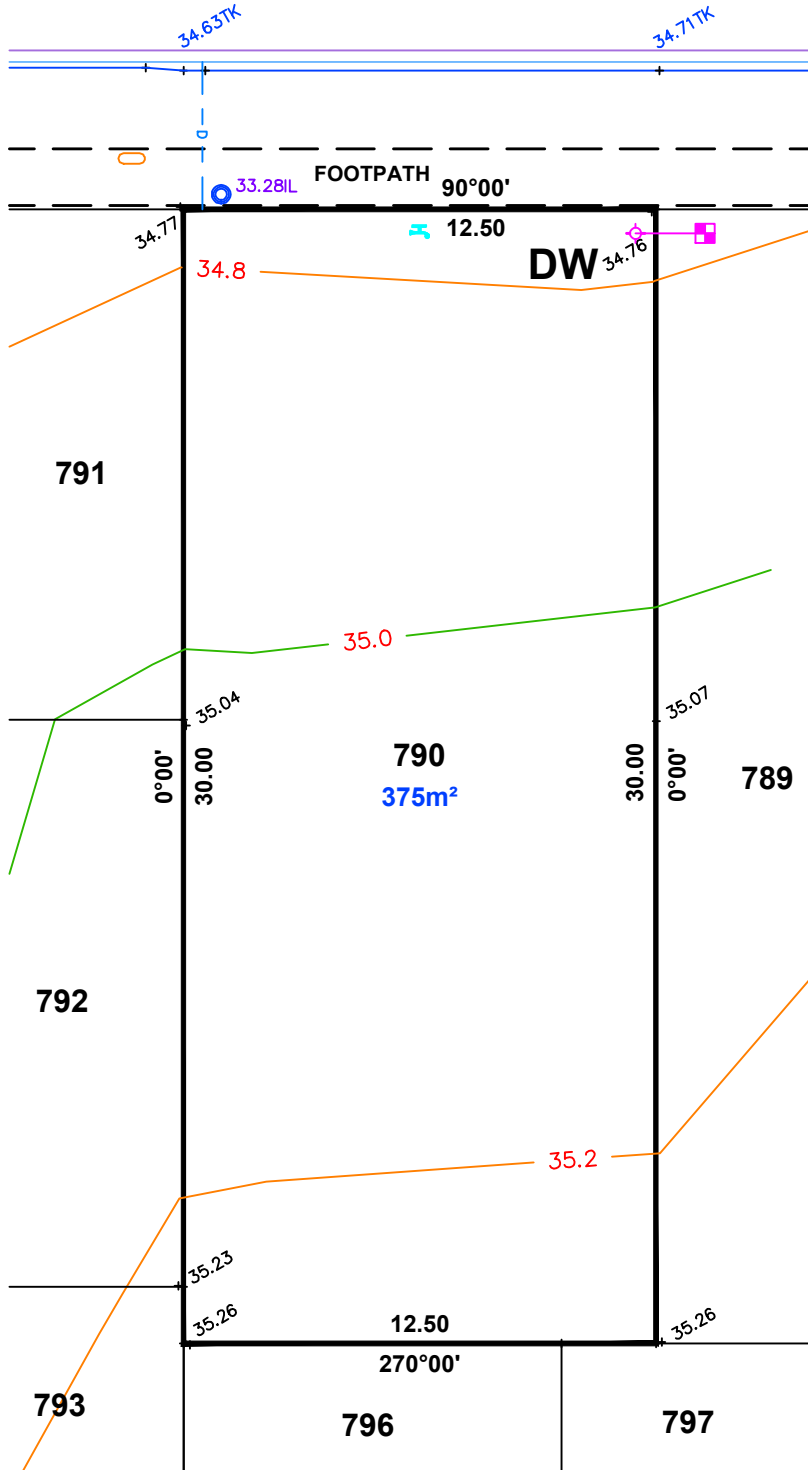

LEGEND

- DW DRIVEWAY
- ◆ ELEC LEAD IN
- WATER METER
- SEWER IP
- ▭ STOBIE POLE
- TELSTRA PIT
- ▨ S/W GRATING
- SEWER MAN HOLE
- ▣ S/W MANHOLE
- * LIGHT POLE
- E.T.S.A. CONNECTION
- BOLLARD
- ♀ SIGN
- S/W CONNECTION
- FOOTPATH
- ▭ SIDE ENTRY PIT
- . - COMMON SERVICE TRENCH
- - - DOMESTIC
- SEWER IO
- ▽ NON-POTABLE WATER CONN

NOTE:
DRIVEWAY IN PAVERS
BY DEVELOPER

ALEXANDER SYMONDS
PH 8130 1666

1:200

DISCLAIMER: DATA SHOWN HEREON IS DESIGN INFORMATION AND SHOULD BE CONFIRMED
ORIGINAL SHEET SIZE A4

ALLOTMENT 791 in DEV. NO. 292/D066/2012
in the area named
ALMOND GROVE

CT ---/---/----

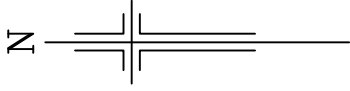

PRELIMINARY

ARAGON COURT

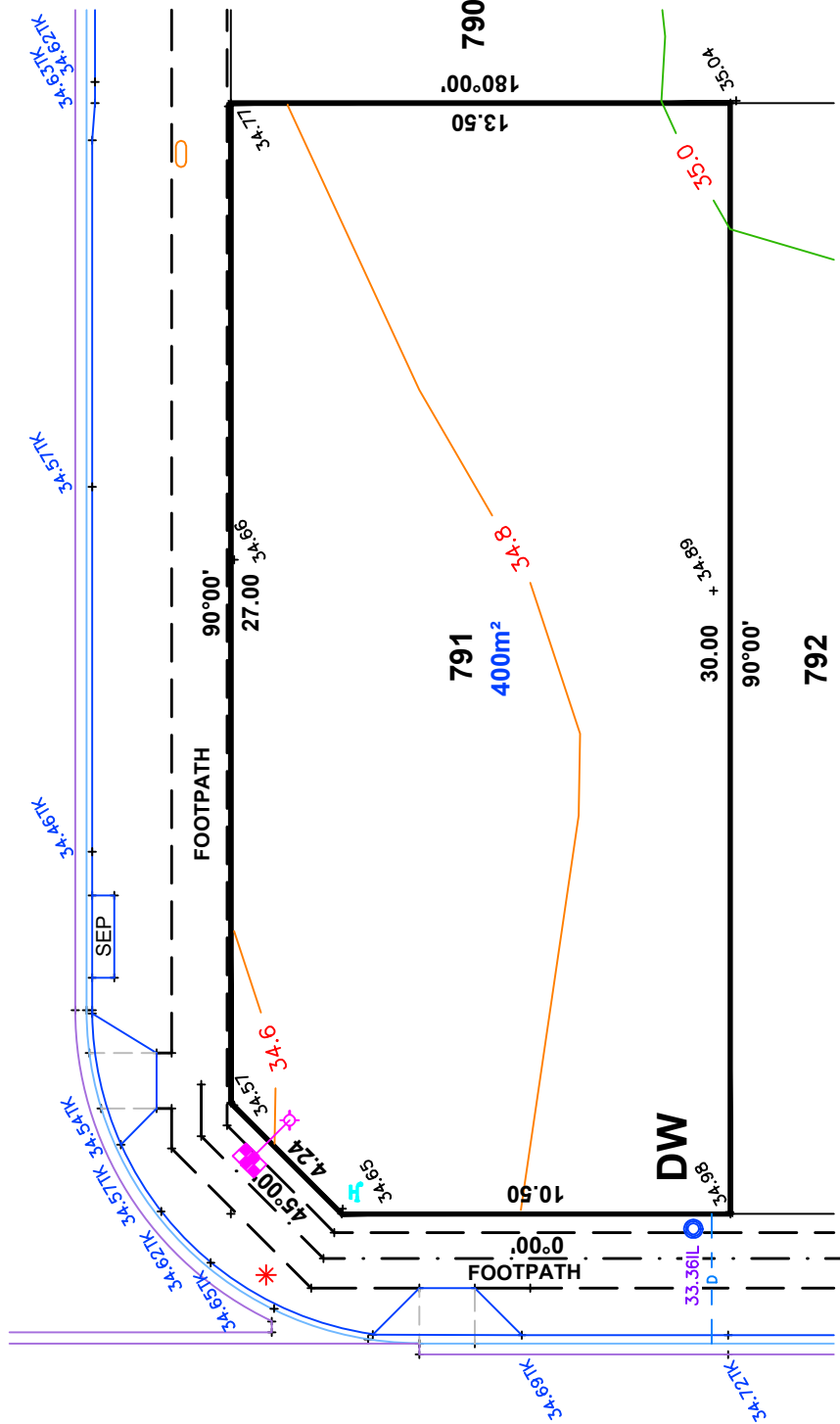

LEGEND

- DW DRIVEWAY
- ELEC LEAD IN
- WATER METER
- SEWER IP
- STOBIE POLE
- TELSTRA PIT
- S/W GRATING
- SEWER MAN HOLE
- S/W MANHOLE
- LIGHT POLE
- ETSA CONNECTION
- BOLLARD
- SIGN
- S/W CONNECTION
- FOOTPATH
- SIDE ENTRY PIT
- COMMON SERVICE TRENCH
- DOMESTIC
- SEWER IO
- NON-POTABLE WATER CONN

DISCLAIMER:

Please note that this site plan is intended for visual purposes only, additional survey work will be required prior to commencing any design or construction on the site.

IMPORTANT
SERVICE AND DRIVEWAY LOCATIONS ARE APPROXIMATE; ANY CHANGES WILL BE AT THE PURCHASERS EXPENSE.
PURCHASER: _____
PURCHASER: _____
DATE: _____

NOTE:
DRIVEWAY IN PAVERS BY DEVELOPER



ALEXANDER SYMONDS
PH 8130 1666

DISCLAIMER: DATA SHOWN HEREON IS DESIGN INFORMATION AND SHOULD BE CONFIRMED ORIGINAL SHEET SIZE A4

ALLOTMENT 792 in DEV. NO. 292/D066/2012
 in the area named
ALMOND GROVE
 CT ---/---/----

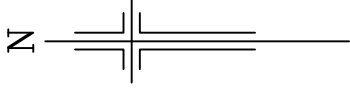

PRELIMINARY

DISCLAIMER:

Please note that this site plan is intended for visual purposes only, additional survey work will be required prior to commencing any design or construction on the site.

IMPORTANT
 SERVICE AND DRIVEWAY LOCATIONS ARE APPROXIMATE. ANY CHANGES WILL BE AT THE PURCHASERS EXPENSE.
 PURCHASER: _____
 PURCHASER: _____
 DATE: _____

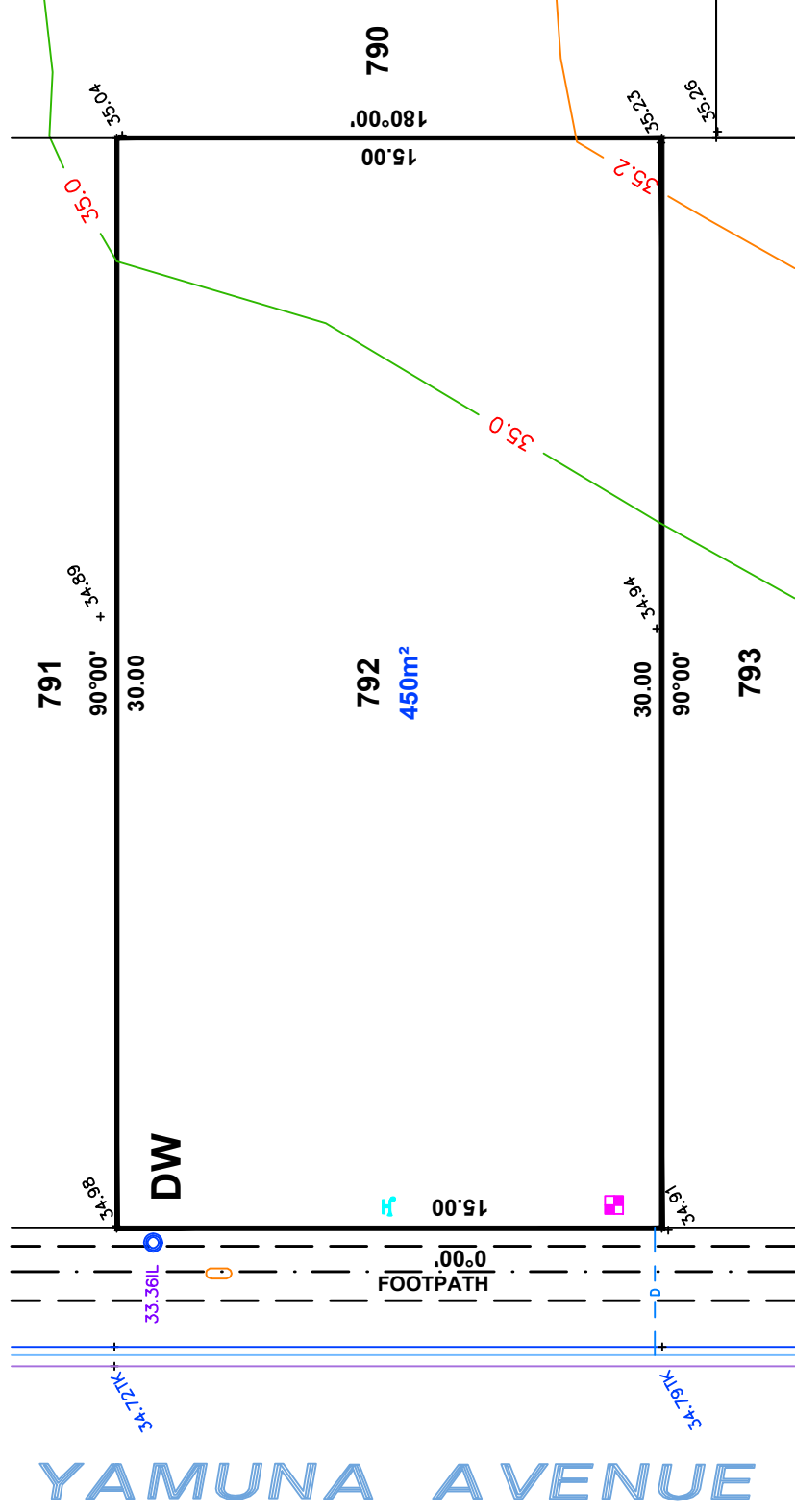

LEGEND

- DW DRIVEWAY
- ELEC LEAD IN
- WATER METER
- SEWER IP
- STOBIE POLE
- TELSTRA PIT
- S/W GRATING
- SEWER MAN HOLE
- S/W MANHOLE
- LIGHT POLE
- ETSA CONNECTION
- BOLLARD
- SIGN
- S/W CONNECTION
- FOOTPATH
- SIDE ENTRY PIT
- COMMON SERVICE TRENCH
- DOMESTIC
- SEWER IO
- NON-POTABLE WATER CONN



ALEXANDER SYMONDS
 PH 8130 1666

NOTE:
 DRIVEWAY IN PAVERS
 BY DEVELOPER

DISCLAIMER: DATA SHOWN HEREON IS DESIGN INFORMATION AND SHOULD BE CONFIRMED ORIGINAL SHEET SIZE A4

ALLOTMENT 793 in DEV. NO. 292/D066/2012
in the area named
ALMOND GROVE
CT ---/---

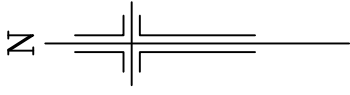

PRELIMINARY

DISCLAIMER:

Please note that this site plan is intended for visual purposes only, additional survey work will be required prior to commencing any design or construction on the site.

IMPORTANT
SERVICE AND DRIVEWAY LOCATIONS ARE APPROXIMATE. ANY CHANGES WILL BE AT THE PURCHASERS EXPENSE.
PURCHASER: _____
PURCHASER: _____
DATE: _____

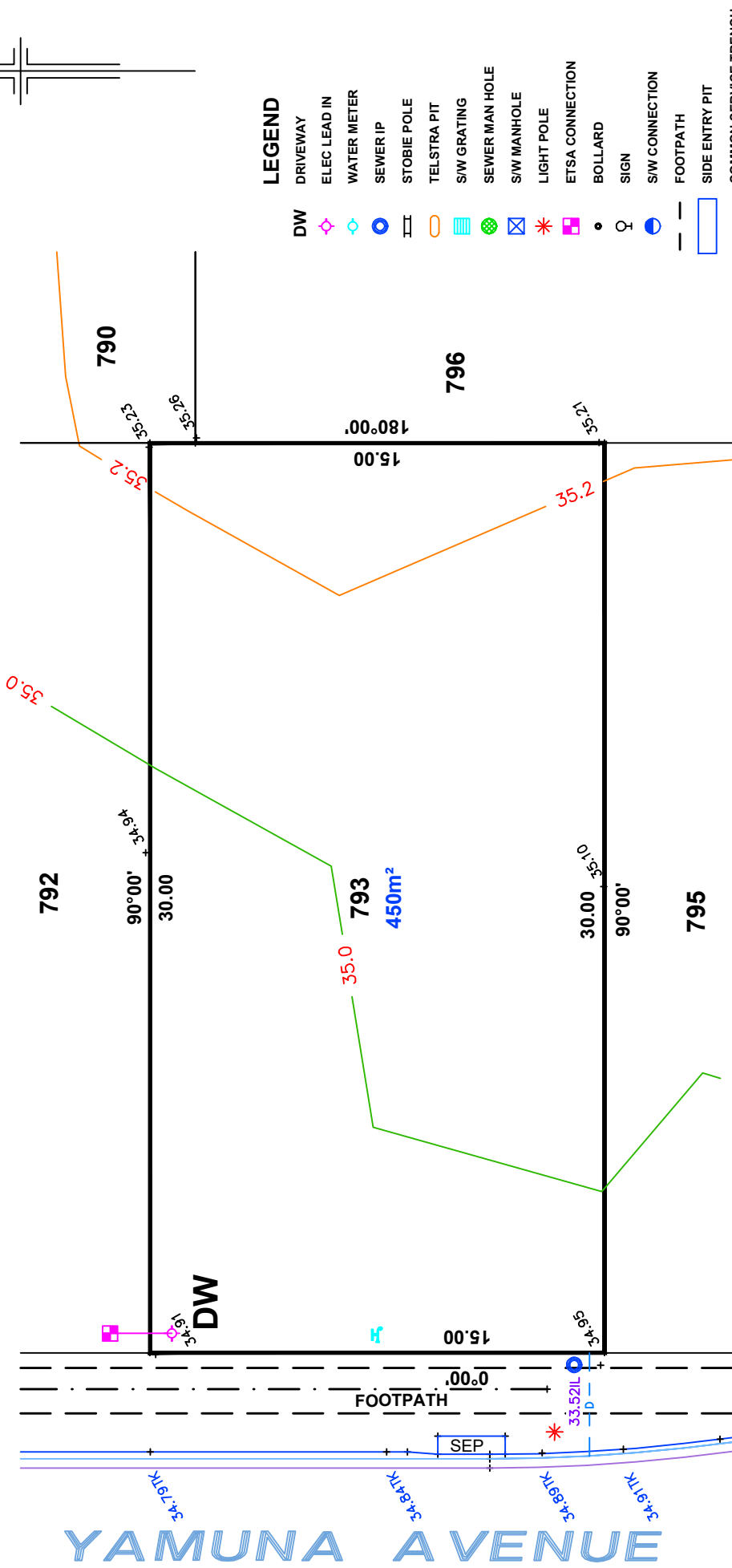

NOTE:
DRIVEWAY IN PAVERS
BY DEVELOPER



ALEXANDER SYMONDS
PH 8130 1666

DISCLAIMER: DATA SHOWN HEREON IS DESIGN INFORMATION AND SHOULD BE CONFIRMED ORIGINAL SHEET SIZE A4

ALLOTMENT 795 in DEV. NO. 292/D066/2012
in the area named
ALMOND GROVE

CT ---/---/----

PRELIMINARY

DISCLAIMER:

Please note that this site plan is intended for visual purposes only, additional survey work will be required prior to commencing any design or construction on the site.

IMPORTANT
SERVICE AND DRIVEWAY LOCATIONS ARE APPROXIMATE; ANY CHANGES WILL BE AT THE PURCHASERS EXPENSE.
PURCHASER: _____
PURCHASER: _____
DATE: _____

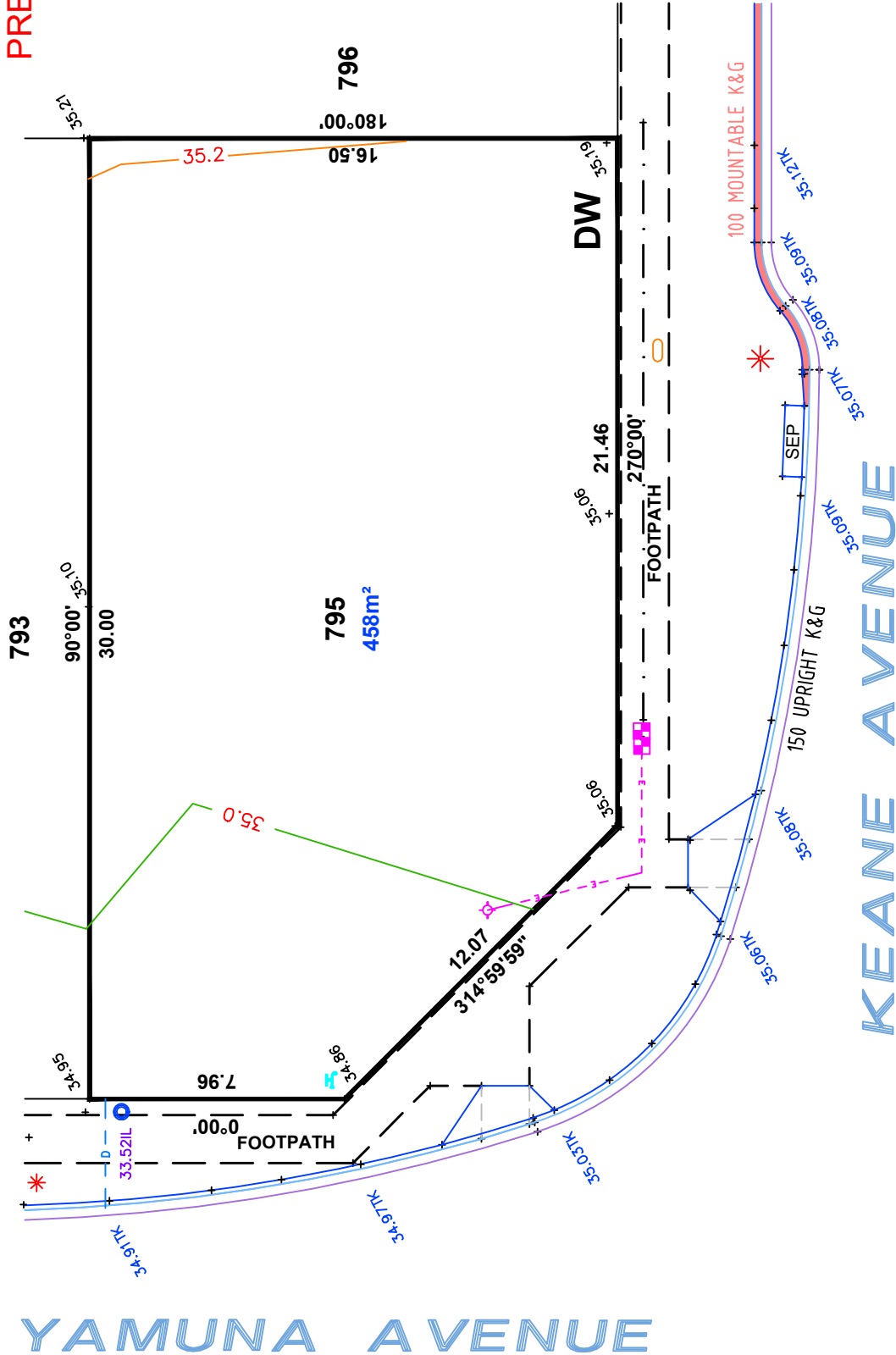
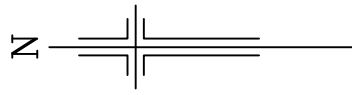

LEGEND

DW	DRIVEWAY	•	BOLLARD
◇	ELEC LEAD IN	♀	SIGN
○	WATER METER	♂	S/W CONNECTION
⊙	SEWER IP	⊙	FOOTPATH
⊖	STOBIE POLE	⊖	SIDE ENTRY PIT
⊕	TELSTRA PIT	⊕	COMMON SERVICE TRENCH
▨	S/W GRATING	⊗	DOMESTIC
⊗	SEWER MAN HOLE	⊗	SEWER IO
⊗	S/W MANHOLE	⊗	NON-POTABLE WATER CONN
⊗	LIGHT POLE	⊗	100 MOUNTABLE K&G
⊗	ETS&A CONNECTION	⊗	

ALEXANDER SYMONDS
PH 8130 1666

NOTE:
DRIVEWAY IN PAVERS
BY DEVELOPER

1:200

DISCLAIMER: DATA SHOWN HEREON IS DESIGN INFORMATION AND SHOULD BE CONFIRMED ORIGINAL SHEET SIZE A4