



Yamuna 1 contour plans

 **AlmondGrove**
MUNNO PARA



IMPORTANT
 SERVICE AND DRIVEWAY LOCATIONS
 ARE APPROXIMATE. ANY CHANGES WILL
 BE AT THE PURCHASERS EXPENSE.
 PURCHASER: _____
 PURCHASER: _____
 DATE: _____

DISCLAIMER:
 Please note that this site plan is intended for
 visual purposes only, additional survey work will
 be required prior to commencing any design or
 construction on the site.

ALLOTMENT 516 in DEV. NO. 292/D066/12/013
 in the area named
MUNNO PARA WEST
 CT ---/----

PRELIMINARY

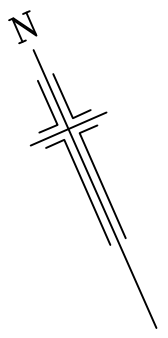

1:200

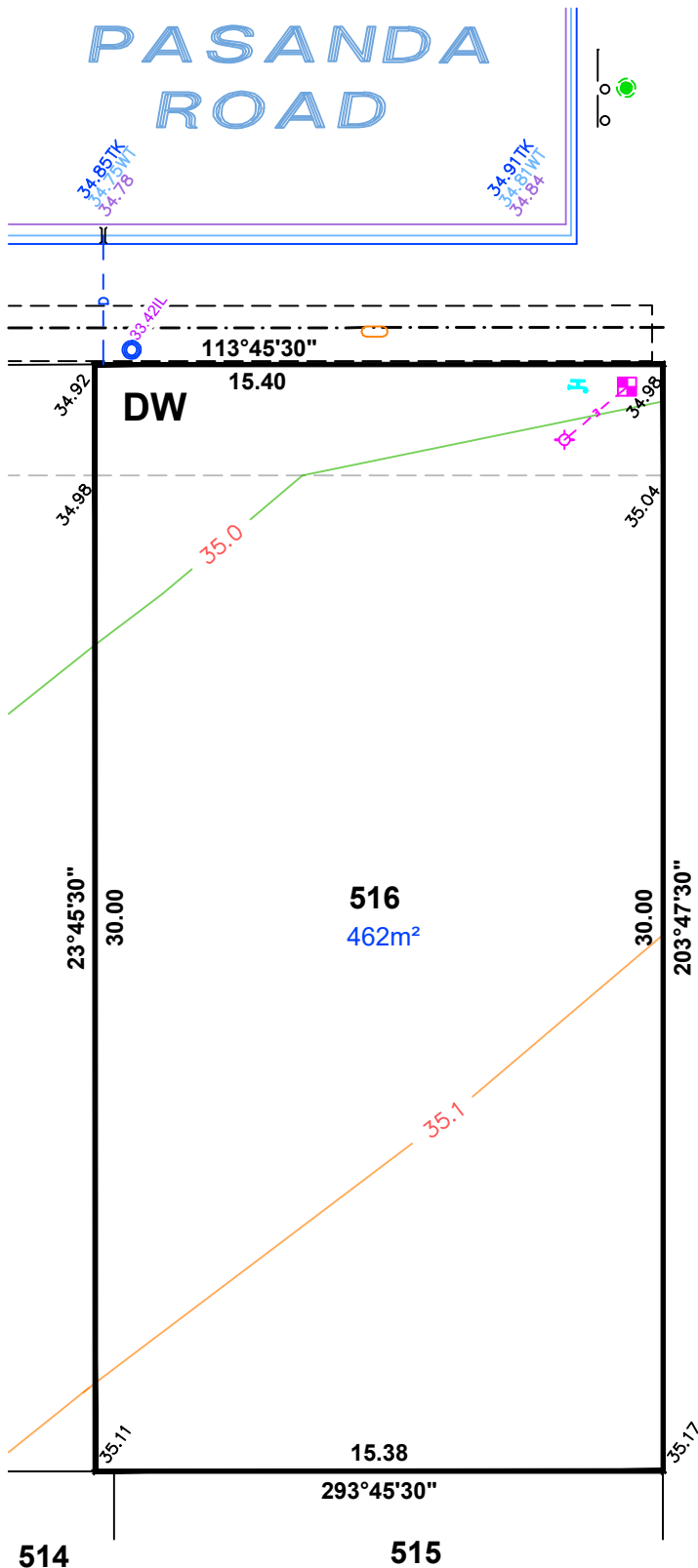

LEGEND

- ELECTRICAL LEAD IN
- SEWER IP
- STOBIE POLE
- TELSTRA PIT
- STORMWATER GRATING
- SEWER MAN HOLE
- STORMWATER MANHOLE
- LIGHT POLE
- SAPN CONNECTION
- BOLLARD
- SIGN
- STORMWATER CONNECTION
- FOOTPATH
- SIDE ENTRY PIT
- COMMON SERVICE TRENCH
- DOMESTIC OUTLET (STORMWATER)
- SEWER IO
- POTABLE WATER CONNECTION
- DW** DRIVEWAY

ALEXANDER SYMONDS
 PH 8130 1666

DISCLAIMER: DATA SHOWN HEREON IS DESIGN INFORMATION AND SHOULD BE CONFIRMED
 ORIGINAL SHEET SIZE A4

IMPORTANT
 SERVICE AND DRIVEWAY LOCATIONS
 ARE APPROXIMATE. ANY CHANGES WILL
 BE AT THE PURCHASERS EXPENSE.
 PURCHASER: _____
 PURCHASER: _____
 DATE: _____

DISCLAIMER:
 Please note that this site plan is intended for
 visual purposes only, additional survey work will
 be required prior to commencing any design or
 construction on the site.

ALLOTMENT 517 in DEV. NO. 292/D066/12/013

**in the area named
 MUNNO PARA WEST**

CT ---/----

PRELIMINARY



1:200

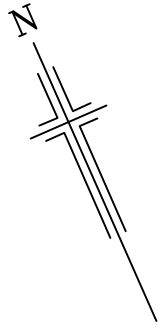

PASANDA ROAD

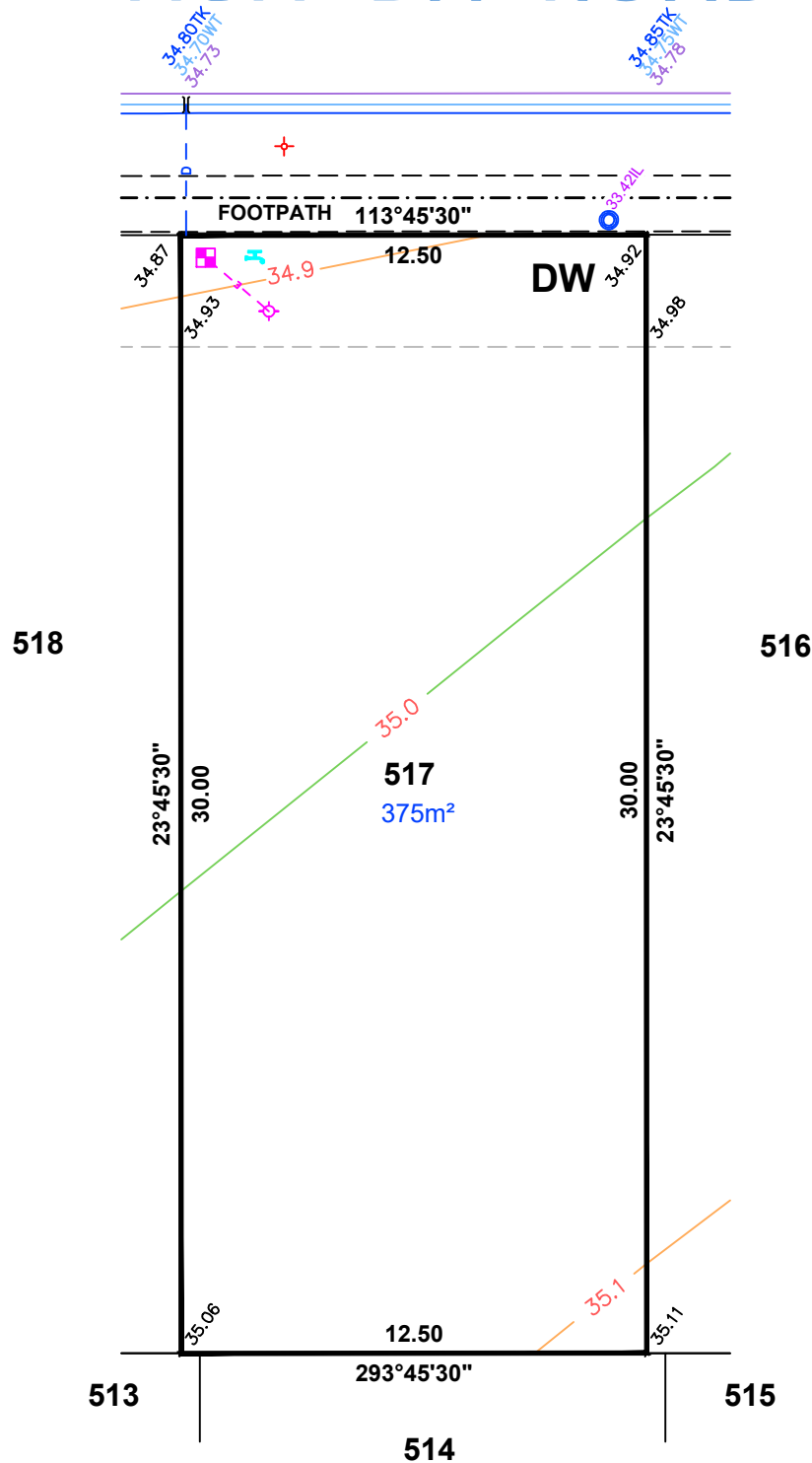

LEGEND

- ELECTRICAL LEAD IN
- SEWER IP
- STOBIE POLE
- TELSTRA PIT
- STORMWATER GRATING
- SEWER MAN HOLE
- STORMWATER MANHOLE
- LIGHT POLE
- SAPN CONNECTION
- BOLLARD
- SIGN
- STORMWATER CONNECTION
- FOOTPATH
- SIDE ENTRY PIT
- COMMON SERVICE TRENCH
- DOMESTIC OUTLET (STORMWATER)
- SEWER IO
- POTABLE WATER CONNECTION
- DW** DRIVEWAY

IMPORTANT
 SERVICE AND DRIVEWAY LOCATIONS
 ARE APPROXIMATE. ANY CHANGES WILL
 BE AT THE PURCHASERS EXPENSE.
 PURCHASER: _____
 PURCHASER: _____
 DATE: _____

DISCLAIMER:
 Please note that this site plan is intended for
 visual purposes only, additional survey work will
 be required prior to commencing any design or
 construction on the site.

ALLOTMENT 518 in DEV. NO. 292/D066/12/013
 in the area named
MUNNO PARA WEST
 CT ---/----



1:200

PRELIMINARY

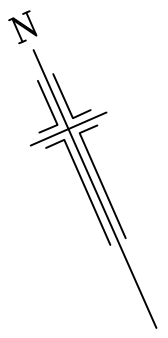

PASANDA ROAD

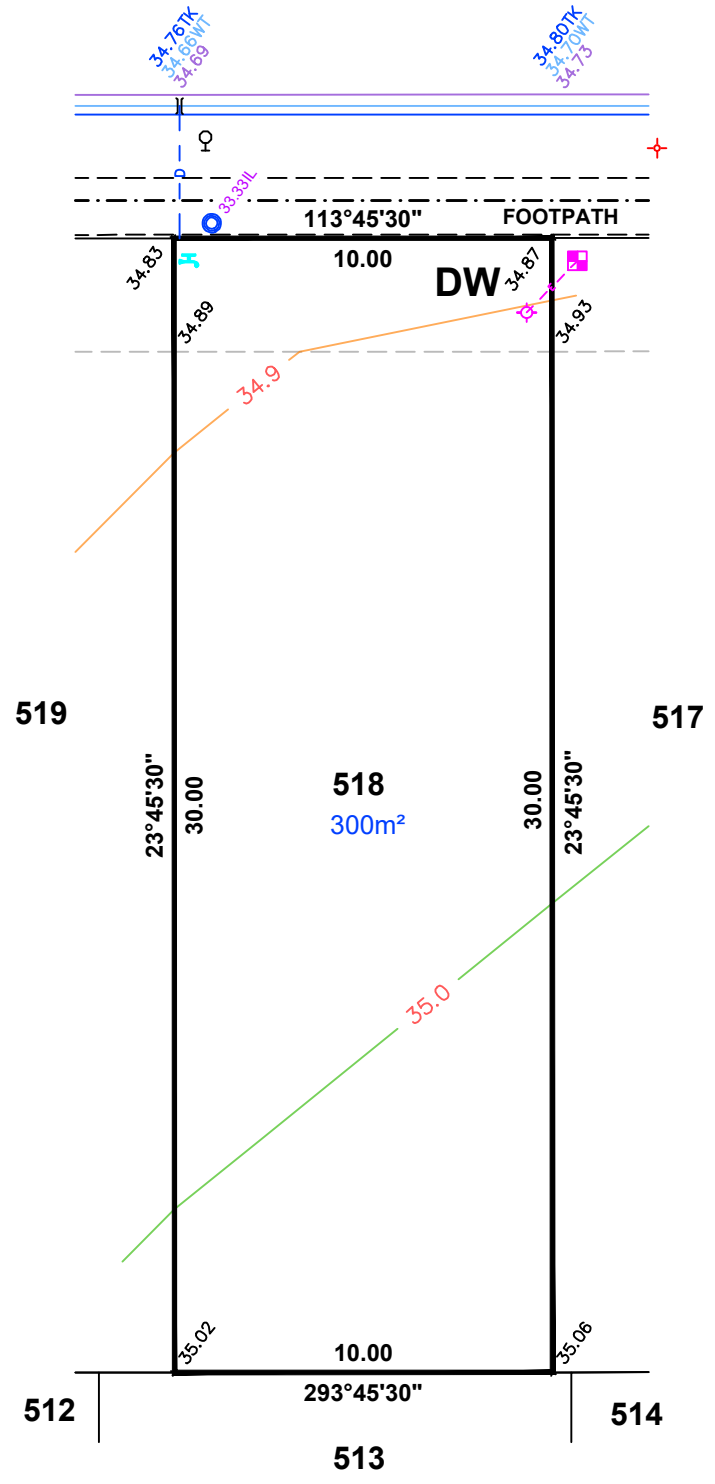

LEGEND

- ELECTRICAL LEAD IN
- SEWER IP
- STOBIE POLE
- TELSTRA PIT
- STORMWATER GRATING
- SEWER MAN HOLE
- STORMWATER MANHOLE
- LIGHT POLE
- SAPN CONNECTION
- BOLLARD
- SIGN
- STORMWATER CONNECTION
- FOOTPATH
- SIDE ENTRY PIT
- COMMON SERVICE TRENCH
- DOMESTIC OUTLET (STORMWATER)
- SEWER IO
- POTABLE WATER CONNECTION
- DW** DRIVEWAY

ALEXANDER SYMONDS
 PH 8130 1666

DISCLAIMER: DATA SHOWN HEREON IS DESIGN INFORMATION AND SHOULD BE CONFIRMED
 ORIGINAL SHEET SIZE A4

IMPORTANT
 SERVICE AND DRIVEWAY LOCATIONS
 ARE APPROXIMATE. ANY CHANGES WILL
 BE AT THE PURCHASERS EXPENSE.
 PURCHASER: _____
 PURCHASER: _____
 DATE: _____

DISCLAIMER:
 Please note that this site plan is intended for
 visual purposes only, additional survey work will
 be required prior to commencing any design or
 construction on the site.

ALLOTMENT 519 in DEV. NO. 292/D066/12/013
 in the area named
MUNNO PARA WEST
 CT ---/----



1:200

PRELIMINARY

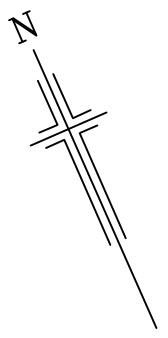

PASANDA ROAD

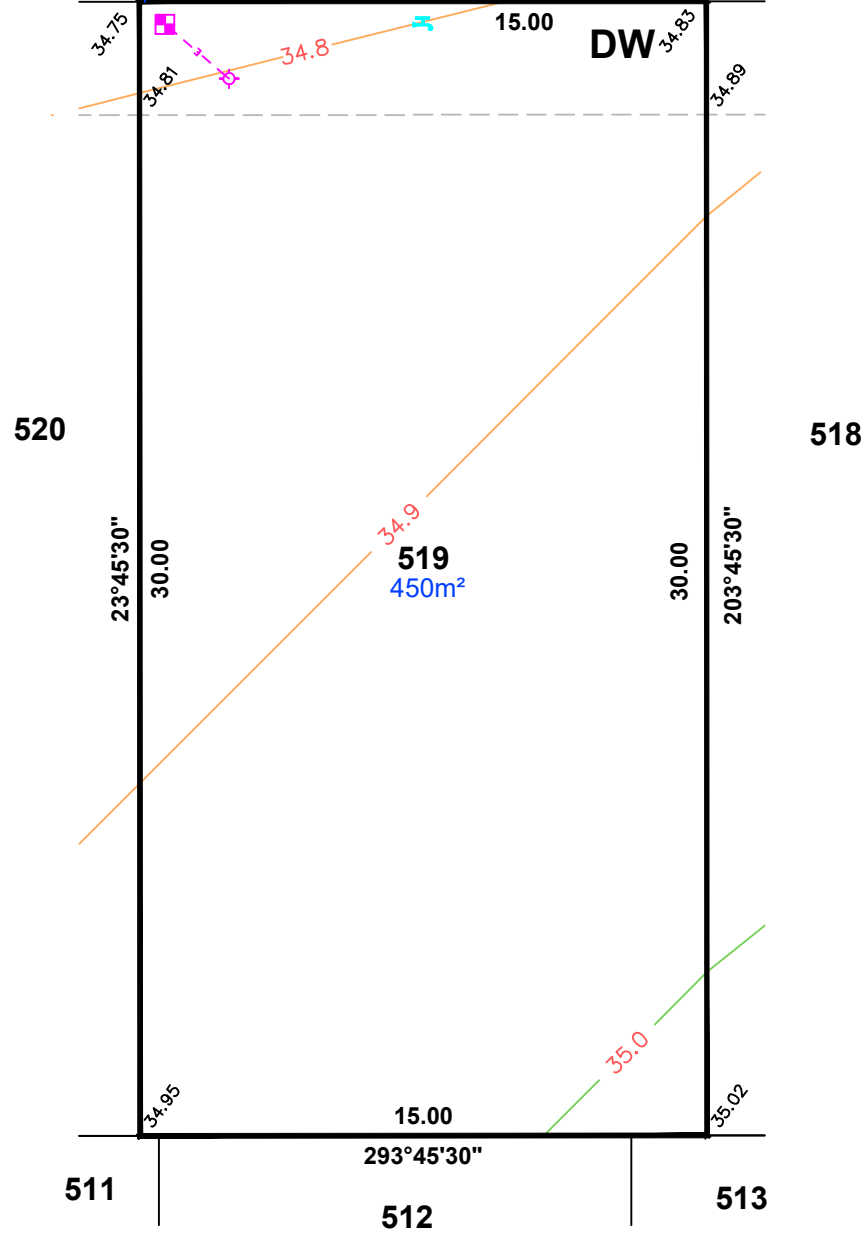
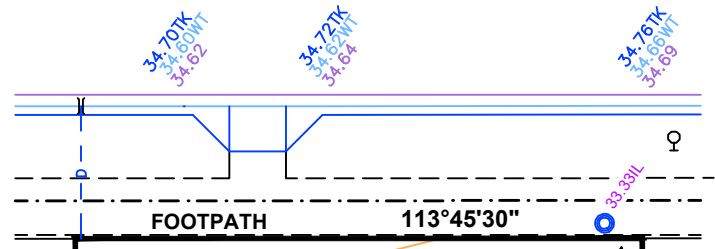

LEGEND

- ELECTRICAL LEAD IN
- SEWER IP
- STOBIE POLE
- TELSTRA PIT
- STORMWATER GRATING
- SEWER MAN HOLE
- STORMWATER MANHOLE
- LIGHT POLE
- SAPN CONNECTION
- BOLLARD
- SIGN
- STORMWATER CONNECTION
- FOOTPATH
- SIDE ENTRY PIT
- COMMON SERVICE TRENCH
- DOMESTIC OUTLET (STORMWATER)
- SEWER IO
- POTABLE WATER CONNECTION
- DW** DRIVEWAY

ALEXANDER SYMONDS
 PH 8130 1666

DISCLAIMER: DATA SHOWN HEREON IS DESIGN INFORMATION AND SHOULD BE CONFIRMED
 ORIGINAL SHEET SIZE A4

IMPORTANT
 SERVICE AND DRIVEWAY LOCATIONS
 ARE APPROXIMATE. ANY CHANGES WILL
 BE AT THE PURCHASERS EXPENSE.
 PURCHASER: _____
 PURCHASER: _____
 DATE: _____

DISCLAIMER:
 Please note that this site plan is intended for
 visual purposes only, additional survey work will
 be required prior to commencing any design or
 construction on the site.

ALLOTMENT 520 in DEV. NO. 292/D066/12/013

**in the area named
 MUNNO PARA WEST**

CT ---/----

PRELIMINARY



1:200

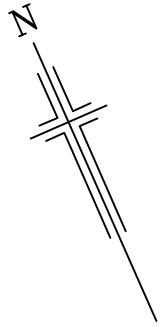

PASANDA ROAD

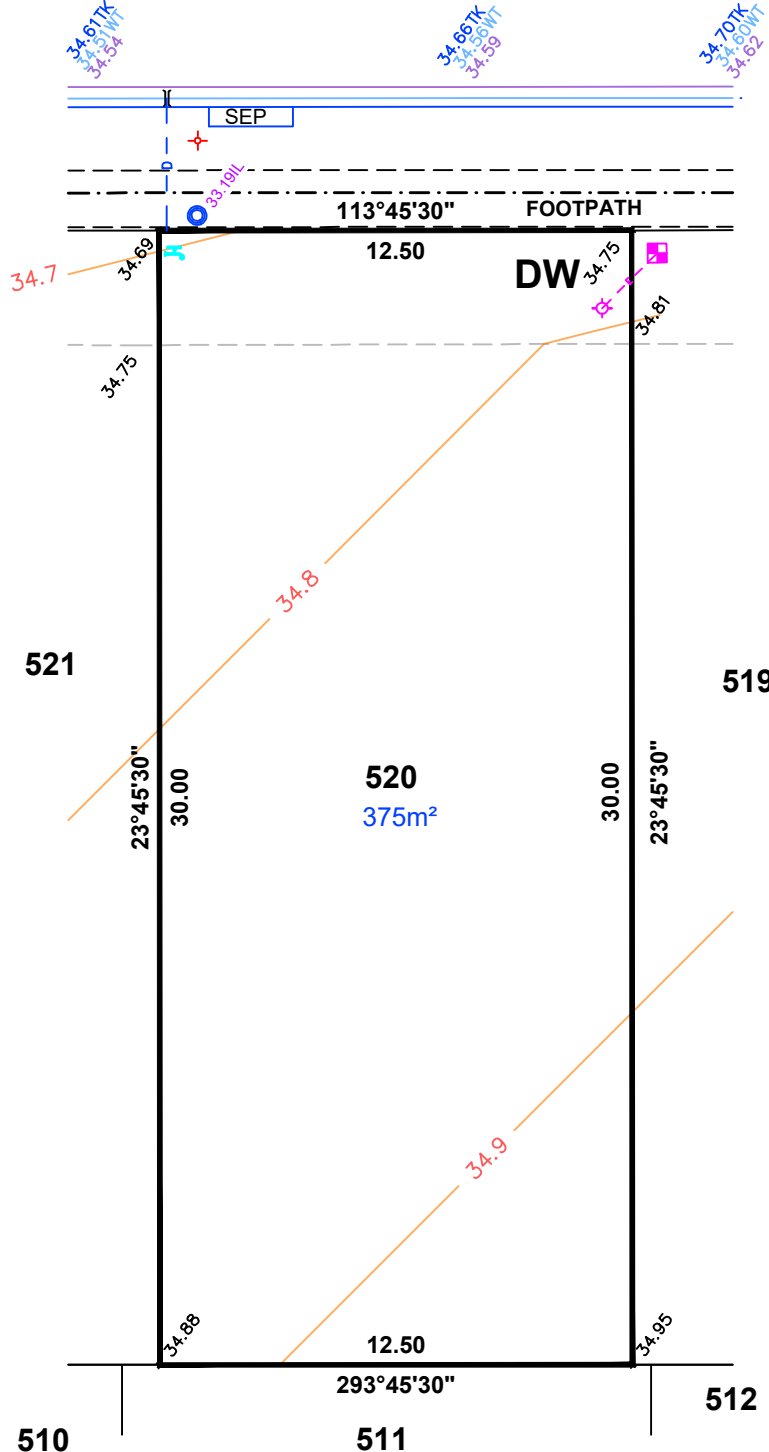

LEGEND

- ELECTRICAL LEAD IN
- SEWER IP
- STOBIE POLE
- TELSTRA PIT
- STORMWATER GRATING
- SEWER MAN HOLE
- STORMWATER MANHOLE
- LIGHT POLE
- SAPN CONNECTION
- BOLLARD
- SIGN
- STORMWATER CONNECTION
- FOOTPATH
- SIDE ENTRY PIT
- COMMON SERVICE TRENCH
- DOMESTIC OUTLET (STORMWATER)
- SEWER IO
- POTABLE WATER CONNECTION
- DW** DRIVEWAY

ALEXANDER SYMONDS
 PH 8130 1666

DISCLAIMER: DATA SHOWN HEREON IS DESIGN INFORMATION AND SHOULD BE CONFIRMED
 ORIGINAL SHEET SIZE A4

IMPORTANT
 SERVICE AND DRIVEWAY LOCATIONS
 ARE APPROXIMATE. ANY CHANGES WILL
 BE AT THE PURCHASERS EXPENSE.
 PURCHASER: _____
 PURCHASER: _____
 DATE: _____

DISCLAIMER:
 Please note that this site plan is intended for
 visual purposes only, additional survey work will
 be required prior to commencing any design or
 construction on the site.

ALLOTMENT 521 in DEV. NO. 292/D066/12/013

**in the area named
 MUNNO PARA WEST**

CT ---/----

PRELIMINARY



1:200

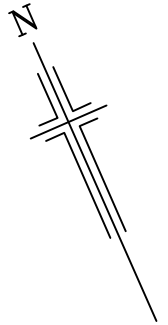

PASANDA ROAD

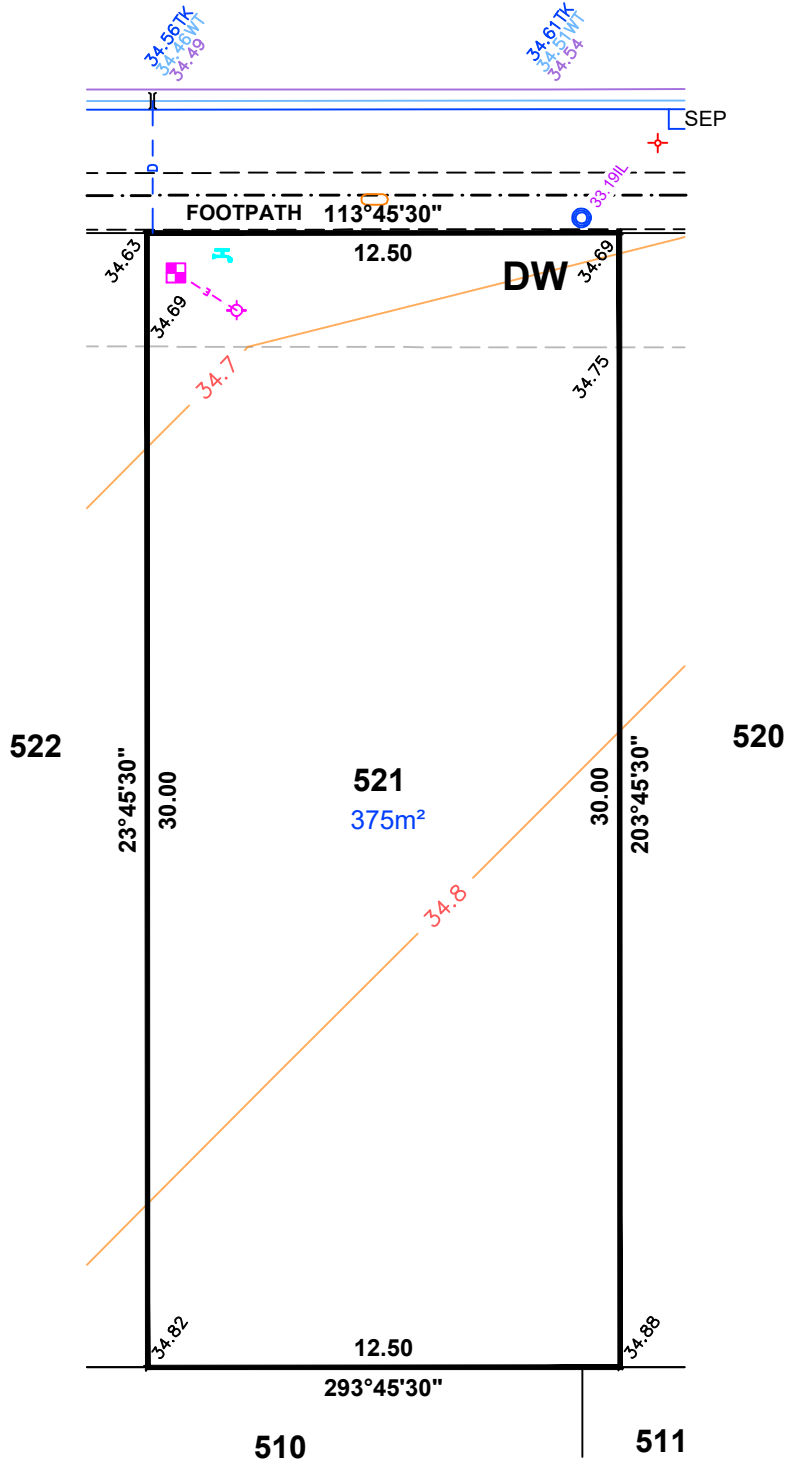

LEGEND

- ELECTRICAL LEAD IN
- SEWER IP
- STOBIE POLE
- TELSTRA PIT
- STORMWATER GRATING
- SEWER MAN HOLE
- STORMWATER MANHOLE
- LIGHT POLE
- SAPN CONNECTION
- BOLLARD
- SIGN
- STORMWATER CONNECTION
- FOOTPATH
- SIDE ENTRY PIT
- COMMON SERVICE TRENCH
- DOMESTIC OUTLET (STORMWATER)
- SEWER IO
- POTABLE WATER CONNECTION
- DW** DRIVEWAY

IMPORTANT
 SERVICE AND DRIVEWAY LOCATIONS
 ARE APPROXIMATE. ANY CHANGES WILL
 BE AT THE PURCHASERS EXPENSE.
 PURCHASER: _____
 PURCHASER: _____
 DATE: _____

DISCLAIMER:
 Please note that this site plan is intended for
 visual purposes only, additional survey work will
 be required prior to commencing any design or
 construction on the site.

ALLOTMENT 522 in DEV. NO. 292/D066/12/013

**in the area named
 MUNNO PARA WEST**

CT ---/----

PRELIMINARY



1:200

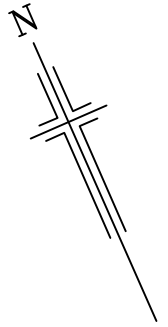

PASANDA ROAD

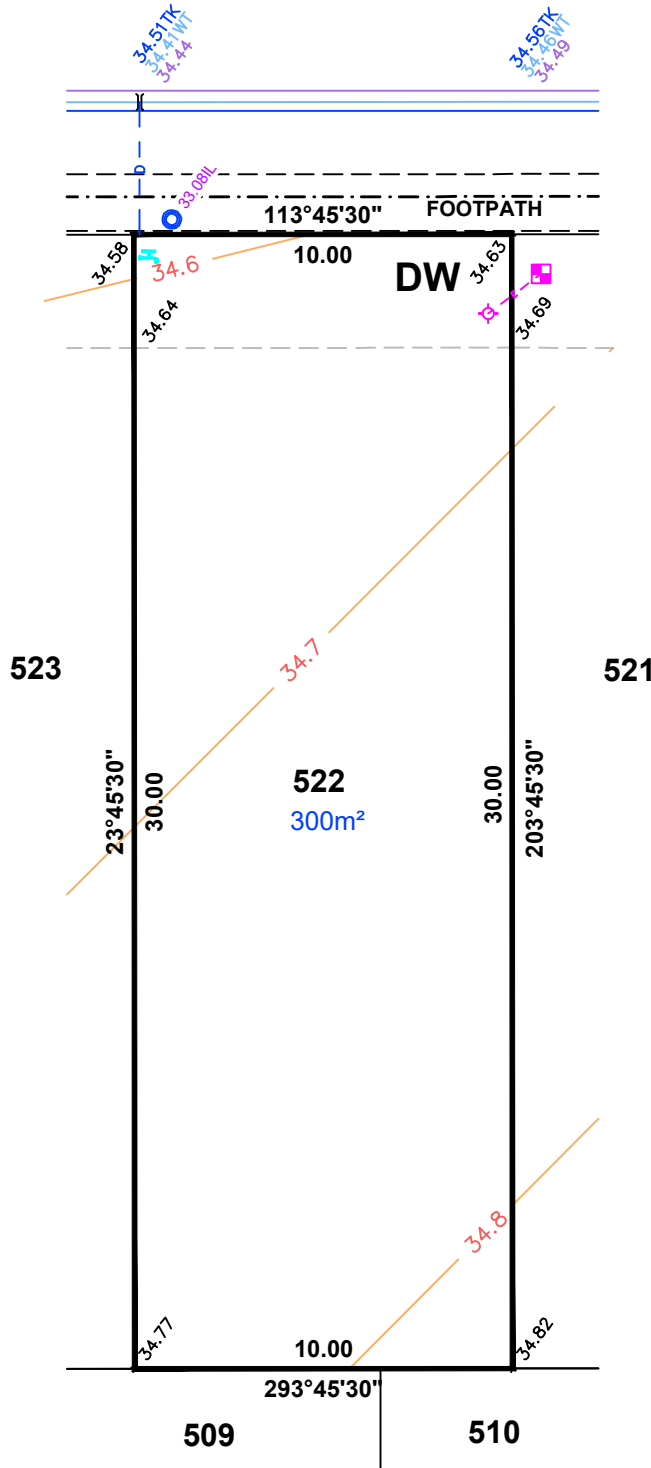

LEGEND

- ELECTRICAL LEAD IN
- SEWER IP
- STOBIE POLE
- TELSTRA PIT
- STORMWATER GRATING
- SEWER MAN HOLE
- STORMWATER MANHOLE
- LIGHT POLE
- SAPN CONNECTION
- BOLLARD
- SIGN
- STORMWATER CONNECTION
- FOOTPATH
- SIDE ENTRY PIT
- COMMON SERVICE TRENCH
- DOMESTIC OUTLET (STORMWATER)
- SEWER IO
- POTABLE WATER CONNECTION
- DW** DRIVEWAY

ALEXANDER SYMONDS
 PH 8130 1666

DISCLAIMER: DATA SHOWN HEREON IS DESIGN INFORMATION AND SHOULD BE CONFIRMED
 ORIGINAL SHEET SIZE A4

IMPORTANT
 SERVICE AND DRIVEWAY LOCATIONS
 ARE APPROXIMATE. ANY CHANGES WILL
 BE AT THE PURCHASERS EXPENSE.
 PURCHASER: _____
 PURCHASER: _____
 DATE: _____

ALLOTMENT 544 in DEV. NO. 292/D066/12/013

in the area named
MUNNO PARA WEST

CT ---/----

PRELIMINARY

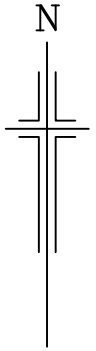

DISCLAIMER:

Please note that this site plan is intended for visual purposes only, additional survey work will be required prior to commencing any design or construction on the site.

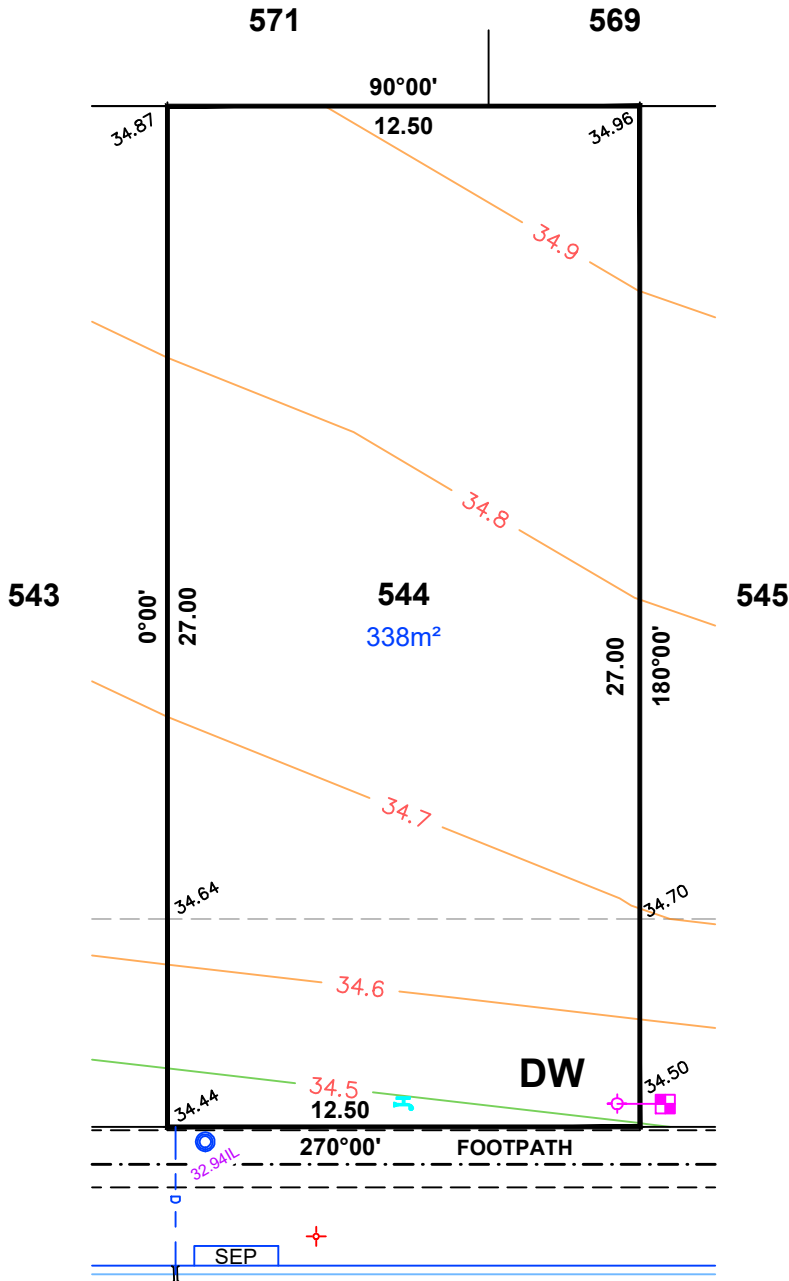

LEGEND

- ELECTRICAL LEAD IN
- SEWER IP
- STOBIE POLE
- TELSTRA PIT
- STORMWATER GRATING
- SEWER MAN HOLE
- STORMWATER MANHOLE
- LIGHT POLE
- SAPN CONNECTION
- BOLLARD
- SIGN
- STORMWATER CONNECTION
- FOOTPATH
- SIDE ENTRY PIT
- COMMON SERVICE TRENCH
- DOMESTIC OUTLET (STORMWATER)
- SEWER IO
- POTABLE WATER CONNECTION
- DW** DRIVEWAY

ANDALUSIA AVENUE



ALEXANDER SYMONDS
 PH 8130 1666

1:200

DISCLAIMER: DATA SHOWN HEREON IS DESIGN INFORMATION AND SHOULD BE CONFIRMED ORIGINAL SHEET SIZE A4

IMPORTANT
 SERVICE AND DRIVEWAY LOCATIONS
 ARE APPROXIMATE. ANY CHANGES WILL
 BE AT THE PURCHASERS EXPENSE.
 PURCHASER: _____
 PURCHASER: _____
 DATE: _____

ALLOTMENT 545 in DEV. NO. 292/D066/12/013

in the area named
MUNNO PARA WEST

CT ---/----

PRELIMINARY

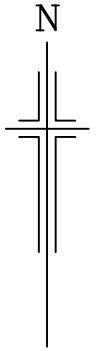

DISCLAIMER:

Please note that this site plan is intended for visual purposes only, additional survey work will be required prior to commencing any design or construction on the site.

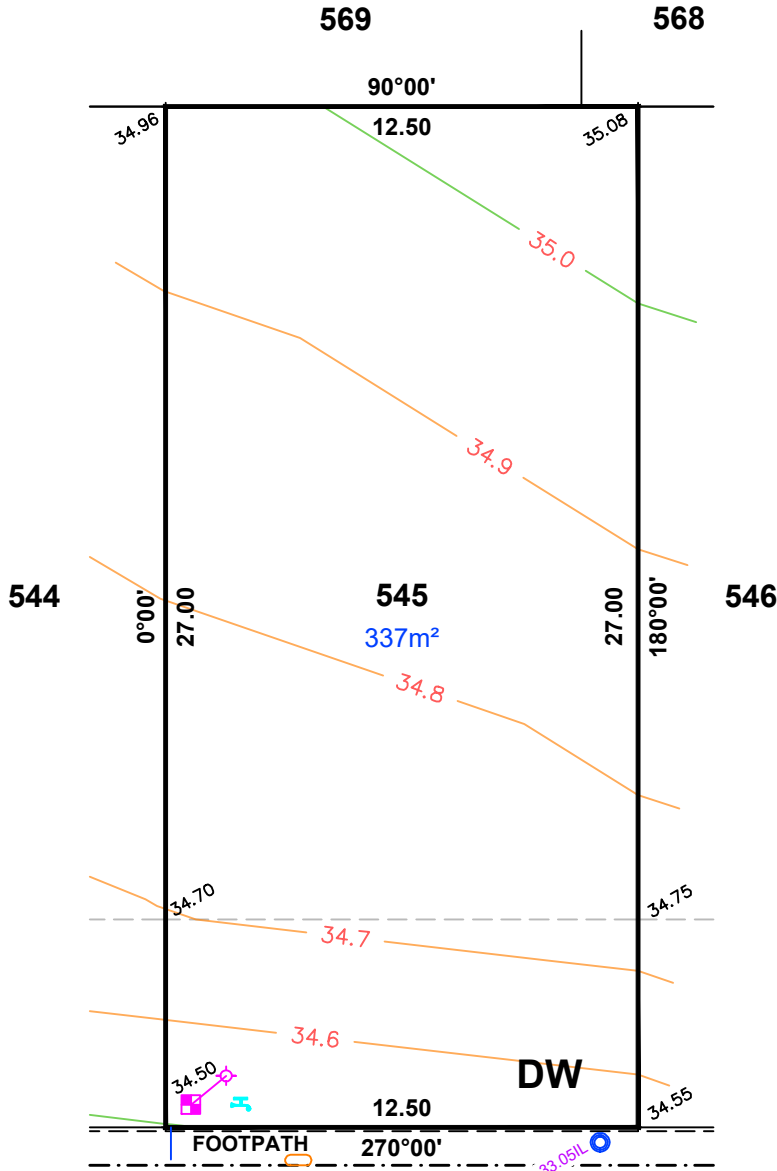

LEGEND

- ELECTRICAL LEAD IN
- SEWER IP
- STOBIE POLE
- TELSTRA PIT
- STORMWATER GRATING
- SEWER MAN HOLE
- STORMWATER MANHOLE
- LIGHT POLE
- SAPN CONNECTION
- BOLLARD
- SIGN
- STORMWATER CONNECTION
- FOOTPATH
- SIDE ENTRY PIT
- COMMON SERVICE TRENCH
- DOMESTIC OUTLET (STORMWATER)
- SEWER IO
- POTABLE WATER CONNECTION
- DW** DRIVEWAY

ANDALUSIA AVENUE



ALEXANDER SYMONDS
 PH 8130 1666

1:200

DISCLAIMER: DATA SHOWN HEREON IS DESIGN INFORMATION AND SHOULD BE CONFIRMED ORIGINAL SHEET SIZE A4

ALLOTMENT 551 in DEV. NO. 292/D066/12/013
in the area named
MUNNO PARA WEST
CT ---/----

PRELIMINARY



1:200

552

113°47'30"

30.00

34.74

34.68

34.71

34.67K

34.51

34.51

34.51

34.51

34.51

34.51

34.51

34.51

34.51

34.51

34.51

16.00

203°47'30"

34.71

34.67K

34.51

34.51

34.51

34.51

34.51

34.51

34.51

34.51

34.51

34.51

34.51

34.51

34.51

34.51

4.24

248°46'30"

34.79

34.79

34.79

34.79

34.79

34.79

34.79

34.79

34.79

34.79

34.79

34.79

27.00

293°45'30"

34.79

34.79

34.79

34.79

34.79

34.79

34.79

34.79

34.79

34.79

34.79

34.79

34.79

19.02

23°47'30"

34.69

34.69

34.69

34.69

34.69

34.69

34.69

34.69

34.69

34.69

34.69

34.69

34.69

551

566m²

34.8

34.8

34.8

34.8

34.8

34.8

34.8

34.8

34.8

34.8

34.8

34.8

34.8

34.8

34.8

34.8

34.8

34.8

34.8

34.8

34.8

34.8

34.8

34.8

34.8

34.8

34.8

34.8

34.8

34.8

34.8

34.8

34.8

34.8

34.8

34.8

34.8

34.8

34.8

34.8

34.8

34.8

34.8

34.8

34.8

34.8

34.8

34.8

34.8

34.8

34.8

34.8

34.8

34.8

34.8

550

19.02

34.8

34.8

34.8

34.8

34.8

34.8

34.8

34.8

34.8

34.8

34.8

34.8

34.8

34.8

34.8

34.8

34.8

34.8

34.8

34.8

34.8

34.8

34.8

34.8

34.8

34.8

34.8

34.8

34.8

34.8

34.8

34.8

34.8

34.8

34.8

34.8

34.8

34.8

34.8

34.8

34.8

34.8

34.8

34.8

34.8

34.8

34.8

34.8

34.8

34.8

34.8

34.8

34.8

34.8

34.8

549

30.00

113°47'30"

34.88

34.88

34.88

34.88

34.88

34.88

34.88

34.88

34.88

34.88

34.88

34.88

34.88

34.88

34.88

34.88

34.88

34.88

34.88

34.88

34.88

34.88

34.88

34.88

34.88

34.88

34.88

34.88

34.88

34.88

34.88

34.88

34.88

34.88

34.88

34.88

34.88

34.88

34.88

34.88

34.88

34.88

34.88

34.88

34.88

34.88

34.88

34.88

34.88

34.88

34.88

34.88

34.88

34.88

550

19.02

23°47'30"

34.88

34.88

34.88

34.88

34.88

34.88

34.88

34.88

34.88

34.88

34.88

34.88

34.88

34.88

34.88

34.88

34.88

34.88

34.88

34.88

34.88

34.88

34.88

34.88

34.88

34.88

34.88

34.88

34.88

ALLOTMENT 552 in DEV. NO. 292/D066/12/013
in the area named
MUNNO PARA WEST
CT ---/---/----

PRELIMINARY

IMPORTANT
SERVICE AND DRIVEWAY LOCATIONS
ARE APPROXIMATE. ANY CHANGES WILL
BE AT THE PURCHASERS EXPENSE.
PURCHASER: _____
DATE: _____

DISCLAIMER:

Please note that this site plan is intended for
visual purposes only, additional survey work will
be required prior to commencing any design or
construction on the site.



1:200

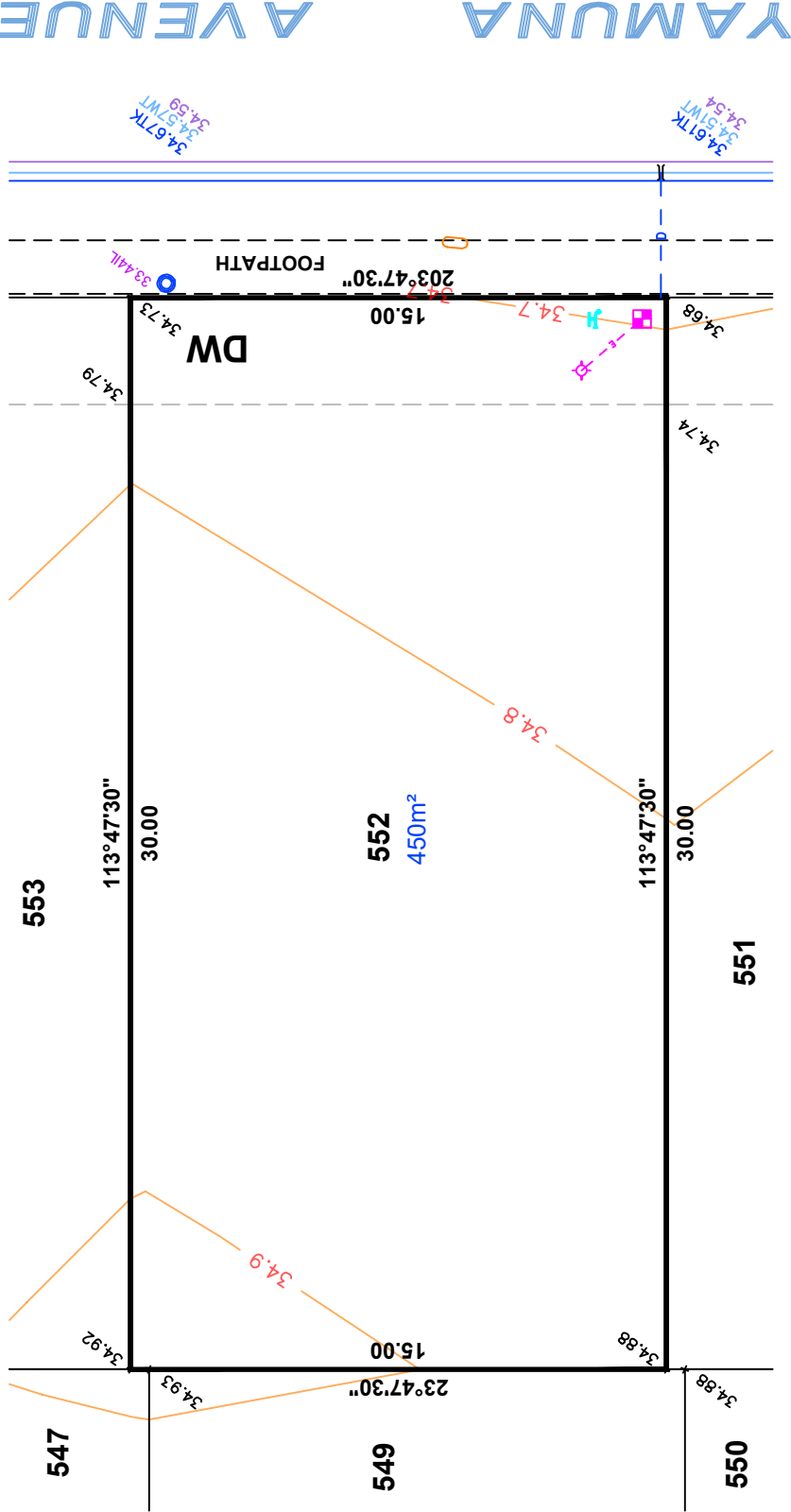

LEGEND

- ELECTRICAL LEAD IN
- SEWER IP
- STOBIE POLE
- TELSTRA PIT
- STORMWATER GRATING
- SEWER MAN HOLE
- STORMWATER MANHOLE
- LIGHT POLE
- SAPN CONNECTION
- BOLLARD
- SIGN
- STORMWATER CONNECTION
- FOOTPATH
- SIDE ENTRY PIT
- COMMON SERVICE TRENCH
- DOMESTIC OUTLET (STORMWATER)
- SEWER IO
- POTABLE WATER CONNECTION
- DW

ALEXANDER SYMONDS
PH 8130 1666

DISCLAIMER: DATA SHOWN HEREON IS DESIGN INFORMATION AND SHOULD BE CONFIRMED
ORIGINAL SHEET SIZE A4

ALLOTMENT 553 in DEV. NO. 292/D066/12/013
in the area named
MUNNO PARA WEST
CT ---/----

PRELIMINARY

IMPORTANT
SERVICE AND DRIVEWAY LOCATIONS
ARE APPROXIMATE. ANY CHANGES WILL
BE AT THE PURCHASERS EXPENSE.
PURCHASER: _____
DATE: _____

DISCLAIMER:

Please note that this site plan is intended for
visual purposes only, additional survey work will
be required prior to commencing any design or
construction on the site.



1:200

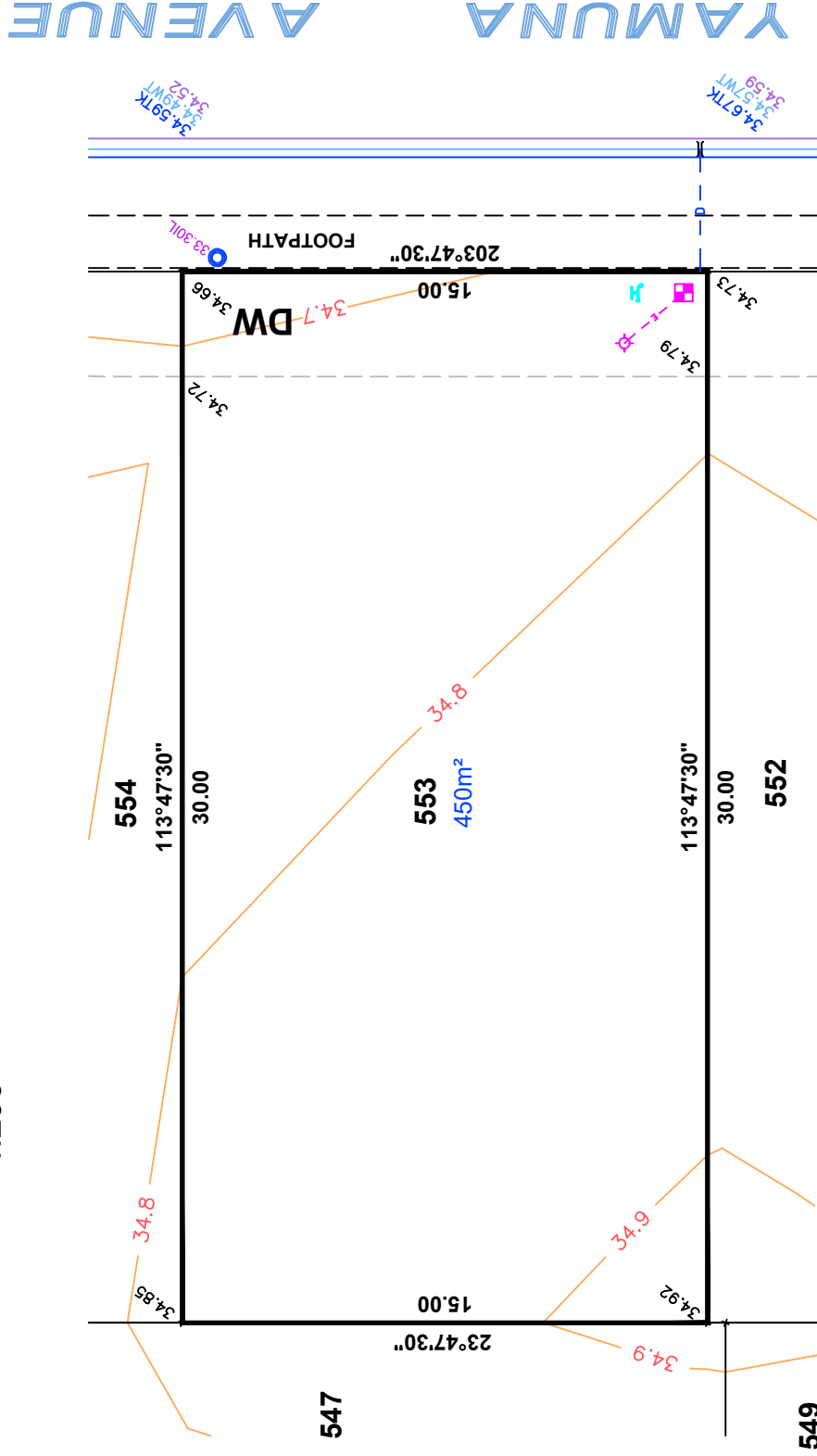

LEGEND

- ELECTRICAL LEAD IN
- SEWER IP
- STOBIE POLE
- TELSTRA PIT
- STORMWATER GRATING
- SEWER MAN HOLE
- STORMWATER MANHOLE
- LIGHT POLE
- SAPN CONNECTION
- BOLLARD
- SIGN
- STORMWATER CONNECTION
- FOOTPATH
- SIDE ENTRY PIT
- COMMON SERVICE TRENCH
- DOMESTIC OUTLET (STORMWATER)
- SEWER IO
- POTABLE WATER CONNECTION
- DW

ALEXANDER SYMONDS
PH 8130 1666

DISCLAIMER: DATA SHOWN HEREON IS DESIGN INFORMATION AND SHOULD BE CONFIRMED
ORIGINAL SHEET SIZE A4

IMPORTANT
 SERVICE AND DRIVEWAY LOCATIONS
 ARE APPROXIMATE. ANY CHANGES WILL
 BE AT THE PURCHASERS EXPENSE.
 PURCHASER: _____
 PURCHASER: _____
 DATE: _____

ALLOTMENT 555 in DEV. NO. 292/D066/12/013

**in the area named
 MUNNO PARA WEST**

CT ---/----

PRELIMINARY

DISCLAIMER:

Please note that this site plan is intended for visual purposes only, additional survey work will be required prior to commencing any design or construction on the site.

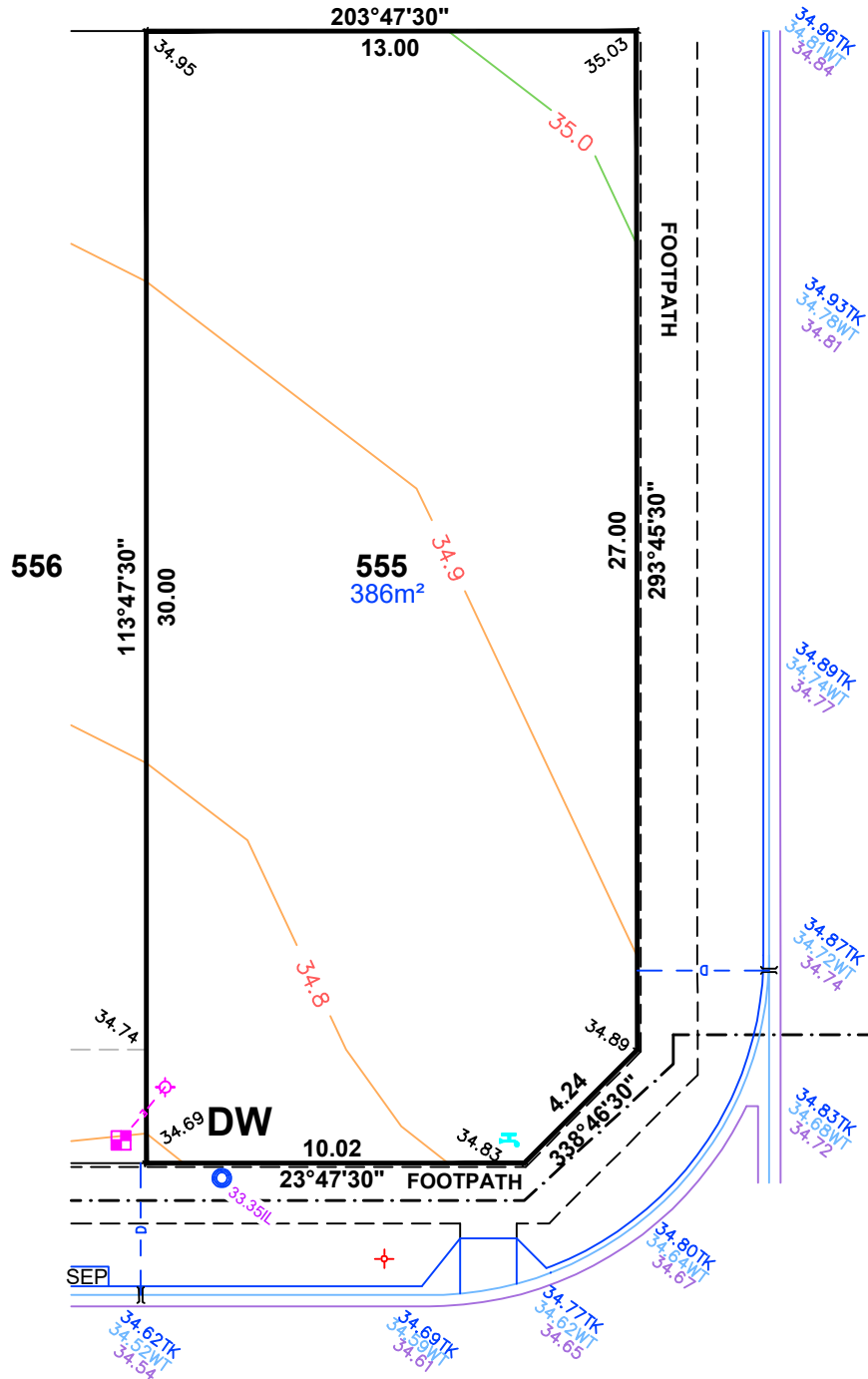
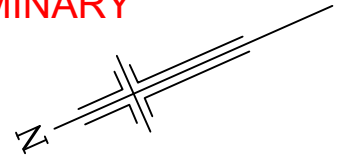

PASANDA ROAD

YAMUNA AVENUE

LEGEND

- ELECTRICAL LEAD IN
- SEWER IP
- STOBIE POLE
- TELSTRA PIT
- STORMWATER GRATING
- SEWER MAN HOLE
- STORMWATER MANHOLE
- LIGHT POLE
- SAPN CONNECTION
- BOLLARD
- SIGN
- STORMWATER CONNECTION
- FOOTPATH
- SIDE ENTRY PIT
- COMMON SERVICE TRENCH
- DOMESTIC OUTLET (STORMWATER)
- SEWER IO
- POTABLE WATER CONNECTION
- DW** DRIVEWAY



ALEXANDER SYMONDS
 PH 8130 1666

1:200

DISCLAIMER: DATA SHOWN HEREON IS DESIGN INFORMATION AND SHOULD BE CONFIRMED ORIGINAL SHEET SIZE A4

IMPORTANT
 SERVICE AND DRIVEWAY LOCATIONS
 ARE APPROXIMATE. ANY CHANGES WILL
 BE AT THE PURCHASERS EXPENSE.
 PURCHASER: _____
 PURCHASER: _____
 DATE: _____

ALLOTMENT 556 in DEV. NO. 292/D066/12/013

in the area named
MUNNO PARA WEST

CT ---/----

PRELIMINARY

DISCLAIMER:

Please note that this site plan is intended for visual purposes only, additional survey work will be required prior to commencing any design or construction on the site.

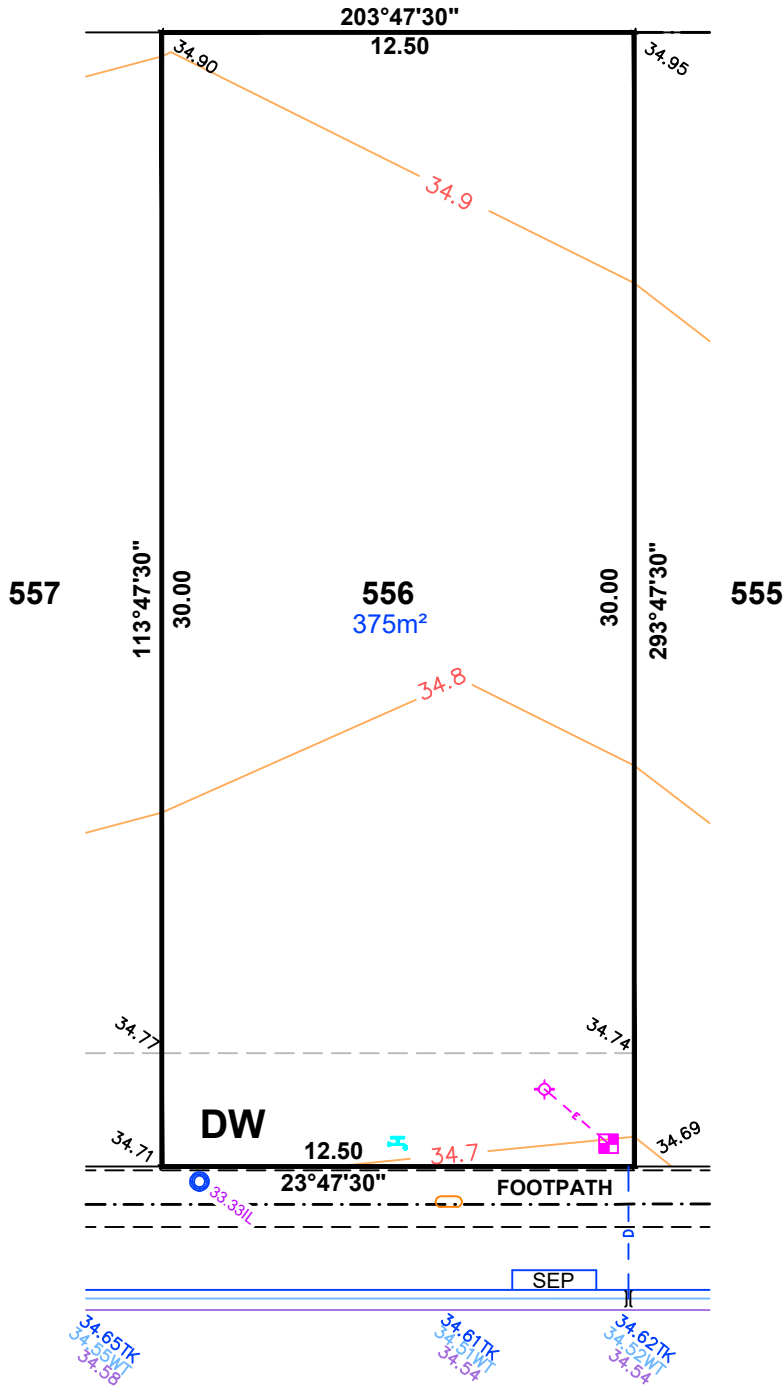
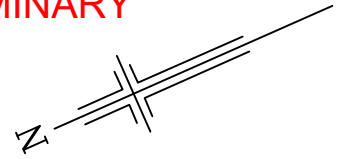

LEGEND

- ELECTRICAL LEAD IN
- SEWER IP
- STOBIE POLE
- TELSTRA PIT
- STORMWATER GRATING
- SEWER MAN HOLE
- STORMWATER MANHOLE
- LIGHT POLE
- SAPN CONNECTION
- BOLLARD
- SIGN
- STORMWATER CONNECTION
- FOOTPATH
- SIDE ENTRY PIT
- COMMON SERVICE TRENCH
- DOMESTIC OUTLET (STORMWATER)
- SEWER IO
- POTABLE WATER CONNECTION
- DW** DRIVEWAY

YAMUNA AVENUE



ALEXANDER SYMONDS
 PH 8130 1666

1:200

DISCLAIMER: DATA SHOWN HEREON IS DESIGN INFORMATION AND SHOULD BE CONFIRMED ORIGINAL SHEET SIZE A4

IMPORTANT
 SERVICE AND DRIVEWAY LOCATIONS
 ARE APPROXIMATE. ANY CHANGES WILL
 BE AT THE PURCHASERS EXPENSE.
 PURCHASER: _____
 PURCHASER: _____
 DATE: _____

ALLOTMENT 558 in DEV. NO. 292/D066/12/013

in the area named
MUNNO PARA WEST

CT ---/----

PRELIMINARY

DISCLAIMER:

Please note that this site plan is intended for visual purposes only, additional survey work will be required prior to commencing any design or construction on the site.

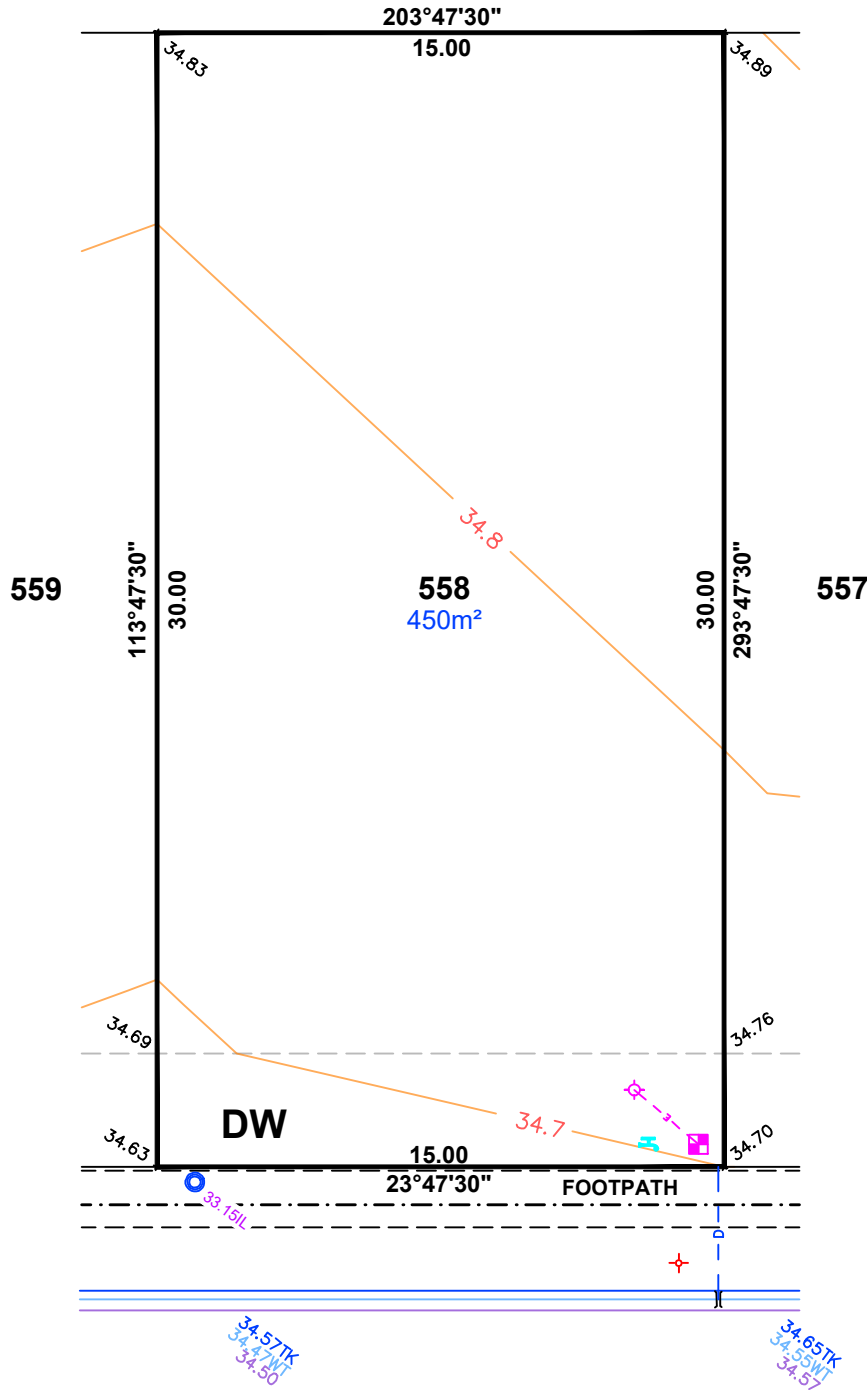
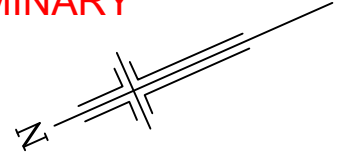

LEGEND

- ELECTRICAL LEAD IN
- SEWER IP
- STOBIE POLE
- TELSTRA PIT
- STORMWATER GRATING
- SEWER MAN HOLE
- STORMWATER MANHOLE
- LIGHT POLE
- SAPN CONNECTION
- BOLLARD
- SIGN
- STORMWATER CONNECTION
- FOOTPATH
- SIDE ENTRY PIT
- COMMON SERVICE TRENCH
- DOMESTIC OUTLET (STORMWATER)
- SEWER IO
- POTABLE WATER CONNECTION
- DW** DRIVEWAY

YAMUNA AVENUE



ALEXANDER SYMONDS
 PH 8130 1666

1:200

DISCLAIMER: DATA SHOWN HEREON IS DESIGN INFORMATION AND SHOULD BE CONFIRMED ORIGINAL SHEET SIZE A4

IMPORTANT
 SERVICE AND DRIVEWAY LOCATIONS
 ARE APPROXIMATE. ANY CHANGES WILL
 BE AT THE PURCHASERS EXPENSE.
 PURCHASER: _____
 PURCHASER: _____
 DATE: _____

ALLOTMENT 559 in DEV. NO. 292/D066/12/013

in the area named
MUNNO PARA WEST

CT ---/----

PRELIMINARY

DISCLAIMER:

Please note that this site plan is intended for visual purposes only, additional survey work will be required prior to commencing any design or construction on the site.

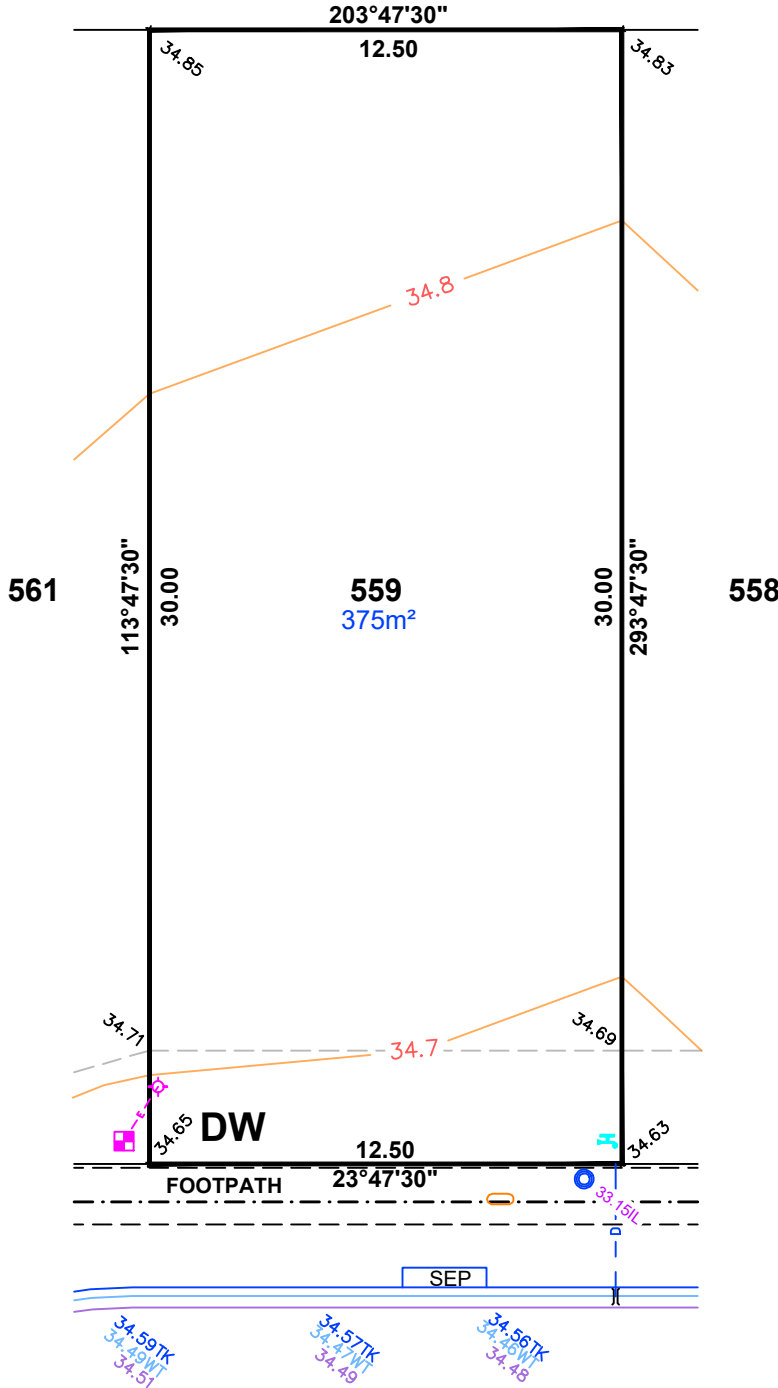
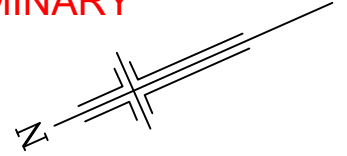

LEGEND

- ELECTRICAL LEAD IN
- SEWER IP
- STOBIE POLE
- TELSTRA PIT
- STORMWATER GRATING
- SEWER MAN HOLE
- STORMWATER MANHOLE
- LIGHT POLE
- SAPN CONNECTION
- BOLLARD
- SIGN
- STORMWATER CONNECTION
- FOOTPATH
- SIDE ENTRY PIT
- COMMON SERVICE TRENCH
- DOMESTIC OUTLET (STORMWATER)
- SEWER IO
- POTABLE WATER CONNECTION
- DW** DRIVEWAY

YAMUNA AVENUE



ALEXANDER SYMONDS
 PH 8130 1666

1:200

DISCLAIMER: DATA SHOWN HEREON IS DESIGN INFORMATION AND SHOULD BE CONFIRMED ORIGINAL SHEET SIZE A4

IMPORTANT
 SERVICE AND DRIVEWAY LOCATIONS
 ARE APPROXIMATE. ANY CHANGES WILL
 BE AT THE PURCHASERS EXPENSE.
 PURCHASER: _____
 PURCHASER: _____
 DATE: _____

ALLOTMENT 561 in DEV. NO. 292/D066/12/013

**in the area named
 MUNNO PARA WEST**

CT ---/----

PRELIMINARY

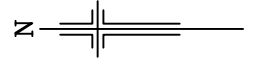

DISCLAIMER:

Please note that this site plan is intended for visual purposes only, additional survey work will be required prior to commencing any design or construction on the site.

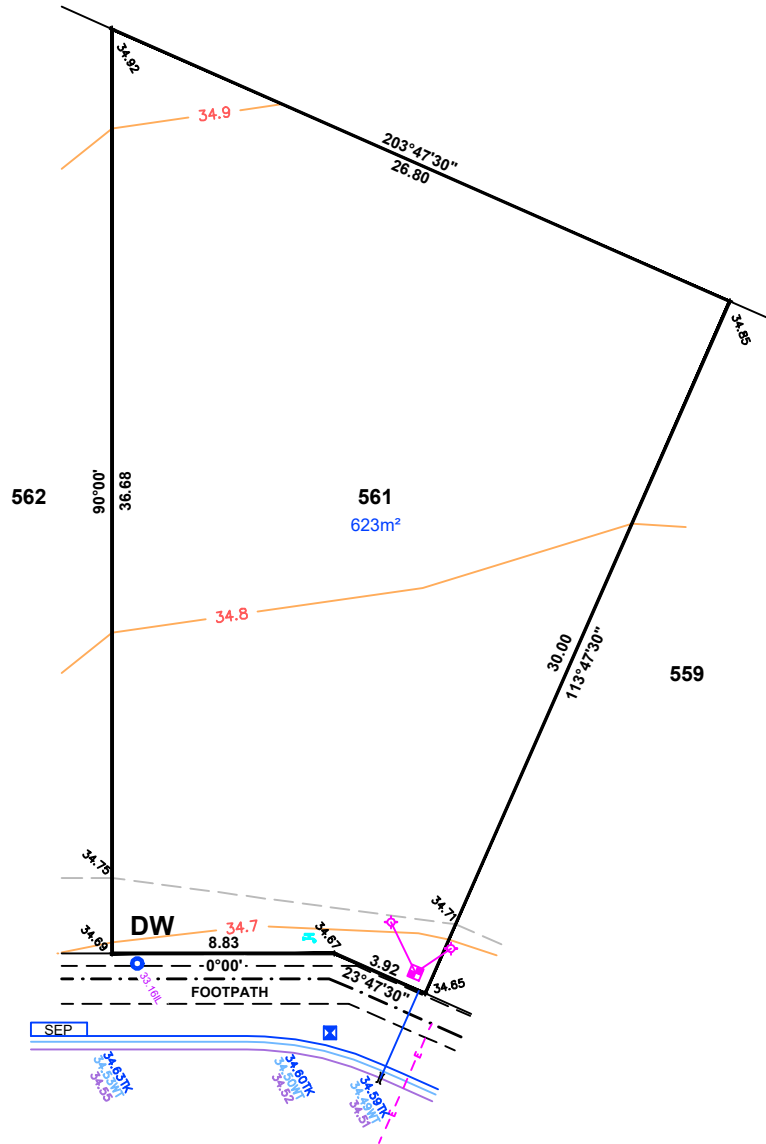

YAMUNA AVENUE

LEGEND

- ELECTRICAL LEAD IN
- SEWER IP
- STOBIE POLE
- TELSTRA PIT
- STORMWATER GRATING
- SEWER MAN HOLE
- STORMWATER MANHOLE
- LIGHT POLE
- SAPN CONNECTION
- BOLLARD
- SIGN
- STORMWATER CONNECTION
- FOOTPATH
- SIDE ENTRY PIT
- COMMON SERVICE TRENCH
- DOMESTIC OUTLET (STORMWATER)
- SEWER IO
- POTABLE WATER CONNECTION
- DW DRIVEWAY



ALEXANDER SYMONDS 1:200
 PH 8130 1666

DISCLAIMER: DATA SHOWN HEREON IS DESIGN INFORMATION AND SHOULD BE CONFIRMED ORIGINAL SHEET SIZE A3

IMPORTANT
 SERVICE AND DRIVEWAY LOCATIONS
 ARE APPROXIMATE. ANY CHANGES WILL
 BE AT THE PURCHASERS EXPENSE.
 PURCHASER: _____
 PURCHASER: _____
 DATE: _____

ALLOTMENT 562 in DEV. NO. 292/D066/12/013

**in the area named
 MUNNO PARA WEST**

CT ---/----

PRELIMINARY

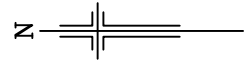

DISCLAIMER:

Please note that this site plan is intended for visual purposes only, additional survey work will be required prior to commencing any design or construction on the site.

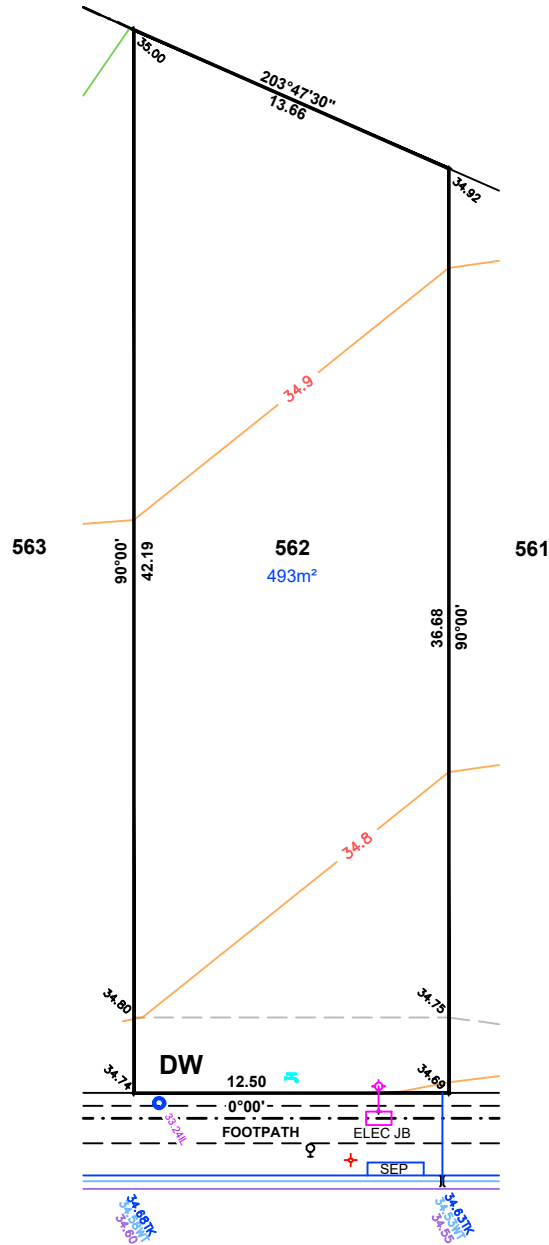

YAMUNA AVENUE

LEGEND

- ELECTRICAL LEAD IN
- SEWER IP
- STOBIE POLE
- TELSTRA PIT
- STORMWATER GRATING
- SEWER MAN HOLE
- STORMWATER MANHOLE
- LIGHT POLE
- SAPN CONNECTION
- BOLLARD
- SIGN
- STORMWATER CONNECTION
- FOOTPATH
- SIDE ENTRY PIT
- COMMON SERVICE TRENCH
- DOMESTIC OUTLET (STORMWATER)
- SEWER IO
- POTABLE WATER CONNECTION
- DW DRIVEWAY



ALEXANDER SYMONDS 1:200
 PH 8130 1666

DISCLAIMER: DATA SHOWN HEREON IS DESIGN INFORMATION AND SHOULD BE CONFIRMED ORIGINAL SHEET SIZE A3

IMPORTANT
 SERVICE AND DRIVEWAY LOCATIONS
 ARE APPROXIMATE. ANY CHANGES WILL
 BE AT THE PURCHASERS EXPENSE.
 PURCHASER: _____
 PURCHASER: _____
 DATE: _____

ALLOTMENT 563 in DEV. NO. 292/D066/12/013

**in the area named
 MUNNO PARA WEST**

CT ---/----

PRELIMINARY

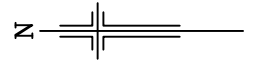

DISCLAIMER:

Please note that this site plan is intended for visual purposes only, additional survey work will be required prior to commencing any design or construction on the site.

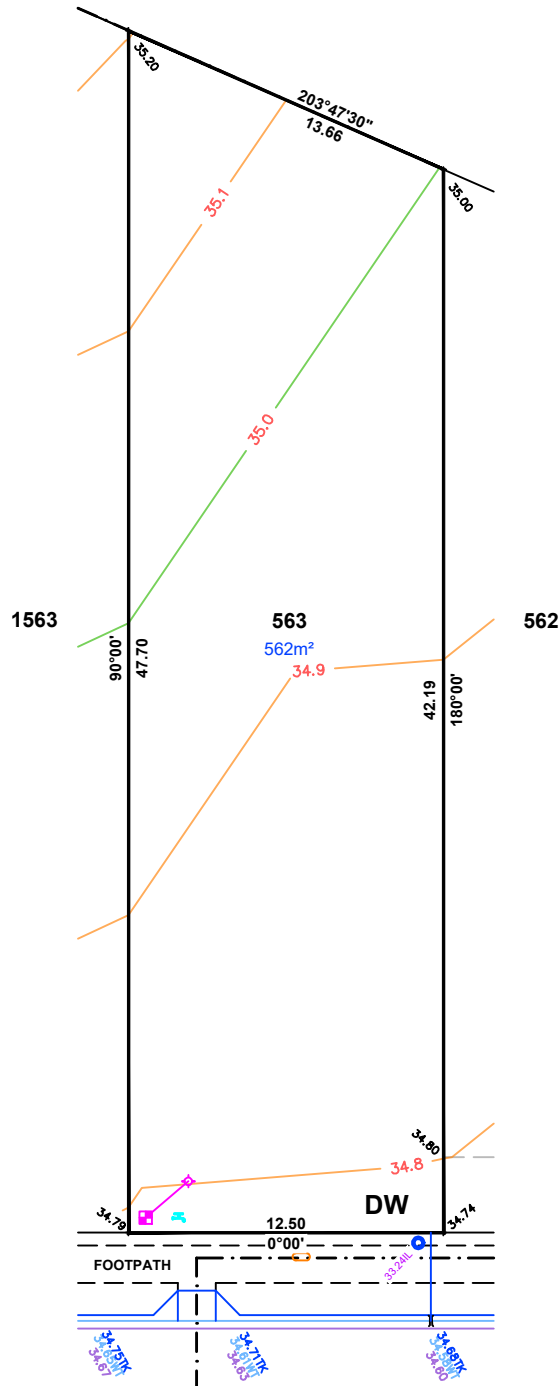

YAMUNA AVENUE

LEGEND

- ELECTRICAL LEAD IN
- SEWER IP
- STOBIE POLE
- TELSTRA PIT
- STORMWATER GRATING
- SEWER MAN HOLE
- STORMWATER MANHOLE
- LIGHT POLE
- SAPN CONNECTION
- BOLLARD
- SIGN
- STORMWATER CONNECTION
- FOOTPATH
- SIDE ENTRY PIT
- COMMON SERVICE TRENCH
- DOMESTIC OUTLET (STORMWATER)
- SEWER IO
- POTABLE WATER CONNECTION
- DW DRIVEWAY

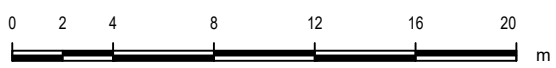

ALEXANDER SYMONDS 1:200
 PH 8130 1666

DISCLAIMER: DATA SHOWN HEREON IS DESIGN INFORMATION AND SHOULD BE CONFIRMED ORIGINAL SHEET SIZE A3

IMPORTANT
 SERVICE AND DRIVEWAY LOCATIONS
 ARE APPROXIMATE. ANY CHANGES WILL
 BE AT THE PURCHASERS EXPENSE.
 PURCHASER: _____
 PURCHASER: _____
 DATE: _____

ALLOTMENT 1563 in DEV. NO. 292/D066/12/013

**in the area named
 MUNNO PARA WEST**

CT ---/----

PRELIMINARY

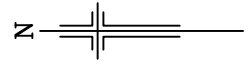

DISCLAIMER:

Please note that this site plan is intended for visual purposes only, additional survey work will be required prior to commencing any design or construction on the site.

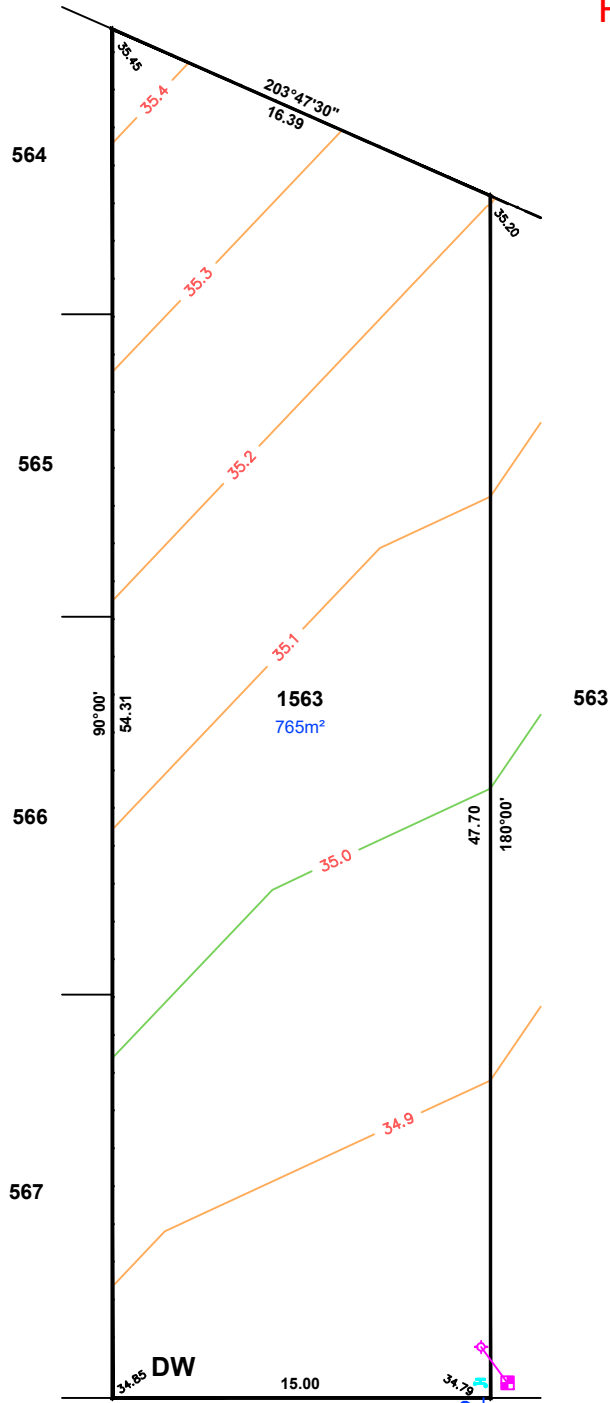

YAMUNA AVENUE

LEGEND

- ELECTRICAL LEAD IN
- SEWER IP
- STOBIE POLE
- TELSTRA PIT
- STORMWATER GRATING
- SEWER MAN HOLE
- STORMWATER MANHOLE
- LIGHT POLE
- SAPN CONNECTION
- BOLLARD
- SIGN
- STORMWATER CONNECTION
- FOOTPATH
- SIDE ENTRY PIT
- COMMON SERVICE TRENCH
- DOMESTIC OUTLET (STORMWATER)
- SEWER IO
- POTABLE WATER CONNECTION
- DW DRIVEWAY



ALEXANDER SYMONDS 1:200
 PH 8130 1666

DISCLAIMER: DATA SHOWN HEREON IS DESIGN INFORMATION AND SHOULD BE CONFIRMED ORIGINAL SHEET SIZE A3